



Small sail accessories



Masthead plate

Made of **stainless steel**; fitted with two shrouds fittings, one forestay and one jib halyard with pulley.

Code	Suitable for boat size
58.234.10	from m 3,5 to m 4,5



U-bolts/Clamps/Chain plate

Code	Description
58.331.00	4-hole stainless steel U bolt; suitable for boom size 40/50 mm, width mm 80
58.330.00	"V" plate made of stainless steel for boom, with four holes. Designed to mount the boom's blocks
58.531.50	"V" plate made of stainless steel for mast 50/60 mm
58.528.00	chain plate fors.s. shroud fitting size mm 15x1,5 with pin Ø mm 6
58.329.00	stainless steel hook for sheets and other uses



Stay adjuster

Code	Length mm	hole Ø mm	Plug mm	Material
58.529.00	120	6	6x10	stainless steel



Stay adjuster - dual hole intervals

Code	mm	Ø pins mm	Adjustment mm	Stroke mm	Material
58.370.80	108x23	5	3 in 3	68	stainless steel
58.370.81	115x30	6	3 in 3	68	stainless steel



Double chain plate

made of **stainless steel**, fitted with adjusting holes.

Code	mm	Pin Ø mm
58.506.30	120	6

Forestay plate made of stainless steel



Code	Ø hole mm	Base mm	Height mm
58.604.00	5	60x34	38

Stainless steel forestay adjuster plate



Code	various holes size mm	Base mm	Height mm
58.530.40	5	49x16	37

Traditional hollow chain plate

Made of **stainless steel**, to be used in place of rigging screws.

Code	tape size mm	hole Ø mm	←→ mm
58.506.10	14x2	6	80
58.506.11	14x2	6	100
58.506.12	14x2	6	125
58.506.15	14x2	6	1000

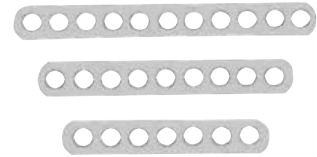
**Hollow chain plate, heavy**

Made of **heavy stainless steel**

Code	Length mm	Width mm	Thickness mm	hole Ø mm
58.507.10	145	19	2.5	8
58.507.11	205	19	2.5	8

**"U" plate suitable for the mast foot**

Made of **stainless steel**, "U" shape; fitted with adjusting holes.

Code	←→ mm	For boats
58.511.80	150	3 to 5 m

**Hook for spi sheet retention**

58.248.00 "Jack Holt" black nylon for spi sheet retention

**Hook "Jack Holt" for spi retention and various uses**

58.061.00 Balck nylon hook "Jack Holt" for spi retention and various uses

"Heavy duty" rudder retaining clip

58.021.01 Heavy duty rudder retaining clip made of stainless steel, thickness 1,6 mm with oval holes used for adjustment

Mainsail slide

Code	A mm	B mm	C mm	D mm	Max pull load kg	Material
58.357.00	23	9	13.5	28.5	-	nylon
58.358.00	22	12	13.5	30	-	nylon
58.047.50	30	28	14	4.5	-	nylon
58.047.70	25	25	10	3	-	nylon
58.089.00	-	16	-	-	400	nylon
58.090.00	-	18	-	-	420	nylon
58.091.00	-	22	-	-	530	nylon
58.092.00	-	24	-	-	530	nylon

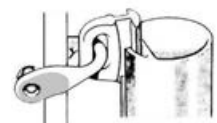
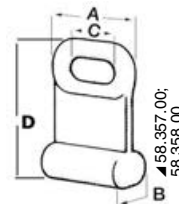

▲ 58.047.50; 58.045.90

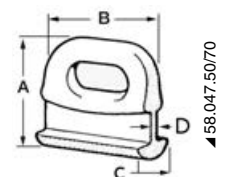

▲ 58.089.00;
58.090.00; 58.091.00;
58.092.00

▲ 58.047.50/70

Mainsail slide shackle

Code	Plug (pin) Ømm	Suitable for slider model	Material	Version
58.045.91	6	58.357.00	Nylon	With screw
58.045.90	8	58.358.00	Nylon	With screw
58.045.80*	8	58.357.00; 58.358.00	Nylon	Snap version
58.045.20	8	-	Nylon	Snap version

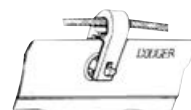

▲ 58.045.20



▲ 58.045.90/91



▲ 58.045.80

* Long type, plug Ø (Pin) 8 mm, light 42 mm, specially suited for fence nylon mainsails

Sheet fairleads



Code	Description
58.101.90	black nylon sheet fairlead

Sheet fairlead with stainless steel liner



Made of stainless steel

Code	For rope size mm
58.101.82	4/6
58.101.83	6/8
58.101.84	8/10



▲ 58.241.91/92



▲ 58.141.91/92/93

Sheet fairleads

Code	Hole mm
58.141.91	9
58.141.92	13
58.141.93	17
58.241.91*	6
58.241.92*	13

* Passing reinforcement made of stainless steel

Sail battens

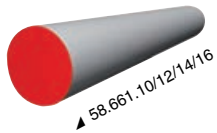

▲ 58.661.10/12/14/16



▲ 58.660.46/49/52

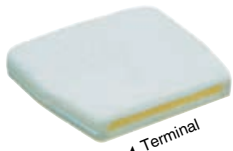

▲ Terminal



▲ 58.660.45/47/50/51

Battens for sails and boat awnings

Suited for **satin fibreglass** sails; high resistant and remarkable flexibility; designed according to the latest technologies and based on regatta demands

←→ mm	Round Ø mm	Bar length				Horizontal bending load g	Terminals
		2 m	4 m	3 m	6 m		
18x2	-	58.660.49	-	-	-	320	58.660.57
24x2.5	-	58.660.46	-	-	-	600	58.660.58*
50x4	-	58.660.45	58.660.65	-	-	2655	-
15x3	-	58.660.50	-	-	-	420	58.660.53
24x4	-	58.660.47	58.660.67	-	-	1185	58.660.59*
30x3	-	58.660.51	58.660.71	-	-	1155	58.660.54
40x4	-	58.660.52	58.660.72	-	-	2080	58.660.55
-	10	-	-	58.661.10	-	9150	-
-	12	-	-	58.661.12	-	21025	-
-	14	-	-	-	58.661.14	38800	-
-	16	-	-	-	58.661.16	60780	-



* Sold in pairs

Rudder fittings - Pintles and Gudgeons

Made of stainless steel and aluminium.



Code	For wheel thickness mm	Bracket mm		Suitable for boats m
		Short	Long	
59.127.50	12	75	108	3/4
59.127.51	35	132	179	5/6