

**!** NOTICE: electronics is constantly developing so please verify the updated price and possible changes before ordering.

## FM radio/Bluetooth/USB/MP3

### Bluetooth dashboard amplifier

**BLUETOOTH**

**WATERPROOF**

**IP66**

Amplifier with controls on the dashboard. It receives the music signal from any Bluetooth device (Smartphone, Tablet, etc.).

Input: Bluetooth, AUX and USB (AUX and USB at the rear of the amplifier).

Water-resistant and ideal for installation on the dashboard.

Separate output and controls for subwoofer.

Power: 4x45W.

Voltage: 12V.

Central knob for easy volume setting.

Code	Description	V
29.531.00	Bluetooth dashboard amplifier	12



**OSCULATI**

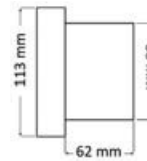

### Radio for instrument panel with remote control and DAB antenna

**DAB VERSION**

**SPLASHPROOF**

- Compatible devices: Bluetooth/USB/MP3/FM/DAB.

- Display: 3" colour screen, in/out video line.

- Also for external installation

- Input: Bluetooth, USB, 1 x RCA stereo pair.

- Power: 4x40 W.

- Backup memory.

- 12V voltage.

- Accessories: DAB antenna, remote control.

- Cable total length: 2 m.

Code	Description
29.530.02	Dashboard radio with accessories
29.530.08	Additional USB-AUX cord with watertight front panel. To be used for listening to music on external USB memories.



**OSCULATI**

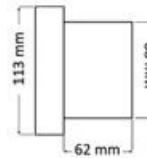

### BOSS FM/AM/Bluetooth/USB/MP3 radio for dashboard

AM/FM radio with RDS system. 3.5-mm USB and AUX inlets on the rear (that can be mounted on the dashboard by means of accessory 29.530.08).

Bluetooth connection for audio streaming, active matrix TFT display, IPX6 degree protection, 150W RMS power, 63W peak per channel.

12V power, 15A absorption, 76-mm Ø bore, 111-mm recess.

Code	Description
29.530.05	MGR350B radio for dashboard



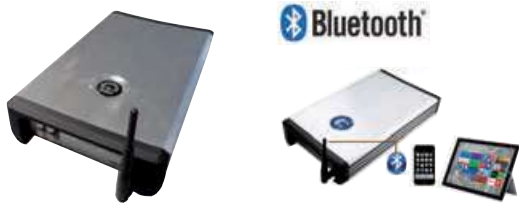

**RIVIERA R904 Bluetooth stereo amplifier**

High power amplifier independent from the bridge stereo. It receives the signal from any Bluetooth device (tablet, smartphone, etc.) and connects to no matter what stereo loudspeaker. Designed and made to resist extreme weather conditions, it delivers top-quality sound.

Code	V	No. of channels	W RMS		↔  mm
			4 ohm	2 ohm	
29.750.00	12	4	80x4	120x4	190x55x190



**Bluetooth stereo/amplifiers**

Ideal for small/medium vessels, the stereo doesn't need to be mounted on the dashboard. The amplifier receives the music signal from any Bluetooth device (tablet, smartphone, etc.) and connects to no matter what loudspeaker. Available in the 2-, 4- or 4+2-channel version. It works with any loudspeaker (max 8") on our catalogue.

Code	V	No. of channels	W RMS	↔  mm AxBxC
29.749.02	12	2	2x30	122x42x28
29.749.04	12	4	4x30	122x42x28
29.749.06	12	4+2 subwoofers	4x30 + 2x60 (subwoofers)	206x48x148

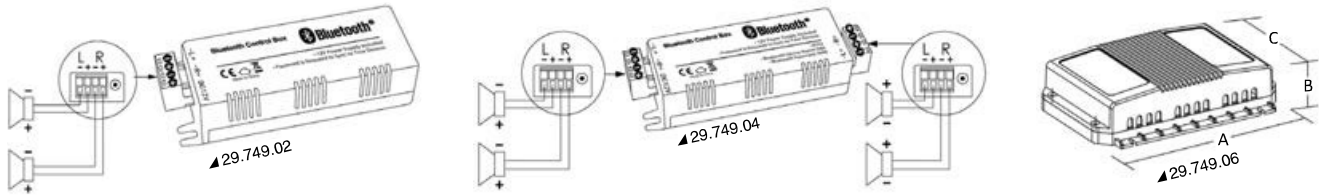

**AQUATIC AV marine stereos**



**AQUATIC AV Bluecube Media Player**

The BlueCube is a high quality, robust and durable waterproof marine grade stereo designed to be installed hidden away out-of-sight. It plays music wirelessly via a Bluetooth enabled smartphone or MP3 device (wired connection can also be made with stereo RCA inputs). It features an onboard 288W amplifier capable of powering up to 8 x 4 ohm speakers. It controls music directly from the Bluetooth enabled device or with the radio remote control 29.548.77.

**BLUECUBE technical specification:**

- Device Control: smartphone, MP3, Bluetooth device or radio remote control 29.548.77.
- Inputs: Bluetooth, RCA stereo (1x3,5 W auxiliary jack).
- Outputs: 2 x RCA (4V).
- Power (max): 4 x 72 W (2 and 4 ohm stable)
- Amplifier type: Class A/B.
- Power Supply: 12V.
- Current Draw: 7A max (0.006A in Standby mode).
- Waterproof: IP65. - Certifications: CE, RoHS, WEE, FCC.

Code	Description
29.548.75	Media Player Bluecube
29.548.77	Portable floating remote control with IP66 watertight USB cable, 12-m range, RF screen
29.548.82	Wired remote control, WR6 IP65 watertight cable



**MP6 watertight tuner AQUATIC AV**

- Supported Media: Bluetooth/USB/MP3/AM/FM/DAB (with adapter 29.548.83)/AUX (with rear USB connector).
- Display: TFT screen.
- Inputs: Bluetooth, 1xUSB, 1 pair of RCA.
- Outputs: 1 pair of 2V RCA pre-out.
- AM/FM Tuner: 18x FM and 12x AM pre-set memories, US/Euro frequencies.
- Power (max): 4x45W (4 ohms), 4x72W (2 ohms).
- Output voltage: 10.5 V – 14.4 VDC.
- IP65 waterproof. - Accessories: clock (included).
- Additional features: stainless light alloy, silicone dashboard cover, 2 x external triggers (12V, 3A) for connection to amplifiers.

Code	Description	
29.548.81	MP6 watertight tuner	
29.548.82	IP65 watertight WR6 second station	
29.548.94	3,6-m connection cable for	29.548.82
29.548.95	7,2-m connection cable for	29.548.82
29.548.77	Portable floating remote control with IP66 watertight USB cable, 12-m range, RF screen	
29.548.83	Adapter for DAB reception	



▲ 29.548.81



▲ 29.548.82

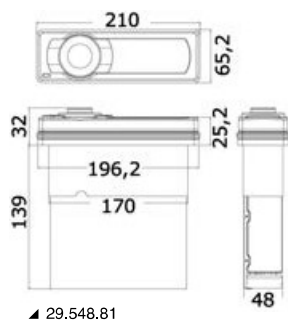

▲ 29.548.81



▲ 29.548.77



▲ 29.548.83

▲ 29.548.82

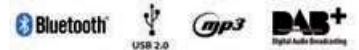

**AQUATIC AV MP6 compact watertight tuner**

**IP65**

- Supported Media: Bluetooth, USB, MP3, AM, FM, DAB (with adapter 29,548,83), AUX (with rear USB connector).
- Display: TFT screen.
- Inputs: Bluetooth, 1xUSB, 1 pair of RCA.
- Outputs: 1 pair of 2V RCA pre-out.
- AM/FM Tuner.
- Power (max): 4x45W (4 ohms), 4x72W (2 ohms).
- Output voltage: 10,5 V – 14,4 VDC.
- IP65 protection degree.
- Accessories: clock (included).
- Additional features: stainless aluminium, silicone dashboard cover, 2 x external triggers (12V, 3A) for connection to amplifiers.

Code	Description
29.548.79	Compact CP6 watertight tuner
29.548.82	IP65 watertight WR6 second station
29.548.77	Portable remote control with IP66 watertight USB recharge cable, 12-m range, RF screen
29.548.83	Adapter for DAB reception

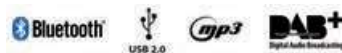

**AQ-MP-5UBT-S watertight tuner AQUATIC AV**

**P65**

- Supported Media: IAP Bluetooth/iPod/iPhone/MP3/AM/FM/AUX/SIRIUS XM. It fits devices up to the size of Samsung Galaxy Note and iPhone 6 Plus
- iPod/iPhone navigation: playlist, album, song, genre, composer, audiobook
- Device charging: via USB
- Display: 3" colour screen with album artwork display
- Removable faceplate + watertight USB port
- Dual Zone Dual Source: Yes
- Inputs: 1xUSB front/inside, 1x3,5 mm jack, 1 pair of RCA Aux, Bluetooth
- Outputs: 1xRCA Sub-out, 2 pairs of 4V RCA pre-out
- AM/FM Tuner: 18x FM, 12x AM Pre-set memories, US/Euro frequencies
- Power (max): 4x45W (4 ohms), 4x72W (2 ohms)
- Output voltage: 9,6 V – 14,4 VDC
- IP55 waterproof
- Chassis material: stainless steel
- Accessories: AQ-WR-5F remote control (sold separately), clock (included)
- Additional Features: internal dock lighting, 2x external triggers (12V DC, 350mA), DSP EQ, bass/treble, balance/fader, volume, stainless steel mounting hardware.

Code	Description	
29.548.90	watertight tuner	
29.548.91	second station (AQ-WR-5F)	
29.548.94	3,6-m connection cable for	29.548.90; 29.548.91
29.548.95	7,2-m connection cable for	29.548.90; 29.548.91



**AQUATIC AV combined stereo, subwoofer and amplifier**

**Built-in 288W amplifier** with electronic crossover powers both the **internal subwoofer** and up to four full-range speakers providing outstanding subwoofer performance. It receives a stronger Bluetooth signal from smartphones and MP3 readers with Halo Aerial Technology. It can also be controlled via radio remote control 29,548.77.

Built-in amplifier technical specification:

- Device control: via Bluetooth, smartphone, MP3;
- Outputs: 2 x RCA (400 mV, 2/4 V);
- Power (max): 288 W (144 W + 144 W subwoofer);
- 125-20,000 Hz.

Subwoofer technical specification:

- 8" cone;
- Tuned subwoofer port;
- Power (max): 144 W;
- 26-125 Hz.

Code	Description
29.548.60	Stereo + subwoofer + amplifier
29.548.77	Floating portable remote control including IP66 watertight 12-m USB cable, Rf screen



## FUSION audio devices



### FUSION stereo system

With wireless bluetooth technology and DAB antenna. Anti-glare colour screen and IPx6/IPx7 protection degree.

Code	FUSION® code	Model	V	Power W		Display	Australian socket	USB source	IP degree	←→  mm
				RMS	Max					
29.850.01	010-02405-00	MS-RA60	12	4x22	4x45	LCD 2,3"	1 RCA OUT with amplifier	No	IPX6 / IPX7	157 x 68 x 81,2
29.850.02	010-01516-11	MS-RA70N	12	4x26	4x50	LCD 2,6"	2 RCA OUT with amplifier	Yes	IPX7	60 x 188 x 123,5
29.850.07	010-02250-00	MS-RA210	12	4x26	4x50	LCD 2,7"	2 RCA OUT with amplifier	Yes	IPX6 / IPX7	156 x 68 x 126,6

### FUSION Apollo series stereo system

Modern design and marine technology combine to offer comfortable entertainment both at home and on board. User-friendly browsing of your playlists to enjoy high-quality music.



Code	FUSION® code	Model	V	Power W		Display	Australian socket	USB source	IP degree	←→  mm
				RMS	Max					
29.850.03	010-01983-00	SRX400	12	2x43	2x70	Colour LCD 2,7"	No	No	IPX6 / IPX7	70 x 110 x 122
29.850.14	<b>New</b> 010-02346-50	MS-WB675	12	4x43	4x70	No	2 RCA	Yes	IPX2	130 x 130 x 56
29.850.05	010-02138-00	MS-RA670	12	4x43	4x70	Colour LCD 2,7"	1 RCA	Yes	IPX6 / IPX7	68 x 157 x 123
29.850.06	010-01905-00	MS-RA770	12	4x43	4x70	Touchscreen colour LCD 4,3"	2 RCA	Yes	IPX6 / IPX7	82 x 192 x 119,4



## FUSION amplifiers



### FUSION amplifiers

Made to last in the demanding marine environment. Excellent performance and unmatched resistance against humidity. Class D amplifiers for higher consumption efficiency with respect to optimum power.

Code	FUSION code	Model	V	No of channels	Max power W	A	←→  mm
29.842.02	010-01500-00	MS-AM504	12	4	500	50	366 x 299 x 53
29.842.03	010-01969-00	SG-DA41400	12	4	1400	80	300 x 210 x 50
29.842.04	010-01968-00	SG-DA51600	12	5	1600	80	300 x 210 x 50
29.842.05*	010-02284-65	MS-AP61800	12	6	1800	125	62 x 297 x 229,3

\* Only compatible with Apollo RA770, RA670, SRX400, WB670 stereos.

## FUSION loudspeakers



### FUSION EL speakers

These loudspeakers are designed to deliver high quality audio with a simple installation.

Code	FUSION code	Model	Grid colour	Dimensions	Power W		Frequency Hz-kHz	Efficiency dB
					RMS	Max		
29.844.01	010-02080-02	EL-F651W	White	6,5"	20	80	45-16	88
29.844.02	010-02080-11	EL-F651B	Black	6,5"	20	80	45-16	88



### FUSION Flush Mount speakers

These loudspeakers are designed to deliver quality audio with a minimal design and a flush installation to better fit boats featuring a modern line.

Code	FUSION code	Model	Grid colour	Dimensions	Power W		Frequency Hz-kHz	Efficiency dB
					RMS	Max		
29.845.01	010-02299-00	FM-F65RW	White	6,5"	30	120	100-18	87
29.845.11	010-02299-01	FM-F65RB	Black	6,5"	30	120	100-18	87
29.845.02	010-02300-00	FM-F77RW	White	7,7"	50	200	80-18	91
29.845.12	010-02300-01	FM-F77RB	Black	7,7"	50	200	80-18	91

**FUSION XS Classic speakers**

These speakers are designed for high-performance acoustics and enhanced protection from the environment.

Code	FUSION code	Model	Grid colour	Dimensions	Power W		Frequency Hz-kHz	Efficiency dB
					RMS	Max		
29.843.01	010-02199-00	XS-F40CWB	☐ + ● White + black	4"	30	120	100-18	87
29.843.02	010-02196-00	XS-F65CWB	☐ + ● White + black	6.5"	50	200	80-18	91
29.843.03	010-02197-00	XS-F77CWB	☐ + ● White + black	7.7"	60	240	70-18	92



**FUSION XS Sport speakers**

Optimum style and audio quality for a mid-range product. RGB lights create the desired atmosphere.

Code	FUSION code	Model	Grid colour	Dimensions	Power W		Frequency Hz-kHz	Efficiency dB	LED lighting
					RMS	Max			
29.843.04	010-02196-20	XS-FL65SPGW	☐ + ● White + grey	6.5"	50	200	80-18	91	RGB
29.843.05	010-02197-00	XS-FL77SPGW	☐ + ● White + grey	7.7"	60	240	70-18	92	RGB



**FUSION Signature Classic speakers**

Optimum style and audio quality combine in a top-tier product.

Code	FUSION code	Model	Grid colour	Dimensions	Power W		Frequency Hz-kHz	Efficiency dB
					RMS	Max		
29.846.01	010-02771-00	SG-F653W	☐ White	6.5"	75	230	70-22	90
29.846.02	010-02772-00	SG-F773W	☐ White	7.7"	75	230	60-22	91



**FUSION Signature Sport speakers**

These loudspeakers are designed and developed to produce greater sound definition at a higher volume in order to elevate your activity at maximum speed. CRGBW LED lights set the scene on your boat.

Code	FUSION code	Model	Grid colour	Dimensions	Power W		Frequency Hz-kHz	Efficiency dB	LED lighting
					RMS	Max			
29.846.03	010-02771-10	SG-FL653SPW	☐ White	6.5"	75	230	70-22	90	CRGBW
29.846.04	010-02771-11	SG-FL653SPG	● Grey	6.5"	75	230	70-22	90	CRGBW
29.846.05	010-02772-10	SG-FL773SPW	☐ White	7.7"	100	280	60-22	91	CRGBW
29.846.06	010-02772-11	SG-FL773SPG	● Grey	7.7"	100	280	60-22	91	CRGBW



▲ 29.846.03/05

▲ 29.846.04/06

**FUSION subwoofers**



**FUSION subwoofer**

Engaging design combines with a unique bass power.

Code	FUSION code	Model	Series	Grid colour	Dimensions	Power W		Frequency Hz-kHz	Efficiency dB	LED lighting
						RMS	Max			
29.849.01	010-02301-00	FM-S10RW	Flush Mount	☐ White	10"	120	400	30-2	86	No
29.849.02	010-02198-00	XS-S10CWB	XS	☐ + ● White and Black	10"	120	600	30-2	86	No
29.849.03	010-02198-20	XS-SL10SPGW	XS	☐ + ● White and Grey	10"	120	600	30-2	86	RGB
29.849.04	010-02774-00	SG-S103W	Signature	☐ White	10"	300	600	30-2	86	No
29.849.05	010-02774-10	SG-SL103SPW	Signature	☐ White	10"	300	600	30-2	86	CRGBW
29.849.06	010-02775-10	SG-SL123SPW	Signature	☐ White	12"	700	1400	20-2	86	CRGBW
29.849.07	010-02775-11	SG-SL123SPG	Signature	● Grey	12"	700	1400	20-2	86	CRGBW



▲ 29.849.02

▲ 29.849.01



▲ 29.849.04

▲ 29.849.03



▲ 29.849.07



▲ 29.849.05/06

## Radio panels

**OSCULATI**



### Radio/stereo watertight front panel

Universal for all radios, made in compliance with DIN (European) standards and SAE (US) standards.

Code	Overhang mm	mm
29.735.00	46	230x86

## Boating stereo speakers

**OSCULATI**



▲29.741.XX



▲29.741.01/03/05/07



▲29.741.02/04/06/08

### Dual cone loudspeakers

**WATERPROOF**

**UV RESISTANT**

ABS body and polypropylene cone.

Code	Colour	Type	Power W		Response frequency Hz	Sensitivity dB	Compass min. distance m	mm			
			Rms	Max				D	d	H	h
29.741.01	White	3"	20x2	40x2	100-20000	90	0.80	104	73	53.5	38.5
29.741.02	Black	3"	20x2	40x2	100-20000	90	0.80	104	73	53.5	38.5
29.741.03	White	4"	30x2	60x2	60-20000	90	0.80	129	94	70	53.5
29.741.04	Black	4"	30x2	60x2	60-20000	90	0.80	129	94	70	53.5
29.741.05	White	5.25"	40x2	80x2	50-20000	90	0.80	157	124	75	53.5
29.741.06	Black	5.25"	40x2	80x2	50-20000	90	0.80	157	124	75	53.5
29.741.07	White	6.5"	60x2	120x2	50-20000	91	1.40	180	150	82	61
29.741.08	Black	6.5"	60x2	120x2	50-20000	91	1.40	180	150	82	61



▲29.741.02/04/06/08



### Dual cone loudspeakers

**WATERPROOF**

**UV RESISTANT**

ABS case and polypropylene cone.



▲29.743.01/03/05



Code	Colour	Type	Power W		Response frequency Hz	Sensitivity dB	Compass min. distance m	mm			
			RMS	Max				D	d	H	h
29.743.01	White	5.25"	2x40	2x80	80-20000	90	1.00	166	121	83	57
29.743.02	Black	5.25"	2x40	2x80	80-20000	90	1.00	166	121	83	57
29.743.03	White	6.5"	2x60	2x120	60-20000	91	1.40	192	138	98	65
29.743.04	Black	6.5"	2x60	2x120	60-20000	91	1.40	192	138	98	65
29.743.05	White	8.0"	2x90	2x180	40-20000	91	1.40	232	184	124	89
29.743.06	Black	8.0"	2x90	2x180	40-20000	91	1.40	232	184	124	89



▲29.743.02/04/06



**Extra-flat dual cone loudspeakers**

**WATERPROOF UV RESISTANT**

ABS case, polypropylene cone. Ultra-flat version for **minimum recess**.

Code	Colour	Type	Power W		Response frequency Hz	Sensitivity dB	Compass min. distance m	mm			
			RMS	Max				D	d	H	h
29.742.01	White	4"	10x2	20x2	90-18000	90	0,80	133	95	38	23
29.742.02	Black	4"	10x2	20x2	90-18000	90	0,80	133	95	38	23
29.742.03	White	5.25"	20x2	40x2	80-18000	90	0,80	162,5	119	39,5	23
29.742.04	Black	5.25"	20x2	40x2	80-18000	90	0,80	162,5	119	39,5	23
29.742.05	White	6.5"	30x2	60x2	60-18000	91	1,00	186	135	40	23,5
29.742.06	Black	6.5"	30x2	60x2	60-18000	91	1,00	186	135	40	23,5

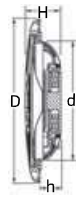

▲29.742.02/04/06



▲29.742.01/03/05

**2-way speakers**

**WATERPROOF** 2-way speakers (for an improved acoustic performance) with separate tweeter. Designed for indoor and outdoor use. Min. distance from the compass: 1.1 m.

Code	Color	Ø A mm	Ø B mm	D mm	Power W		Frequency HZ	Ohm	Magnetism
					RMS	Peak			
29.740.01	White	160	125	57	20+20	30+30	80-20000	4,0	y25
29.740.02	White	188	144	57	25+25	40+40	95-25000	4,0	y25

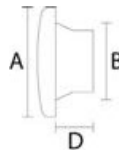

**OSCULATI**



**2-way loud speakers, Slim version, 23-mm depth**

**WATERPROOF** Two-way system (for better performance to lows and highs) with separate tweeter. For indoor and outdoor use. Min. distance from the compass: 1 m.

Code	Colour	Ø A mm	Ø B mm	C mm	Potenza W (pair)		Frequency Hz
					Rms	Max	
29.721.99	White	150	120	23 *	40	60	60 - 18000
29.721.98	Black	150	120	23 *	40	60	60 - 18000

\* Designed for installation with little recess depth

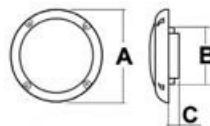

**OSCULATI**



▲29.721.98

▲29.721.99

**RIVIERA loud speakers**

**NON MAGNETIC / AMAGNETICHE WATERPROOF**

UV-resistant, with ferrite magnet.

Code	Color	Type	watt	Db	RsHz	Ohm
29.168.00	White	Double-cone	80	90	55-16000	4
29.168.20	White	Two-way	120	90	50-20000	4

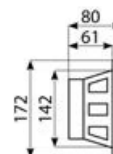

**SOUND MARINE™**



**Ultra Slim stereo speakers**

**IP65**

Low profile, **only 25mm deep**, watertight to **IP65**. Made with new CUTTING EDGE technology to significantly reduce the cone depth while offering excellent acoustic output.  
Min. distance from the compass: 1 m.

Code	Colour	Ø A mm	Ø B mm	C mm	Recess Ø mm	Power W (cp)		Response frequency Hz	Sensibility
						Rms	Max		
29.723.01	White	150	70	25	110	15	30	80 Hz - 15 KHz	86+- 2 dB
29.723.03	White	180	70	25	132	15	30	70 Hz - 15 KHz	89+- 2 dB

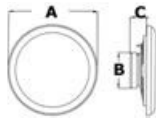

**OSCULATI**



**2-way non-magnetic speakers**

**AMAGNETICHE/NON-MAGNETIC**

**WATERPROOF**

Non-magnetic models (designed not to disturb instruments or compasses), two-way system (for better performance to highs and lows), fitted with separate tweeter. For indoor and outdoor uses.

Code	Colour	Ø A mm	Ø B mm	C mm	D mm	Power W (pair)		Frequency Hz	Ohm
						Rms	Max		
29.722.00	White	180	128	90	60	60	100	60 - 22000	4,0

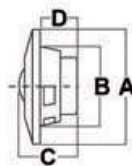

**OSCULATI**



▲ 29.747.02/04



▲ 29.747.02/04



**2-way loudspeakers with programmable multicolour LED lights**

**WATERPROOF**

**UV RESISTANT**

**LED RGB**

2-way loudspeakers with RGB multicolour LED lights programmable by means of the included radio remote control. 2-way loudspeakers offer better bass performance. ABS case and polypropylene diaphragm.

Code	Colour	Type	Power W		Response frequency Hz	Sensitivity dB	←→  mm			
			RMS	Max			D	d1	H	h
29.747.01	White	5,25"	30x2	80x2	80-20000	90	166	121	83	57
29.747.02	Black	5,25"	30x2	80x2	80-20000	90	166	121	83	57
29.747.03	White	6,5"	50x2	120x2	60-20000	91	192	138	98	65
29.747.04	Black	6,5"	50x2	120x2	60-20000	91	192	138	98	65



▲ 29.747.01/03

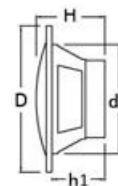



**Subwoofer**

**WATERPROOF UV RESISTANT**

With ABS casing and polypropylene cone.

Code	Colour	Type	Power W		Response frequency Hz	Sensitivity dB	Compass min distance m	mm			
			RMS	Max				D	d	H	h
29.744.01	White	8"	100	200	40 - 10000	90	1.40	254	187	122	90
29.744.02	Black	8"	100	200	40 - 10000	90	1.40	254	187	122	90
29.744.05	White	10"	250	500	30 - 10000	92	1.40	268	229	182	142

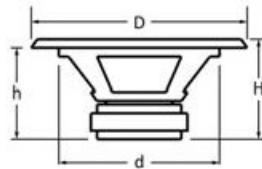

▲ 29.744.01/02



▲ 29.744.05

**Two-way loudspeakers for interiors**

Recessless adjustable bracket mounting.

Code	Colour	Type	Power W		Response frequency Hz	Sensitivity dB	mm AxBxC
			RMS	Max			
29.746.01	White	3"	40x2	80x2	100-20000	90	149x96x95
29.746.02	Black	3"	40x2	80x2	100-20000	90	149x96x95
29.746.03	White	4"	60x2	120x2	80-20000	90	206x140x120
29.746.04	Black	4"	60x2	120x2	80-20000	90	206x140x120

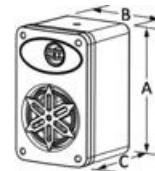

▲ 29.746.02/04



▲ 29.746.01/03

**CABINET Range - 2-Way Stereo Speaker for external/internal mounting**

**LOW MAGNETIC WATERPROOF IP65**

Low magnetic impedance (to prevent compass/instrument interference), 2-Way coaxial with high acoustic quality.

Supplied with stainless steel coated adjustable bracket

Code	Color	Power (cp)		Frequency Hz	Efficiency
		RMS	Peak		
29.730.01	White	30+30	60+60	75-20000	90 ± 2 dB 1watt/1m
29.730.11	Black	20+20	40+40	75-20000	90 ± 2 dB 1watt/1m

Bluetooth compatible (with amplifier 29.749.0x)

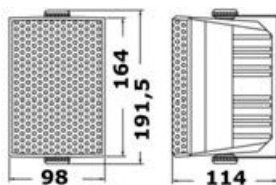

▲ 29.730.01



▲ 29.730.11



▲ 29.730.01

**Marine loudspeakers/amplifiers, for external use**

Water-proof, rust-proof, fitted with ABS body.

Code	Power	Ohm	Ø mm	Depth mm	Weight
29.003.00	10 Watt 110 dB	8	138	135	450
29.003.02	30 Watt 120 dB	8/16	200x120x235	-	1200



▲ 29.003.02



▲ 29.003.00

# GLOMEX digital terrestrial TV antennas (omnidirectional and directional)



White antenna	Black antenna	Model	Ø mm	Height mm	Base Ø mm	Weight g	Angle of reception	Impedance	DAB	Frequency range	Average gain	Current draw	Power supply	Gain adjustment	TV set max	Termination
29.926.20	29.926.21	Talitha V9125AGCU/DAB20	250	120	25	350	360°	75 Ω	Yes	87,5/774 MHz	23 dB	180mA	12-24 Vdc	automatic	2	25-mm female
29.925.20		Nashira V9112AGCU/DAB20	370	495	25	975	360°	75 Ω	Yes	87,5/774 MHz	24 dB	180mA	12-24 Vdc	automatic	2	25-mm female
29.924.01	29.924.02	Avior VT300	100	210	25	250	360°	75 Ω	No	40/890 MHz	21 dB	20 mA	12 Vdc	no	1	25-mm female
29.926.50		Altair V9126AGCU	250	300	25	430	360°	75 Ω	Yes	87,5/774 MHz	24 dB	180mA	12-24 Vdc	automatic	2	25-mm female



## DVB T2 FULL HD



### BALLADE Supergain digital TV antenna

DBVT/TNT/HDTV TV omnidirectional antenna.

- Technical data:
- \* 75 Ω impedance
  - \* 170/890 mHz frequency
  - \* 23,5 dB gain
  - \* 20 mA power consumption
  - \* Radome
  - \* Horizontal polarization.

Code	V	mm	Weight g
29.924.03	12	Ø 70 x 165 h	110

## DVB T2 FULL HD



### GLOMEX Talitha AGC/DAB/AM-FM TV antenna



Digital terrestrial TV antenna fitted with automatic gain control amplifier (AGC Automatic Gain Control), which amplifies the signal gain when necessary, and built-in LTE filter, Dual TV output, but if matched with an optional splitter, it connects an additional TV set on board or a TV set and an AM-FM radio receiver.

Code	Colour	Type	V	Ø mm	Height mm	Weight g	Coaxial cable included m
29.926.20	White	AGC DAB	12/24	250	426	405	20
29.926.21	Black	AGC DAB	12/24	250	426	405	20



## DVB T2 FULL HD



### GLOMEX Nashira AGC/DAB/AM-FM TV antenna



Digital terrestrial TV antenna fitted with automatic gain control amplifier (AGC Automatic Gain Control), which amplifies the signal gain when necessary, and built-in LTE filter. Dual TV output, but if matched with an optional splitter, it connects an additional TV set on board via ether or a TV set and an AM-FM radio receiver. The new DAB models stand out for their innovative automatic gain control amplifier and the 'shark fin' for receiving DAB frequencies (last generation Digital audio Broadcasting). 12/24 V power, 370-mm Ø, 185-mm height, 900-g weight. It includes a 20-m cable and a 1.5-m cable to connect the AGC amplifier to the TV set.

Code	Type	V	Ø mm	Height mm	Weight g	Coaxial cable included m
29.925.20	AGC DAB	12/24	370	495	975	20



**GLOMEX Avior TV/AM-FM antenna**

Code	Colour	Type	V	Ø mm	Height mm	Weight g	Coaxial cable included m
29.924.01	White	VT300	12	100	210	250	10
29.924.02	Black	VT300	12	100	210	250	10



DVB T2 FULL HD



**DVB-T2 Mizar AGC omnidirectional TV antenna**

Design similar to weBBoat Lite.

Technical data:

- 75 Ω impedance.
- 87.5/774 MHz frequency.
- 20 dB (automatic) gain.
- 60 mA power consumption.
- Max 2 pairing TVs.
- 360° reception angle.
- 1" x 14 base thread (any base plate on our catalogue will match).

Code	V	Ø mm	Height mm	Weight g
29.924.04	12/24	140	200	500



29.142.00 AGC - Automatic Gain Control

29.143.00 "Gold Platea" female connector (2 pcs)

▲ 29.142.00



DVB T2 FULL HD

DAB



**GLOMEX Altair AGC TV antenna**

This antenna supplies an excellent signal both in horizontal or vertical polarization thanks to the container antenna that allowed to mount the vertical element inside. Fitted with gain automatic adjustment amplifier and 12/24 V power unit. 20-meter coaxial cable. Input for 2 TVs, via ether, cable or video/recorder. Fixing base included.

Code	V	Ø mm	Height mm	Weight g	Coaxial cable included m
29.926.50	12/24	250	300	430	20



DVB T2 FULL HD

DAB



**Accessories for TV antennas**

Code	Description	Bore Ø mm	Height mm	For antennas	
				Glomex	Osculati
29.927.01	Stainless steel base for flat mounting	25	126	Nashira	29.925.20
29.927.00	Stainless steel base for flat mounting	25	150	Avior Nashira Talitha	29.924.01 29.925.20
29.917.30	Stainless steel masthead base	25	-	Nashira	29.925.20
29.912.30	Stainless steel masthead base	25	-	Talitha Avior	29.926.20 29.924.01
29.925.05	2-way splitter	-	-	Talitha Nashira	29.926.20 29.925.20
29.925.06	AM/FM radio cable (F male connector to Motorola socket)	-	3600	-	-



# GLOMEX satellite TV antennas



Code	Model	Antenna dish diameter	Radome dimensions	kg	Tracking rate	Average gain	Dish type	Frequency range	Current draw	Full elevation range	Type of stabilization	Min eirp	Control unit
29.923.42	Rhea NEO V8100N	470	500x560	8	50°/sec	35	prime focus + HPD	10.7 - 12.75 GHz LNB universal	12-24 Vdc (1.5 Ah)	0° - 90 °	gyro on 2 axes + 3rd axis	49 dBW	3 satellites + endless list
29.923.52	Saturn 4 NEO V9104N	470	500x560	13	50°/sec	35 dB	prime focus + HPD	10.7 - 12.75 GHz LNB universal	12-24 Vdc (2.5 Ah)	5° - 90 °	gyro on 2 axes + 3rd axis	49 dBW	3 satellites + endless list
29.923.62	Mars 4 Skew NEO V9804NSKEW	600	660x660	15.5	50°/sec	36.5 dB	prime focus + HPD	10.7 - 12.75 GHz LNB universal	12-24 Vdc (3 Ah)	5° - 90 °	gyro on 2 axes + 3rd axis	47 dBW	3 satellites + endless list



## GLOMEX Rhea NEO satellite TV antenna

**29.923.42** Rhea NEO is the new FULL-HD/4K wireless-operated satellite TV antenna with 47-cm dish diameter.

As all Glomex NEO antennas, Rhea features refurbished new-generation technology and mechanic elements for a very fast satellite reception even in heavy seas: more powerful processor, faster driver and sturdier frame. The new electronic parts have been designed to ensure very silent operation both during satellite search and tracking.

The new NEO satellite TV antennas have a standard GPS sensor and antenna for storage of previous navigation routes and high performance signal reception even at the borders of the coverage areas. Rhea NEO is operated by the free Glomex SAT TV App compatible with iOS and Android devices.

Download the App and connect via Bluetooth® to the NEO sat antenna and a single click will allow you to:

- Update the antenna satellite list.
- Select and switch satellites.
- Update the antenna software.
- Share your antenna operation parameters with the customer service in case of need.



## GLOMEX Saturn 4 NEO satellite TV antenna

**29.923.52** Saturn 4 NEO is the new FULL-HD/4K wireless-operated satellite TV antenna with a 47-cm diameter dish for max 16 TV outputs at a time.

As all Glomex NEO antennas, Saturn 4 features new-generation technology and refurbished mechanics for a very fast satellite reception even in heavy seas: more powerful processor, faster driver and sturdier frame. The new electronic parts have been designed to ensure very silent operation both during satellite search and tracking.

The new NEO satellite TV antennas have a standard GPS sensor and antenna for storage of previous navigation routes and high performance signal reception even at the borders of the coverage areas. Saturn 4 NEO is operated by the free Glomex SAT TV App compatible with iOS and Android devices.

Download the App and connect via Bluetooth® to the NEO sat antenna and a single click will allow you to:

- Update the antenna satellite list.
- Select and switch satellites.
- Update the antenna software.
- Share your antenna operation parameters with the customer service in case of need.



**GLOMEX Mars 4 Skew NEO satellite TV antenna**

**29.923.62** Mars 4 Skew NEO in the new FULL-HD/4K TV wireless-operated satellite antenna with automatic SKEW, 60-cm dish, for max 16 outputs at a time. As all Glomex NEO antennas, Mars 4 Skew features refurbished new-generation technology and mechanic elements for a very fast satellite reception even in heavy seas: more powerful processor, faster driver and sturdier frame. The new electronic parts have been designed to ensure very silent operation both during satellite search and tracking. The new NEO satellite TV antennas have a standard GPS sensor and antenna for storage of previous navigation routes and high performance signal reception even at the borders of the coverage areas.

Mars 4 Skew NEO is operated by the free Glomex SAT TV App compatible with iOS and Android devices. Download the App and connect via Bluetooth® to the NEO sat antenna and a single click will allow you to:

- Update the antenna software.
- Update the antenna satellite list.
- Select and switch satellites.
- Share your antenna operation parameters with the customer service in case of need.

**DVB-S2 FULL HD**



▲ Coverage areas



**GLOMEX spare radome**

To be combined with existing antennas for better design or as new cover.



Code	←→  mm	For antennas	
		Glomex	Osculati
29.923.90	500x560	Rhea	29.923.41
29.923.91	660x660	Mars	29.923.61
29.923.92	500x560	Saturn	29.923.51

**Tilting stainless steel support for GLOMEX TV antennas**

**29.923.95** Electro-polished stainless steel support for satellite and directional TV antennas. For perfectly vertical position of the antenna when the mounting surface isn't perfectly horizontal. 0 to 5° tilting ray. It comes with 2 rubber gaskets.



**Satellite coverage areas of each GLOMEX antenna**

The performance of satellite antennas depends on the weather conditions, on the navigation area and on the dimensions of the antenna itself (the size of the satellite dish shall be suitable to receive the signal in the areas chosen).

Code	Model
29.923.42	Rhea
29.923.52	Saturn
29.923.62	Mars

60 cm (24") DISH MARS

47 cm (18") DISH SATURN/RHEA

Satellite dish not available

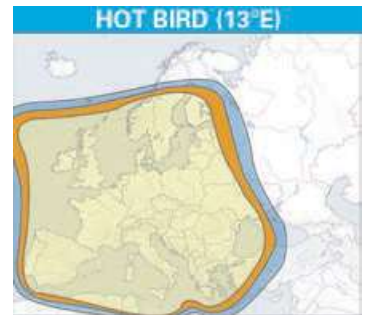
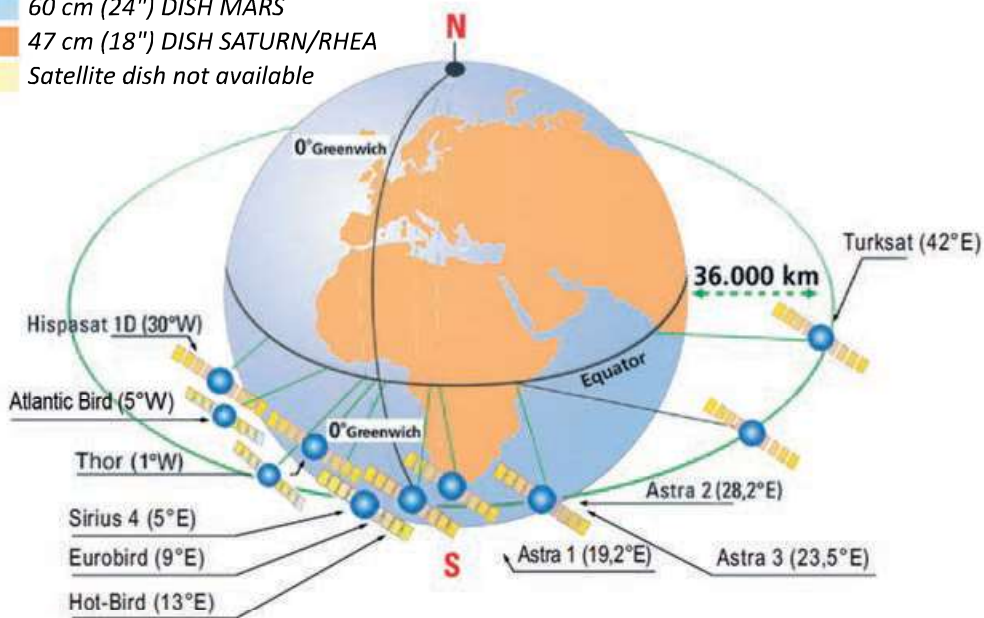

## AM/FM antennas

### Free cable FM/AM antenna



**29.128.15** L'MRANT10 dual-pole minimal antenna is enough to correctly receive the radio waves. 75-ohm impedance. 104-cm total length.

### Indoor FM/AM antenna



**29.128.16** 2,20-m cable, 76-110 MHz frequency. 75 Ω impedance.

### SCOUT AM/FM antenna, 90 cm



**29.719.00** 90-cm length. 88/108 MHz frequency. 75-ohm impedance. Equipped with 4-m cable.

### GLOMEX AM/FM compact antenna



**29.128.10** Impedance 93 Ω, extremely compact (length 30 cm) designed for standard hull antenna, made ready for radio systems, fitted with base and 3-meter cable, anti UV nylon, very low cost.

### GLOMEX AM/FM Antenna 240 cm



**29.128.80** Impedance 93 Ω, very high quality, length 240 cm, designed to be used with standard VHF antennas with standard size of 2.40 meters; uses all standard plastic bases, made of chromed brass stainless steel, fitted with thread size 1"x14 and 6 meter cable.

### Splitter RA201 radio - GLOMEX

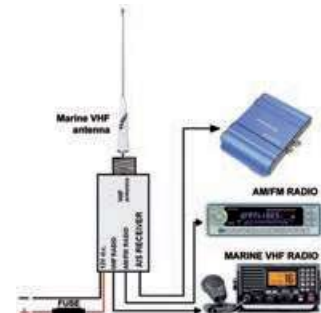

**29.448.00** It receives AM/FM broadcast (identifying floating signal) through the VHF antenna.

### GLOMEX AM/FM antenna, 150 cm



**29.128.06** 150-cm length. Fit with 6-m cable and MOTOROLA plug. 88/108-mHz frequency. Same look as VHF antenna 29.996.05 and CB 29.920.00.

### SCOUT AM/FM flexible antenna



Made of UV-resistant vinyl, it is very flexible and can be removed from its base. Watertight base. The antenna is supplied with 4-m cable + jack.

Code	Description	Length cm
29.128.11	AM-FM antenna	25

## VHF antennas and CB

### GLOMEX VHF RA121 antenna



**29.996.07** Low profile VHF antenna, same look as TV antenna 29.924.01. Equipped with 9-m cable RG58CU + connector PL259 + mounting base. 1dB gain, 50-watt max input power. Vertical polarization.

### GLOMEX VHF RA124 antenna



**29.996.08** VHF antenna similar to TV antenna 29.926.50. Fitted with RG58 9-m cable + PL259 connector + mounting base. 1-dB gain, 50W max input power. Vertical polarization.

### Wind vane indicator



**29.106.04** Made of **plastic**, fitted with bowline sectors, for fitting over antenna model 29.106.00

### GLOMEX mini antenna for VHF/AIS. 14-cm length RA 111



**29.106.30** 1-dB gain. Recommended for racing boats. It includes 18-m cable and bracket.

### GLOMEX RA106/109 SB KIT antenna for VHF



**29.106.00** Made of tapered **stainless steel**, length 90 cm, **universal** model for sail boats or motor boats; supplied with joint kit for standard joint bases, fitted with bracket for mast head mounting + watertight fairlead model 29.140.00 + connector protectors 29.138.00. Thanks to a special system the RG-58 cable does not need to be welded, but instead it is fitted quite easily; 3 db gain, weight 180 grams. **Supplied without cable.**

### VHF SCOUT KM-4 Windex ready 1.0 m antenna



**29.312.00** VHF antenna: length 1m, frequency 156-162 MHz, power 50W, gain 3dB. Fiberglass monopole, chromed brass tip designed to install Windex 15 (35,388,02 not included). It allows more room on the mast head because the VHF antenna and the Windex are installed on the same spot. It comes with a 3-mm thick stainless steel bracket and N-type female connector.

### GLOMEX RA 400 VHF antenna



Made of **fibreglass**, designed for VHF radio telephones, 1,5-m long, 3-db gain, 100W max. applicable power. **Supplied without base.**

Code	RG 58 4.5-m coaxial cable	Connector to be welded	Suitable for	Colour
<b>29.996.05</b>	INCLUDED	29.903.10	Motorboats	white
<b>29.996.06</b>	INCLUDED	29.903.10	Motorboats	black

### GLOMEX VHF antenna. treaded at the base RA 106



**29.106.20** Space-saving antenna solution in case of berthing or stowage of the vessel. 90-cm length, 3-db gain, nylon articulated base 29.135.00, 4,5-m cable, PL259 final connector, faillead 29.140.00, connector protector 29.138.00.

### GLOMEX - RA 1206 VHF antenna



**29.996.00** Made of **white fibreglass**, suitable for VHF radio-telephones, 2,40-m long, it comes with a 4,5-m RG-58 coaxial cable and chromed-brass connector. 6-dB gain. 100W maximum input power. Model designed for motor boats. **Chromed-brass** metal parts. **It is supplied without base.**



**GLOMEX Glomeasy Line super-compact VHF antenna**

Minimal and inconspicuous look.

White	Black	Length mm	dB	Max input power V
29.994.01	29.994.02	250	3	50

- 29.990.16 3-bore thread base plate
- 29.990.20 RA 352 connector to be screwed on cables 29.800.10/1/12/13/14 for plug connection to PL259 HVF Radio.
- 29.990.25 5/8"x24 connector to be screwed on antennas 29.990.01/02/03 for compatibility with standard 1" / 14 thread antenna base plates
- 29.800.10 RG8X 3-m cables
- 29.800.11 RG8X 6-m cables
- 29.800.12 RG8X 12-m cables
- 29.800.13 RG8X 18-m cables
- 29.800.14 RG8X 25-m cables
- 29.138.00 Watertight connector cover
- 29.140.00 Nylon deck fairlead



**New**

**SCOUT removable ultra-compact VHF antenna**

**FOAM INJECTED**

100% waterproof fiberglass VHF antenna. IP69 rating. It can be easily screwed off its support. UV-resistant coating and watertight internal gasket that prevents water ingress. It comes with its support and mounting kit.

Code	Length mm	kg	Max applicable power W	Gain dB	Coaxial cable m	Ø Base mm
29.993.01	220	0,11	50	1	5	55



**GLOMEX RA1225HP VHF Antenna**



29.995.60 2.40-mt long antenna for VHF. Made of white coated fiberglass, it includes an RG8X 6-mt cable and RA352 preassembled connector. 6-db gain, 100W max power. Stainless steel metal parts. Compatible with any Glomex base plate.

**GLOMEX fibreglass antenna for CB devices**



29.920.00 It includes 4,5-m coaxial of cable, 150-cm long. Standard threads fitting all bases from our catalogue.

**GLOMEX VHF RA104 antenna**



29.996.03 For small/medium boats, fitted with foldable stainless steel base. Made of double-layer glass fiber and 5 coats of polyurethane paint. 3dB gain, max 100 watt input power, 4,5 meters of coaxial RG58 cable, 100-cm length.

**New**

**GLOMEX VHF MAKO antenna**



Short-range, fin-shaped marine VHF antenna, featuring a low profile suitable for modern medium-sized motorboats and RIBs. The housing is made of polycarbonate/ASA to withstand the harsh marine environment for extended periods.

- For communications up to 12 nautical miles.
- Waterproof body with dual rubber seals integrated into the base.
- Compact dimensions: 140x70x61 mm (5.5x2.7x2.4").
- GLOMEX lifetime warranty.
- Includes 8m/26ft coaxial cable and connectors.

Code	Length mm	Colour
29.998.01	250	White
29.998.02	250	Black

**GLOMEX RA 1201 VHF antenna**



VHF antenna featuring an innovative design where the built-in bushing perfectly matches the boat look. Fitted with flag holder at the end. 2.4-m long, 6-db gain, 100W max. applicable power. Fitted with RG58 6-m cable. Recommended base 29.133.00.

Code	Colour
29.996.21	White

# SUPERGAIN antenna by Glomex



## SUPERGAIN VHF antenna by Glomex Target/Task

Technical data: 3 db gain.  
Max input power: 50 watt.

Code	Length mm	Base INCLUDED	Cable m	Colour	Suitable for
29.985.01	530	Articulated	6	Black	Motor boats
29.985.02	530	Bulkhead-mounted	8	Black	Motor boats and central control dinghies



## SUPERGAIN VHF antenna by Glomex Black Swan

Technical data: 3 db gain.  
Max input power: 50 watt.

Code	Length mm	Base INCLUDED	Cable m	Wind indicator	Colour
29.985.05	850	Right angle	20	Included	Black

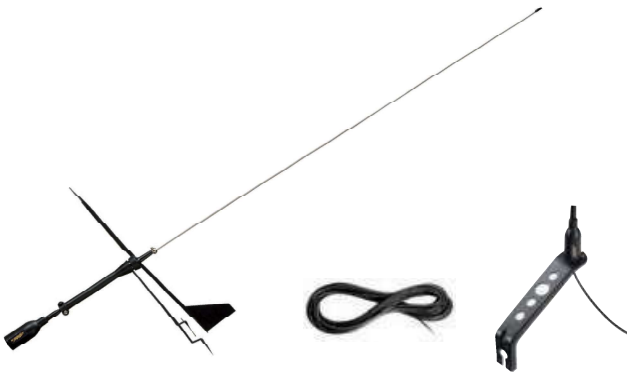

## SUPERGAIN VHF antenna by Glomex Elba

Technical data: 3 db gain.  
Max input power: 50 watt.

Code	Length mm	Base INCLUDED	Cable m	Colour	Suitable for
29.985.06	970	Bulkhead-mounted	20	Black	Sailing boats

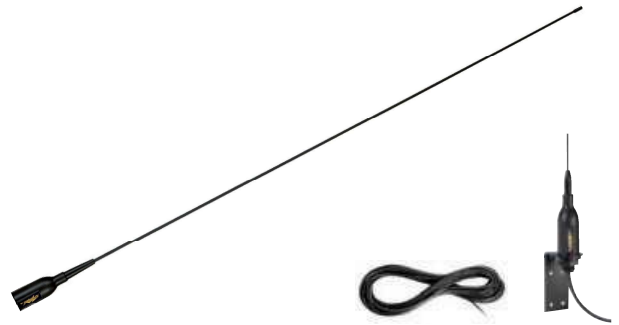

## SUPERGAIN VHF antenna by Glomex Capri

Technical data: 3 db gain.  
Input max power: 50 watt.

Code	Length mm	Base INCLUDED	Cable m	Colour	Suitable for
29.985.08	1400	Articulated	6	White	Motor boats and commercial vessels



## SUPERGAIN VHF antenna by Glomex Portofino

Technical data: 6 db gain.  
Input max power: 50 watt.

Code	Length mm	Base INCLUDED	Cable m	Colour	Suitable for
29.985.10	2300	Articulated	6	White	Motor boats and commercial vessels

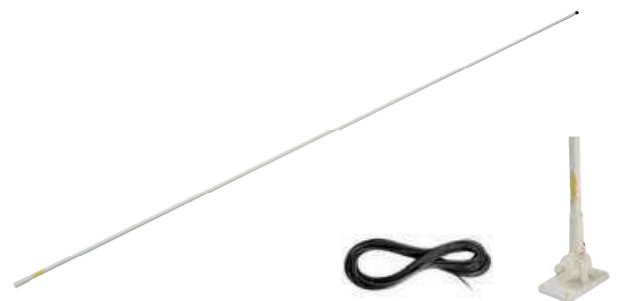

## Glomeasy Line antennas for fast installation



Fast installation system. All Glomeasy VHF/FM/AIS/DAB marina antennas are pre-terminated with a special FME connector for an extremely easy and fast installation. Glomeasy coaxial cables are offered in various lengths pre-terminated with a miniaturized FME connector for installation no matter where without the need to cut or weld the cables.

### GLOMEX Glomeasy Line VHF antenna

It can be mounted very easily by connecting the already plugged cables to the male connector. The Glomeasy system, featuring only 3 types of antenna and their accessories, meets all the needs of pleasure boaters and sailors.

Code	Colour	Model	Length m	db	Recommended for
29.990.01	White	stainless steel	0.90	3	sail
29.990.02	White	fiberglass	0.90	3	sail/motor
29.990.03	White	fiberglass	1.20	3	sail/motor
29.990.04	Black	fiberglass	1.20	3	sail/motor

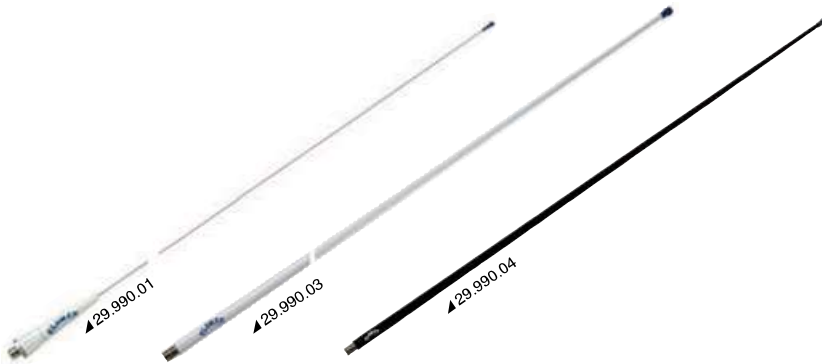

### GLOMEX Glomeasy Line AM/FM-DAB-AIS antenna

Very easy installation by means of the FME connector that matches the pre-assembled cables.

Code	Use	Model	Length m	DB	Impedance ohm	Recommended for
29.128.04	AM/FM	Fiberglass	1.2	-	93	Sailing/motor boats
29.128.03	DAB	Fiberglass	1.2	-	50	Sailing/motor boats
29.128.02	AIS	Fiberglass	1.2	6	50	Sailing/motor boats



### GLOMEX Glomeasy Line antenna accessories

Code	Description
29.990.10	1,2-m extension cable (RA 303) for 29,990,03, 29,128,04, 29,128,03 e 29,128,02
29.990.15	Stainless steel arm for mast head
29.990.16	Nylon white articulated base with built-in fairlead
29.990.18	Nylon black articulated base with built-in fairlead
29.990.17	AISI316 stainless steel articulated base with built-in fairlead
29.990.20	RA 352 connector to screw on cables 29,800,10/11/12/13/14 for snap connection to PL259 VHF Radio
29.990.21	FME/UHF RA 351 terminal to connect Glomeasy antennas
29.990.23	RA 357 double male fitting to connect 2xRG8X cables
29.990.25	5/8"x24 iting to plug to antennas 29,990,01/02/03 for compatibility with standard antenna base, 1"/14 thread
29.990.26	Male FME/male N Glomex RA354 adaptor
29.990.27	Male FME/male BNC Glomex RA355 adaptor
29.990.28	Male FME/male TNC Glomex RA356 adaptor



### RG8X cables for GLOMEX Glomeasy Line VHF antennas

RG8X low-attenuation cables terminated with female FME connectors for antennas 29.990.01/02/03 and terminal 29.990.20.

Code	Length m
29.800.10	3
29.800.11	6
29.800.12	12
29.800.13	18
29.800.14	24





**RG62 cable for Glomeasy Line AM/FM antennas**

Equipped with pre-fit FME connector on one side and Motorola plug on the other

Code	Length m
29.799.06	6
29.799.18	18
29.799.25	25

**Base plates and accessories for VHF antennas and radars**

**Double swivelling base for radio antennas**

AISI 316



29.899.00 Made of **stainless steel**; quick locking system, universal screw thread; base size 65x92mm, suitable for VHF/GPS antennas.

**Swivelling base**

AISI 316



Made of mirror polished **AISI 316 stainless steel**, designed for mounting on GPS and VHF pipes.

Code	For pipe size mm
29.930.20	22/25
29.930.21	28/38

**Swivelling base for VHF antenna and GPS**



29.897.99 Made of white nylon with blocking knob.

**GLOMEX base with built-in fairlead**



29.135.00



29.135.01

Made of reinforced nylon with articulated joint, suitable for VHF/GPS antennas.

Code	Color
29.135.00	<input type="checkbox"/> White
29.135.01 <b>New</b>	<input checked="" type="checkbox"/> Black

**GLOMEX base with built-in fairlead recommended for RA1201**



29.133.00 Made of UV-resistant reinforced nylon with articulated joint and lever lock for pulpit or deck. Hole for coaxial cable and GPS cord. It can also be used with self-bearing antennas not exceeding 2.70 metres in length. Standard 1"x14 thread.

**GLOMEX articulated base for pulpit**



29.134.00 Made of nylon, fitted with knob locking, designed for handrail pipe mounting Ø 22/25 mm; universal for VHF/GPS antennas.

**GLOMEX articulated and raised base for pulpit**



29.147.00 Made of nylon, fitted with knob locking, designed for handrail pipe mounting Ø 22/25 mm; universal for VHF/GPS antennas, 100 mm extension cord already mounted to raise the antenna.

**GLOMEX lever-operated articulated base**



29.898.01 Made of **nylon**, fitted with cam locking, designed for mounting on **handrail pipes, universal** for Loran, VHF and GPS, for pipes with Ø of 22/25 mm.

**GLOMEX fixed base**



29.175.00 1"x14 reinforced nylon fixed base for GPS antennas.

**GLOMEX fixed nylon base for pulpit**



29.145.00 Made of nylon, designed for mounting on pipe size 22/25 mm, for GPS antennas.

**Base**



29.146.00 Made of **reinforced nylon**, designed for VHF-GPS antennas. 1" thread.

**Knuckle base for VHD antenna: Loran and GPS**



29.898.00 Made of **white nylon**, fitted with eccentric ground rack locking system.

**GPS/UHF antenna base with lever for pulpit**



**29.540.41** Universal screw thread; made of white nylon, fits pipes with Ø size 25 mm.

**Support bases for GPS/VHF antennas**

**AISI 316**



**29.862.35** AISI 316 stainless steel casting, mirror polished finish, high quality. 102 mm high, 73-mm Ø base, standard thread.

**Support**

**AISI 316**



**29.862.34** Made of AISI 316 stainless steel, fitted with standard thread for GPS/VHF antennas. Fits pipes with Ø 25 mm, with the use of a tee (see models 41.115.25/41.112.25 or similar) and a stainless steel pipe size 25 mm, the antenna can be extended as required.

**GPS/VHF fixed antenna support for pulpit**

**AISI 316**



**29.862.33** Standard thread for application on pipe size 22/25 mm, made of stainless steel.

**Base**

**AISI 316**



▲ 29.917.40



▲ 29.917.41

Made of stainless steel, designed to raise GPS/VHF/TV/AM-FM antennas available in our catalogue. Standard 1"x14 thread.

Code	Height mm
29.917.40	98
29.917.41	106

**GLOMEX/SCOUT extension pole**



Code	Description
29.129.00	60-cm enameled version with nylon fittings to raise GPS antennas (GLOMEX)
29.996.01	1.53-m version for antenna models 29.996.00; 29.996.05; 29.995.60 (SCOUT)

**Base for V9176 masthead GLOMEX**



**29.862.38** Electropolished stainless steel, 200 mm high, 1" x 1/4 antenna universal thread.

**Base for V9181 pulpit GLOMEX**



**29.862.36** Electropolished stainless steel for 22/30 mm hoses.

**Base for V9171 antennas GLOMEX**



**29.862.40** Electropolished stainless steel for 22/80 mm hoses. 1" x 1/4 antenna universal thread.

**Accessories for antennas**

Code	Description
29.903.10	Antenna VHF plug for radio connection. Fitted with reducing coupling for cable RG-58. Suitable for cable RG-58 (standard thin cable) or for cable RG-213 (thick cable)
29.903.50	Double female connection
29.903.60	Double male connection



▲ 29.903.60



▲ 29.903.50



▲ 29.903.10

**RG-58/152 cable**

**29.800.01** Cable "RG-58/152", low attenuation with aluminum coating. Specially suitable for long paths as for example VHF antennas in mast heads onto sail boats, 100 meter coils,



**5-cm deck fairlead in golden colour**

**29.105.00** Stainless steel coaxial cable fitted with outer PVC cap, PL-259 golden connector, 2 x gold-plated nuts and chromed flange.



**Watertight connector protectors**



Code	For connections type
29.138.00	29.903.10; 29.903.50; 29.903.60

**New**

**Adapter for GLOMEX Starlink antenna**



**29.921.32** Adapter for Starlink antenna with mechanical function, made of stainless steel with a 1"x14 threaded attachment. Height is 88mm (3.5 inches). Compatible with bases 29.917.40 and 29.990.17. The Starlink cable can be routed inside the adapter's column, ensuring that the marine mount has a passage for the cable.

## Fishfinder Echo GARMIN

GARMIN

## GARMIN Striker™ fishfinders

The new Striker Vivid series has an outstandingly vivid colour display and offers a choice of palettes making it easier to distinguish fish and structure under and around your boat in maximum contrast and clarity. These fishfinders use traditional CHIRP, CHIRP ClearVü™ and, for the most complete versions, SideVü™ technology allowing to see anything that is at the sides the boat. All displays offer: GPS receiver, so not only can anglers see fish and structure below the boat, but they can also quickly mark favorite fishing spots and other areas of interest; Quickdraw Contours function for more demanding fishers to store maps with 30-cm contours; Wi-Fi®™ mobile connectivity for 7" and 9" versions by downloading the ActiveCaptain app.

Code	Garmin code	Model	Colour display	Built-in GPS	Depthsounder power W	CHIRP		Stern transducer included	←→  cm
						ClearVü	SideVü		
29.033.01	010-01870-01	STRIKER™ Plus 4	4.3"	Yes	200	No	No	Dual Beam (77/200 kHz)	9.8x17.4x4.5
29.033.04	010-02550-01	STRIKER™ Vivid 4cv	4.3"	Yes	300	Yes	No	GT20-TM CHIRP (77/200 kHz and CHIRP ClearVü 455/800 kHz)	9.7x17.4x4.5
29.033.07	010-02551-01	STRIKER Vivid 5cv	5"	Yes	500	Yes	No	GT20-TM CHIRP (77/200 kHz and CHIRP ClearVü 455/800 kHz)	18.8x11.4x6.6
29.033.09	010-02552-01	STRIKER Vivid 7cv	7"	Yes	500	Yes	No	GT20-TM CHIRP (77/200 kHz and CHIRP ClearVü 455/800 kHz)	23.6x13.9x5.8
29.033.11	010-02553-02	STRIKER Vivid 7sv	7"	Yes	500	Yes	Yes	No	23.6x13.9x5.8
29.033.13	010-02553-01	STRIKER Vivid 7sv	7"	Yes	500	Yes	Yes	GT52-TM High-Wide CHIRP (150-240 kHz and CHIRP ClearVü/SideVü 455/800 kHz)	23.6x13.9x5.8
29.033.16	010-02554-01	STRIKER Vivid 9sv	9"	Yes	500	Yes	Yes	GT52-TM High-Wide CHIRP (150-240 kHz and CHIRP ClearVü/SideVü 455/800 kHz)	28.8x16.4x8.5



▲ 29.033.01/04



▲ 29.033.07



▲ 29.033.08



▲ 29.033.11/13



▲ 29.033.16

## GARMIN EchoMAP™

GARMIN

## GARMIN UHD2 echoMAP™ chartplotter

Available in a 5-inch or 7-inch bright colour display, they're offered in a new graphic interface with a modern homepage and several innovative functions. The built-in Wi-Fi® enables seamless sharing of sonar - CHIRP traditional and ClearVü - and user data (waypoints and routes) between two Garmin compatible units to target and identify a wider array of images and a crisp view of structures in vivid color schemes. The EchoMAP™ UHD2 chartplotters support the Garmin Navionics+™ and Garmin NavionicsVision+™ charts. Upgrade your charts through the ActiveCaptain App in a simple and fast way.

Code	Garmin code	Model	Colour display	Sonar power W	CHIRP		Panoptix™ compatibility	Stern transducer included	←→  cm
					ClearVü	SideVü			
29.063.02	010-02589-00	Echomap UHD2 52cv	5"	500	Yes	No	No	-	18.8x12.2x6.2
29.063.03	010-02589-01	Echomap UHD2 52cv	5"	500	Yes	No	No	GT20-TM CHIRP (77/200 kHz e CHIRP ClearVü 455/800 kHz)	18.8x12.2x6.2
29.063.06 <b>New</b>	010-02679-00	EchoMap UHD2 62SV	6"	500	Yes	Yes	Yes	-	20.6x13.1 x6.7
29.063.07 <b>New</b>	010-02679-01	EchoMap UHD2 62SV	6"	500	Yes	Yes	Yes	GT54UHD-TM	20.6x13.1 x6.7
29.063.04	010-02593-00	Echomap UHD2 72cv	7"	500	Yes	No	No	-	23.2x14.3x6.7
29.063.05	010-02593-01	Echomap UHD2 72cv	7"	500	Yes	No	No	GT20-TM CHIRP (77/200 kHz e CHIRP ClearVü 455/800 kHz)	23.2x14.3x6.7
29.063.08 <b>New</b>	010-02683-00	EchoMap UHD2 72sv	7"	500	Yes	Yes	Yes	-	21.8x14.2 x8.1
29.063.09 <b>New</b>	010-02683-01	EchoMap UHD2 72sv	7"	500	Yes	Yes	Yes	GT54UHD-TM	21.8x14.2 x8.1
29.063.10 <b>New</b>	010-02678-00	EchoMap UHD2 92sv	9"	500	Yes	Yes	Yes	-	26.4x16.6x8
29.063.11 <b>New</b>	010-02678-01	EchoMap UHD2 92sv	9"	500	Yes	Yes	Yes	GT56UHD-TM	26.4x16.6x8



▲ 29.063.02/03/06/07



▲ 29.063.02/03/06/07



▲ 29.063.04/05/08/09/10/11



▲ 29.063.04/05/08/09/10/11

**New** GARMIN echoMAP™ Ultra2 chartplotter

The ECHOMAP Ultra 2 chartplotter features 10" or 12" touchscreens and its 600W built-in sonar provides photo-like images of fish and what's beneath the surface.

Available in bundle version with a GT56 transducer which provides Garmin CHIRP traditional sonar and Ultra High-Definition ClearVü™ and SideVü™ scanning sonars for images of what's beneath the surface.

This new series supports the full lineup of LiveScope live-scanning sonar products (transducers sold separately). Compatible with the optional Garmin Navionics+ and BlueChart G3 charts.



Code	Garmin code	Model	Display	CHIRP		Specification of the transducer sonar included	←→  cm	Built-in GPS
				ClearVü	SideVü			
29.045.11	010-02879-00	ECHOMAP™ Ultra 2 102sv	10"	Yes	Yes	No	29.5x19.5x9.8	Yes
29.045.13	010-02879-01	ECHOMAP™ Ultra 2 102sv	10"	Yes	Yes	GT56UHD-TM CHIRP: High Wide 150-240 kHz (350 W), ClearVü/SideVü: 455/800/1,000 kHz (500 W)	29.5x19.5x9.8	Yes
29.045.15	010-02881-00	ECHOMAP™ Ultra 2 122sv	12"	Yes	Yes	No	34.1x22.9x9.8	Yes
29.045.17	010-02881-01	ECHOMAP™ Ultra 2 122sv	12"	Yes	Yes	GT56UHD-TM CHIRP: High Wide 150-240 kHz (350 W), ClearVü/SideVü: 455/800/1,000 kHz (500 W)	34.1x22.9x9.8	Yes

**All-in-one transducers for echoMAP Plus**

All-in-one transducers with traditional sonar functions. ClearVu/ SideVu.

Code	GARMIN code	Model	ClearVu/SideVu frequency	Clear / Side power	Traditional frequency	Power
29.041.73	010-01966-00	GT51M-TM for stern	245/465 kHz	500W	80/160 kHz	600 W
29.041.74	010-01960-00	GT20 for stern 4 pins	455/800 kHz	500W	77/200 kHz	500 W
29.041.75	010-01960-01	GT20 for stern 8 pins	455/800 kHz	500W	77/200 kHz	500 W
29.041.76	010-12405-00	GT52 for stern	455/800 kHz	500W	150/240 kHz	250 W
29.041.77	010-12909-00	GT54UHD-TM for stern	455/800 kHz	500W	150/240 kHz	500 W
29.041.78	010-13072-00	GT36UHD-TM for stern	455/800 kHz	500W	150/240 kHz	350 W



**GARMIN GPSMAP™**



**GPSMAP 723 / 923 / 1223 (xsv)**

The GPSMAP chartplotters with sunlight-readable and highly backlit screen offer bright colours and crisp details for top light quality in any conditions.

With their added processing power and new slimline design, it's easy to retrofit these plotters in a wide range of dash configurations. Also available in the xsv version with the most advanced sonar functions on the market featuring a built-in 1kW single-channel CHIRP sonar with ClearVü-SideVü capabilities. Transducer sold separately.



Code	GARMIN code	Description	Model	Display	ClearVü	SideVü	Chart compatibility	←→  cm
29.044.25	010-02365-00	Chartplotter	GPSMAP 723	7" multipurpose touchscreen	No	No	Garmin Navionics - Bluechart G3	19.2x14x7.4
29.044.27	010-02365-02	Chartplotter + sonar	GPSMAP 723 xsv	7" multipurpose touchscreen	Yes	Yes	Garmin Navionics - Bluechart G3	19.2x14x7.4
29.044.26	010-02366-00	Chartplotter	GPSMAP 923	9" multipurpose touchscreen	No	No	Garmin Navionics - Bluechart G3	23.3x16.2x7.6
29.044.28	010-02366-02	Chartplotter + sonar	GPSMAP 923 xsv	9" multipurpose touchscreen	Yes	Yes	Garmin Navionics - Bluechart G3	23.3x16.2x7.6
29.044.48	<b>New</b> 010-02366-52	Chartplotter + sonar + radar GRM18HD3	GPSMAP 923 xsv	9" multipurpose touchscreen	Yes	Yes	Garmin Navionics - Bluechart G3	23.3x16.2x7.6
29.044.29	010-02367-00	Chartplotter	GPSMAP 1223	12" multipurpose touchscreen	No	No	Garmin Navionics - Bluechart G3	30.8x22.8x8.2
29.044.30	010-02367-02	Chartplotter + sonar	GPSMAP 1223 xsv	12" multipurpose touchscreen	Yes	Yes	Garmin Navionics - Bluechart G3	30.8x22.8x8.2
29.044.49	<b>New</b> 010-02367-52	Chartplotter + sonar + radar GRM18HD3	GPSMAP 1223 xsv	12" multipurpose touchscreen	Yes	Yes	Garmin Navionics - Bluechart G3	30.8x22.8x8.2

## Accessories for GPSMAP series



### GARMIN CHIRP transducers

Code	Garmin code	Model	Power	Frequency	Hull inclination
29.042.22 <b>New</b>	010-12401-00	GT8HW-TM	250 W	145-230 kHz	-
29.042.23	010-12401-10	GT8HW-IH	250 W	145-230 kHz	0-5°
29.042.25 <b>New</b>	010-02867-00	GT12M-THF	350 W	85-165 kHz	0-7°
29.042.26 <b>New</b>	010-02867-01	GT12M-THF	350 W	85-165 kHz	8-15°
29.042.29 <b>New</b>	010-02867-02	GT12M-THF	350 W	85-165 kHz	16-24°
29.042.21	010-12402-10	GT15M-TM	600 W	85-165 kHz	-
29.042.31 <b>New</b>	010-12402-20	GT15M-TH	600 W	85-165 kHz	0-25°
29.042.24	010-12402-00	GT15M-IH	600 W	85-165 kHz	0-25°



### GARMIN gWind transducers

The gWind transducer combines technology, know-how and design, and is an easy-to-install wireless solution that eliminates running wires down the mast.

The twin-fin design gives a more stable data reading while the front reading anemometer gives real wind speed in any weather condition.

Code	GARMIN code	Model	Case inclination	Transducer type
29.042.27	010-01227-00	gWind w/wire	-	Wind
29.042.28	010-01616-00	gWind Wireless 2	-	Wind



### **New** GMR 18 HD3 radar antenna

The cutting-edge technology of the GMR 18 HD3 radar gives high-definition images for even better safety and performance. Better target tracking, dynamic auto gain, dual-radar support and low-noise scanning.

Code	GARMIN code	Power	Beam		Rotation	Dual Range function	←→  cm	kg
			Horizontal	Vertical				
29.005.13	010-02841-00	4kW (range: 36 sea miles)	5°	25°	Up to 60 RPM	Yes	Ø 50,8	7,7



### GMR Phantom 18x dome radar

Check your targets from your chartplotter compatible with solid state GMR Phantom18x dome radars. In low visibility conditions or at night, a radar is crucial for navigation. These 50-watt solid-state dome radars has an increased range and enhanced target separation. They deliver up to 60 RPM rotation speed for a refresh rate that can detect movement at any speed. The power save feature lets you choose when you need more power or less. With timed transmit mode, you can even specify active and inactive times down to the second to help reduce power consumption. MotionScope™ detects moving targets and highlight them in different colours so you can navigate around them even in severe weather conditions.

Code	Colour	Garmin code	Power	Beam		Revolut ion	Dual Range function	←→  cm	kg
				Horizontal	Vertical				
29.005.15	White	010-02584-00	50 W (48 NM range)	5,20°	25°	60 RPM	Yes	Ø 50,8	6,5
29.005.16	Black	010-02584-10	50 W (48 NM range)	5,20°	25°	60 RPM	Yes	Ø 50,8	6,5



### GARMIN GPS antenna

The new dual-band GPS 24xd provides precise location accuracy and high reliability, fast GPS update rate and accuracy within 1 metre. Multi-band GNSS to within 1 metre to compatible marine multifunction displays, instrument displays and autopilots. Provides access to four key global navigation satellite systems (GPS, Galileo, GLONASS and BeiDou). Multi-SBAS (Satellite Based Augmentation System) compatibility. The magnetic heading sensor provides accuracy, stabilising charts, radar overlay and MARPA even at slow speeds. The antenna is IPX7 water-resistant and compatible with NMEA 2000 or HVS (NMEA 0183) devices.

Code	Colour	Garmin code	Description	Package contains
29.089.12	White	010-02316-00	Antenna GPS24 xd HVS NMEA 0183	GPS antenna, installation kit, 9-m long NMEA 0183 cable, instructions
29.089.13	White	010-02316-10	Antenna GPS24 xd NMEA 2000	GPS antenna, installation kit, 6-m long NMEA 2000 cable, NMEA 2000 T connector, instructions
29.089.15 <b>New</b>	Black	010-02316-20	Antenna GPS24 xd NMEA 2000	GPS antenna, installation kit, 6-m long NMEA 2000 cable, NMEA 2000 T connector, instructions



**GFS 10 fuel (petrol) flow sensor**

New flow sensor that connects to the charterplotters and to the Garmin screens to supply information about fuel flow and level, thus allowing calculations, as well as information of the fuel consumption and quantity left.



Code	Ø hose	Max Flow	Min Flow	Max return pressure	voltage	Fireproof	NMEA 2000
29.007.01	3/8"	190 l/h	7,5 l/h	0,5 PSI at 20 GPH/1,0 PSI at 40 GPH	10-22	Yes, in compliance with U.S. Coast Guard standards	Compatible

**GARMIN Quatix multifunction GPS watch**

Quatix 7 is designed to connect to Garmin compatible marine gear and to other devices to offer control for autopilot, data streaming, Fusion-Link™ entertainment and much more.

It uses traditional buttons or the new touchscreen interface. No matter where you go, know where you are with optional BlueChart® g3 coastal charts and inland maps.

It features the brilliant 1,3" AMOLED display to read the dial in any light condition.



Code	Garmin code	Description	Battery life	Led light	Q
29.074.14	010-02540-61	Quatix 7	Smartwatch: up to 18 days - All GPS systems: up to 40 hours	No	79
29.074.15 <b>New</b>	010-02803-81	Quatix Pro Amoled	Smartwatch: up to 16 days - All GPS systems: up to 42 hours	Yes	78

**GARMIN autopilots**



**GHP Compact Reactor for hydraulic steering system with GHC 50**

Designed for small- and medium-size boats fitted with hydraulic steering system. The solid-state 9-axis AHRS technology minimises heading error, course deviation, rudder movement and power consumption, while providing a comfortable ride for all onboard.

Multiple mounting options make it easy to install. This autopilot can be operated directly from your compatible chartplotter screen or by using GHC 50 control units.



Code	Garmin code
29.009.31	010-02731-00

**GHP GARMIN Reactor for mechanical steering systems**

The GHP REACTOR autopilot is the ideal solution for sailing and motor boats with mechanical, hydraulic and solenoid steering system. The innovative GHP REACTOR gives boaters the security of knowing they maintain control, even when relying upon the autopilot. Fitted with a spin-off of aerospace technology and with a solid-state 9-axis AHRS compass, the GHP REACTOR mounts nearly anywhere, in any orientation. Even when the boat is pitching and rolling in rough water, you can remain confident that the GHP Reactor autopilot will keep you on your desired course.



Code	GARMIN code	Description
29.009.20	010-02794-02	GHP REACTOR – RETROFIT / SOLENOIDS / MECHANICS COREPACK includes: GH50 display, ECU (Electronic Control Unit), CCU Reactor, CCU/ECU connection cable, acoustic warning, ECU power cable, NMEA 2000® installation kit.
29.009.22	010-11829-00	GRF10 rudder angle sensor, 2-m cable and installation kit
29.009.23	010-11533-00	Power cable for actuators
29.009.24	010-11572-00	Garmin mechanical linear actuator for rudder angle included.

**GHP GARMIN Reactor for hydraulic steering systems**

The GHP REACTOR autopilot is the ideal solution for vessels with hydraulic steering system. Fitted with a spin-off of aerospace technology and with a solid-state 9-axis AHRS compass, the GHP REACTOR mounts nearly anywhere, in any orientation. Even when the boat is pitching and rolling in rough water, you can remain confident that the GHP Reactor autopilot will keep you on your desired course. The patented Shadow Drive™ technology automatically disengages the autopilot if the helm is turned, allowing the helmsman to maneuver the boat. The autopilot automatically re-engages when the helmsman holds a steady course.



Code	GARMIN Code	Description
29.009.03	010-00705-64	1,2-l 12V reversible pump

## Portable GPS by GARMIN



▲29,075.61



▲29,075.62

### GARMIN GPSMAP 86

The innovative GPSMAP® 86i and 86s devices feature sunlight-readable 3" colour display and BlueChart g3 coastal charts that include the best of Garmin and Navionics® data for an unmatched detail level.

Wireless connectivity makes the exclusive GPSMAP® 86 systems a virtual extension of your onboard Garmin marine system for convenient operation of your autopilot, select FUSION marine products and real-time boat data displayed right on your handheld.

With built-in inReach satellite technology, GPSMAP 86sci helps you stay in touch globally. Send and receive two-way text messages, track and share your journey, and, if necessary, trigger an interactive SOS to get emergency help from a 24/7 global monitoring center via the 100% global Iridium® satellite network even out of mobile coverage.

Code	GARMIN code	Model	Charts	Wireless	Smart notifications	Remote control	INREACH functions	ABC sensors
29.075.61	010-02235-01	GPSMAP 86s	BlueChart g3	Yes	Always connected with Smart Notification, call notifications and SMS available on your display	Remote control function for Garmin autopilots and Fusion multimedia systems	No	Accelerometer, barometric altimeter and compass
29.075.62	010-02236-01	GPSMAP 86i	BlueChart g3	Yes	Always connected with Smart Notification, call notifications and SMS available on your display	Remote control function for Garmin autopilots and Fusion multimedia systems	Yes	Accelerometer, barometric altimeter and compass



**New**

### inReach® Mini 2 Marine Bundle

This satellite communicator marine bundle helps you stay connected to loved ones back home when you're off the grid, adding peace of mind to every boating adventure.

In an emergency, send an interactive SOS message to our coordination centre. With TracBack® routing feature navigates you back to your starting point the same way you came.

Stay on adventures longer with up to 14 days of battery life in 10-minute tracking mode.

Functions: GPS, high-sensitivity GPS receiver, GPS compass.

Code	GARMIN code	Model	Charts	Wireless
29.075.64	010-02602-30	inReach® Mini 2 Marine Bundle	BlueChart g3	Yes



### GARMIN GPS 73 portable GPS

GARMIN GPS 73 is heavy-duty and watertight. 12-channel receiver with 1-Hz GPS antenna for higher precision. 2.6-inch high-contrast single-colour display, 100 routes that you can navigate back to, specific navigation backup. GPS 73 is NMEA 0183 compatible. To transfer data to your device, it easily connects to your computer via USB and you can save navigation data or create routes via the free Garmin HomePort™ software.

An exclusive function allows you to set a starting line between two points and synchronize it with the regatta countdown timer to make sure you cross the starting line at the right time.

Internal database of the biggest cities, spotlights, navigation lights and lighthouses. 12/24-volt cable supply (OPTIONAL) or with 2xAA batteries; dimensions 6,6 x 15,2 x 3,0 cm, weight 218,3 g (batteries not included).

Code	Waypoint number and POI	Proximity waypoint	Man outboard function	Warning tones	Data sheet	Charts	MicroSD card	Supply
29.075.51	1000 - no POI	Yes	Yes	Yes	Fishing periods – sun/moon phases – tide tables	No	No	18 hours with batteries



### GARMIN GPSMAP 79s handheld GPS

Stay on course with the GPSMAP® 79s. This floating handheld GPS has a high-resolution colour display that can be read in the sun. The glass is even scratch-resistant and fogproof.

With support for multiple satellite constellations, it gets accurate, reliable tracking and positioning around the world. Get the world's basemap or the optional BlueChart® g3 charts.

More memory than previous models, it saves and tracks 10,000 waypoints and 250 routes. The built-in compass shows the heading.

Code	Compass	Charts	Battery lifetime	Display	Weight	↔ cm
29.075.63	Yes	Worldwide Basemap included	19 hours with GPS access	3"	273 g with battery	6,8 x 17,4 x 4,2

# RAYMARINE Element sonars



## RAYMARINE Element S 7", 9", 12" sonars

The new Raymarine Element™ models are the last generation of sonar/GPS modules. The quad-core powerful processor combines with the innovative LightHouse 3 Sport user interface for an incredibly easy-to-use navigation experience.

The quad-core processor offers superior performance and the Element display, visible under sunlight and in any weather condition, features excellent colours to show charts and navigation data.

- 7", 9" and 12" display.
- Compatibility with CPT-S transducers.
- Dedicated keypad.
- Quad-core processor with LightHouse 3 Sport user interface.
- Compatible with VHF, AIS, Autopilots, Engines, Tanks, Direction sensors, Quantum Wi-Fi Radars.
- Compatible with the best navigation charts such as Navionics, C-Map, Lighthouse, Fishing Hot Spots, Standard Mapping and many others.

Code	Description	Display	Resolution	CHIRP Conical (if purchased with CPT-S transducer)	GPS	Wi-Fi	Lighthouse Chart
29.702.07	Element 7 S	7"	800x480	x	x	x	No
29.702.08	Element 7 S	7"	800x480	x	x	x	Yes
29.702.09	Element 9 S	9"	800x480	x	x	x	No
29.702.10	Element 9 S	9"	800x480	x	x	x	Yes
29.702.12	Element 12 S	12"	1280x800	x	x	x	No
29.702.13	Element 12 S	12"	1280x800	x	x	x	Yes

29.070.02 Lighthouse Chart



## RAYMARINE Element HV 7", 9", 12" sonars

The CHIRP/GPS Element™ HV model from Raymarine gives you the upper hand when hunting for fish and their habitat. Delivering the sharpest view of the underwater world, Element's HyperVision™ 1.2 megahertz sonar technology turns up the resolution of DownVision, SideVision, and RealVision 3D to a new level of precision imaging

- 7", 9" and 12" display.
- Sonar Hypervision with CHIRP 3D technology supported by a single high-functionality level transducer.
- CHIRP 350Hz 1.2 Megahertz dual-frequency sonar.
- Dedicated keypad.
- Quad-core processor with LightHouse 3 Sport technology optimized for fishing.
- Compatible with the best navigation charts such as Navionics, C-Map, Lighthouse, Fishing Hot Spots, Standard Mapping and many others.
- Transducer included.

Code	Description	Display	Resolution	Transducer included	CHIRP Conical	CHIRP DownVision/SideVision/ 3DHyperVision	GPS	Wi-Fi	Lighthouse Chart
29.702.17	Element 7 HV	7"	800x480	HV-100	x	x	x	x	No
29.702.20	Element 7 HV	7"	800x480	HV-100	x	x	x	x	Yes
29.702.19	Element 9 HV	9"	800x480	HV-100	x	x	x	x	No
29.702.21	Element 9 HV	9"	800x480	HV-100	x	x	x	x	Yes
29.702.32	Element 12 HV	12"	1280x800	HV-100	x	x	x	x	No
29.702.33	Element 12 HV	12"	1280x800	HV-100	x	x	x	x	Yes

29.070.02 Lighthouse Chart



## Element accessories

Code	Description
29.702.80	4-m extension cable for HyperVision transducer
29.702.81	Element 7" recess fit mounting kit
29.702.82	Element 9" recess fit mounting kit
29.702.83	Element 12" recess fit mounting kit
29.702.84	Element 7" cover
29.702.85	Element 9" cover
29.702.86	Element 12" cover



# RAYMARINE Axiom instrumentation



## RAYMARINE Axiom+ touchscreen multifunction display

LIGHTHOUSE 3

The successor to Raymarine's award-winning Axiom® line, Axiom+ is engineered for top performance. Axiom+ comes with a powerful quad-core processor for speed and responsiveness. Designed for excellent viewing in a range of lighting conditions, the new, higher resolution IPS displays deliver 25% more brightness and new day/night color palettes offer enhanced visibility in any lighting condition. Axiom+ features the renowned LightHouse 3 OS, the most powerful and easy-to-use Raymarine MFD operating system to date.

Distinctive features of the Axiom+ range over the Axiom line:

- HYDROTOUGH™DISPLAYS: Nano-coated, impact-resistant glass screen repels water, oil, and smudges for better viewing and accurate touch controls.
- BRIGHTER: 25% brighter displays (up to 1,800 nit).
- SHARPER: IPS display technology delivers wider viewing angles and sharp contrast at twice the resolution of traditional displays.
- ENHANCED GPS: Next-generation, high-performance 10 Hz GPS/GNSS receiver with 4X increased sensitivity for accurate positioning.
- INTERNAL MEMORY: 16 GB solid state drive.

Code	Model	Sounder and stern transducer included	CHIRP Downvision, SideVision and 3D Realvision	Display size	Resolution	GPS	Wi-Fi	Front recess-fit installation kit	Lighthouse Chart included
29.705.07	Axiom+ 7			7"	-	x	x	29.704.97	No
29.705.08	Axiom+ 7			7"	-	x	x	29.704.97	Yes
29.705.09	Axiom+ 7RV	x	x	7"	-	x	x	29.704.97	No
29.705.10	Axiom+ 7RV	x	x	7"	-	x	x	29.704.97	Yes
29.705.12	Axiom+ 9			9"	-	x	x	29.704.99	No
29.705.13	Axiom+ 9			9"	-	x	x	29.704.99	Yes
29.705.17	Axiom+ 9RV	x	x	9"	-	x	x	29.704.99	No
29.705.18	Axiom+ 9RV	x	x	9"	-	x	x	29.704.99	Yes
29.705.39	Axiom+ 12			12"	-	x	x	29.704.92	No
29.705.40	Axiom+ 12			12"	-	x	x	29.704.92	Yes
29.705.32	Axiom+ 12RV	x	x	12"	-	x	x	29.704.92	No
29.705.33	Axiom+ 12RV	x	x	12"	-	x	x	29.704.92	Yes

29.070.02 Lighthouse Chart



▲ 29.705.07/08/09/10



▲ 29.705.12/13/17/18



▲ 29.705.39/40/32/33



▲ 29.704.97/99/92

### Transducers for Axiom/Axiom+/Axiom Pro/Axiom Pro 2 RAYMARINE

Code	Description	Compatible with
29.703.91	CPT-S stern transducer	Axiom RV / Axiom+ RV / Axiom PRO S / Axiom PRO RVX
29.703.92	CPT-S thru-hull plastic transducer with 12" tilted element	Axiom RV / Axiom+ RV / Axiom PRO S / Axiom PRO RVX
29.703.96	CPT-S thru-hull plastic transducer, 20 degrees	Axiom RV / Axiom+ RV / Axiom PRO S / Axiom PRO RVX
29.703.97	CPT-S indoor transducer	Axiom RV / Axiom+ RV / Axiom PRO S / Axiom PRO RVX
29.703.93	RV-100 stern transducer, Sonar and Down/Side/RealVision 3D	Axiom RV / Axiom+ RV / Axiom PRO RVX
29.703.94	RV-300 thru-hull plastic transducer, Sonar and Down/Side/RealVision 3D	Axiom RV / Axiom+ RV / Axiom PRO RVX
29.703.95	B265LM 1kW CHIRP thru-hull bronze transducer	Axiom PRO RVX



▲ 29.703.91



▲ 29.703.97



▲ 29.703.92/96



▲ 29.703.93



▲ 29.703.94



▲ 29.703.95

**New** RAYMARINE Axiom 2 Pro multipurpose touchscreen display

Axiom 2 Pro S combines chartplotter, sonar, radar, autopilot, and video into a powerful all-in-one navigation system. The Hybrid Touch system offers a simple touchscreen and keypad experience.

Get underway quickly with Axiom 2 Pro's powerful 6-core processor. GPS, fishfinder, radar and video are integrated seamlessly and faster with the super intuitive LightHouse operating system.

Axiom 2 Pro's HydroTough™ nano-coating technology repels water for reliable touchscreen control, enhanced colors, and excellent sunlight visibility.

Smart backlighting and an ambient light sensor automatically adjust display brightness for day and evening lighting conditions.

RealVision MAX optimizes fish research with a wider range, better resolution and clearer fishing targets.

The Axiom 2 Pro models with RealVision MAX feature an integrated 3D DownVision, SideVision, RealVision CHIRP sonar and a traditional 600W CHIRP fishfinder for coastal fishing in addition to a 1kW two-channel CHIRP fishfinder for deep water.

- Outstanding performance with the Quad core processor
- 10Hz 72-channel built-in GPS antenna
- Ultra bright IPS display
- Multitouch touchscreen and keypad
- NMEA2000 or SeaTalkNG connectivity
- Axiom Pro S models feature a CHIRP Sonar for depth up to 200 m. Axiom Pro RVM models have a CHIRP 1kW sonar to get deeper as well as 3D Down/Side/RealVision for higher definition of the sea bottom. In the RVM versions, the 3D Down/Side/RealVision transducer and the CHIRP 1kW one can be connected and work at the same time.
- Compatibility with Raymarine LightHouse, Navionics and C-Map charts with Autorouting functionality for Navionics+ and Platinum+ and Easy routing functionality for C-Map 4D MAX+.
- Wide connectivity to radar antennas, fishfinder modules, autopilots, thermal cameras, AIS receiver and much more.
- Free mobile Apps to view and control the display from your smartphone or tablet.
- ClearCruise™ AR for increased reality.
- Connectivity to the best Apps such as Netflix, Spotify, Seakeeper weather forecasts.
- Axiom UAV for integrated control of DJI Mavic Pro drones.
- Transducer not included.

Code	Model	CHIRP Sonar	Side/Down/RealVision 3D sonar	1kW CHIRP sonar	Display size	Resolution	Lighthouse Charts included
29.703.19	Axiom2 Pro 9 S	x			9"	1280x720	No
29.703.20	Axiom2 Pro 9 S	x			9"	1280x720	Yes
29.703.49	Axiom2 Pro 9 RVM	x	x	x	9"	1280x720	No
29.703.50	Axiom2 Pro 9 RVM	x	x	x	9"	1280x720	Yes
29.703.22	Axiom2 Pro 12 S	x			12"	1280x720	No
29.703.23	Axiom2 Pro 12 S	x			12"	1280x720	Yes
29.703.42	Axiom2 Pro 12 RVM	x	x	x	12"	1280x720	No
29.703.43	Axiom2 Pro 12 RVM	x	x	x	12"	1280x720	Yes



**Refitting kit without bore modification**

Upgrade your onboard electronics with the latest Axiom display range **without modifying the bore of your old display.**

Code	Description
29.602.16	Adapter plate to install Axiom 7 / Axiom+ 7 in bore e7x
29.602.17	Adapter plate to install Axiom 9 / Axiom+ 9 in bore a9x
29.602.18	Adapter plate to install Axiom 9 / Axiom+ 9 in bore C70 Classic
29.602.19	Adapter plate to install Axiom 9 / Axiom+ 9 in bore C80/E80 Classic
29.602.20	Adapter plate to install Axiom 9 PRO in bore E90W
29.602.03	ST1-STNG refitting kit



**Axiom multipurpose display accessories**

Code	Description	Compatible with
29.704.80	The Raymarine RMK-10 remote keypad is an ultra-compact wired keypad accessory that provides full control of the multifunction displays from whatever position.	Axiom and Axiom+
29.711.02	GPS RS150 10HZ antenna for STNG connection	Axiom and Axiom+
29.704.81	External RCR-1 card reader for bulkhead mounting	Axiom and Axiom+
29.704.83	90° power supply cable	Axiom and Axiom+
29.704.90 <b>New</b>	GA200 GPS antenna and GLONASS external receiver for direct connection to a/eS-series, AXIOM Pro & AXIOM XL	Axiom Pro, Axiom2 Pro and AIS 700
29.704.84 <b>New</b>	Axiom R70527 7" built-in cover	Axiom and Axiom+



## Raymarine antennas and accessories

Raymarine

**RAYMARINE FLIR AX8 thermal camera for engine room**

FLIR AX8 combines thermal imaging and a thermal camera in a package that generates automated spot alarms when temperatures exceed pre-set thresholds.

Compact and easy to install, FLIR AX8 thermal monitoring camera watches critical equipment on your vessel, including engines, exhaust manifolds, and shaft bearings, to spot problems before you're stranded on the water.

- Spots potential problems before they happen
- Thermal alarming and visual analysis.
- Raymarine integration.

Code	Description
29.718.73	AX8 thermal and video camera with overtemperature alarm system

**FLIR M232 thermal camera RAYMARINE**

The M232 pan and tilt camera is one of FLIR's smallest and affordable marine thermal cameras. Using the high-performance FLIR Boson™ thermal core with multi-core video processor, the M232 offers boaters superior quality images and thermal analysis functions.

Fitted with the complete pan/tilt and zoom functions.

Code	Description
29.718.71	M232 IP (320 x 240, 9Hz) thermal camera with Pan/Tilt move system and electronic zoom

## Raymarine



▲29.718.74



▲29.718.75

**RAYMARINE visible light marine cameras**

Visible light marine cameras offer an affordable marine CCTV solution. They perform well across a variety of lighting conditions and manage motion well. Simply plug and play with any compatible multifunction display.

High bright IR LEDs for operation in total darkness.

Power over Ethernet (PoE) or direct 12v DC power supply.

Code	Description
29.718.74	CAM210 Videocamera IP CCTV Day and Night - Bullet
29.718.75	CAM220 Videocamera IP CCTV Day and Night - Eyeball dome
29.718.76	CAM300 Videocamera IP CCTV Day and Night - Eyeball dome



▲29.718.76

**RAYMARINE RS150 10Hz GPS antenna with STNG connection**

29.711.02 10-Hz 72-channel GPS receiver for RAYMARINE new multifunction displays.

This GPS sensor offers fast and accurate position updates enabled with WASS, EGNOS, MSAS, GAGAN and GLONASS navigation satellite system support.

NMEA2000 compatible using an optional device net adapter cable to be ordered separately.

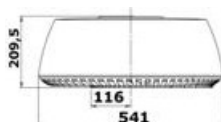
**RAYMARINE solid-state radar antenna**

- Solid-state radar antenna
- Immediate switching-on without pre-heating
- Cable or wireless connection to display
- Reduced consumption
- 24 NM range
- Adaptive digital receiver automatically adjusts to changing environmental and sea conditions for a dramatically clearer picture
- 256-color multi-level target display.

Code	Model	V	Range	kg
29.712.04	CHIRP Quantum wireless radar with 10-m power cord	12/24	24 NM	5
29.712.05	CHIRP Quantum wireless radar with power cord and 10-m data cable	12/24	24 NM	5

**RAYMARINE QUANTUM doppler solid state radar antenna**

Solid state radar antenna:  
 - Immediate awareness - Quantum starts up and is ready to go in seconds  
 - Cable-connected or wireless display  
 - Extremely low power consumption  
 - 24-mile range  
 - Digital adaptive receiver that automatically adapt to weather and sea conditions for increased definition images  
 - Superior target awareness in multilevel colours (256)  
 - Adjustable TrueTrails target history shows the motion history of moving contacts  
**- Fully automatic MARPA target tracking, along with manual MARPA mode.**  
 Using advanced Doppler processing, the system instantly highlights moving radar contacts and color codes them to indicate whether they are inbound or outbound



Code	Description	Colour
29.712.24	Quantum Q24D Radar Doppler 18" without power supply and data cables	<input type="checkbox"/> White
29.712.25	Quantum Q24D Radar Doppler 18" with 10-m power supply cable + 10-m data cable	<input type="checkbox"/> White
29.712.27	Quantum Q24D Radar Doppler 18" with 10-m power supply cable + 10-m data cable	<input checked="" type="checkbox"/> Black

**RAYMARINE Cyclone solid state open-array marine radar**

- Cutting edge design.  
 - Engineered for extremes with best-in-class 100-knot wind rating.  
 - Designed to meet the commercial grade IEC 62388 standard.  
 - Fast 60 RPM rotational speed.  
 - Enhanced Cyclone Bird mode to intelligently optimize gain.  
 - RangeFusion™ technology combines short and long pulses into the single high clarity radar image.  
 - Doppler target tracking.  
 - Professional grade ARPA target tracking. Cyclone automatically tracks up to 50 targets using the same advanced ARPA technology trusted by the United States Coast Guard.  
 - Innovative pedestal design conceals cable connections for a cleaner installation.

**Raymarine**



Code	Description
29.712.26	Cyclone 55 W 3-foot open-array radar with 15-m long cable

**RAYMARINE AIS700 data receiver**

Operating in the VHF maritime band, the Raymarine AIS-Automatic Identification System enables the radio exchange of navigation status between vessels and shore-side traffic monitoring centres.

Commercial ships, ocean-going vessels and recreational boats fitted with AIS transmitters broadcast AIS messages that include vessel's name, course, speed and current navigation status.

The new Raymarine AIS700 is a Class B AIS transceiver with built-in splitter for VHF antennas. Multiple connections such as SeaTalkNG, NMEA2000, NMEA0183.



Code	Description
29.710.96	AIS700 class B data receiver and transmitter with built-in splitter

**RAYMARINE Yacht Sense Hub**

A single locally- or remote-operated access point for all onboard services.

Streamlined for:  
 - Video streaming.  
 - Fast 4G Internet coverage.  
 - Single Wi-Fi access point for Internet surfing and onboard system control.  
 - Boat tracking.



Code	Description
29.711.70	Single access point for all onboard services

# RAYMARINE instruments



## RAYMARINE i40 compact digital displays

Compact yet powerful, they offer complete integration with Raymarine autopilots and navigation instruments, and can be mounted on a surface or a bracket. Very large types (max 28 mm) and extremely sharp LCD.

- General characteristics:
- Red background for better night vision
  - SeaTalk interface (SeaTalkng by using a converter)
  - Built-in transducer interface
  - Same size as ST40 Raymarine instruments
  - Large keys for easier use during navigation.

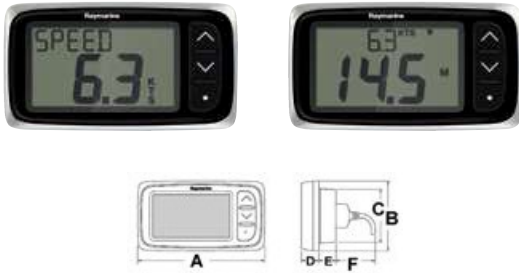

Code	Description	A mm	B mm	C mm	D mm	E mm	F mm
29.591.01	Speed display	128	72	55	18	17	30
29.591.02*	Depth display	128	72	55	18	17	30
29.591.03	Bidata display	128	72	55	18	17	30
29.591.04	Wind display	128	72	55	18	17	30

\* 80-m max range

## RAYMARINE i50 / i60 instruments

Designed to be combined with the new Raymarine e-Series and c-Series multifunction displays.

- General characteristics:
- Large keys for easy reading
  - Red background for better night vision
  - SeaTalk and SeaTalkng interface
  - NMEA2000 interface (compatible)
  - Integrated transducer interface
  - Dimensions: 110mm x 115mm (same as ST60+)
  - Large keys for easier use during navigation
  - Multiple data sources to avoid data clashes
  - Front mounting for very easy installation.
  - The package includes a front panel to make these instruments similar to the eS series.



Code	Model	Description
29.592.01	i50	Speed display (digital)
29.592.02*	i50	Depth display (digital)
29.592.03	i50	i50 Tridata display (digital)
29.593.01	i60	i60 Wind display (analogic)
29.592.20	Complete package including instruments, transducers and connection cables	i50 Speed + i50 Depth + i60 Wind display + Speed (E26031) + Depth (M78713-PZ) + Wind (E22078) transducers

\* 80-m max range.

## i70 multipurpose RAYMARINE instrument

Large 4" LCD display, easy to read and perfectly visible from any angle and distance. The i70 instrument can be customized depending on the boat type. It offers traditional analogical screens as well as details about engine and fuel or information as AIS repeater: the i70 Raymarine can display all required data.

Technical data:  
4" LCD display with 160° visual angles, 43-mm number in full screen mode. Anti-reflection treatment. Light House interface. AIS repeater.  
Data supported: wind, speed, depth, tridata, engine (NMEA 2000), environment (NMEA 2000), fuel (NMEA 2000) and navigation.

To be connected to traditional transducers by adding a POD or to smart transducers.



Code	Power	Display dimensions	Resolution
29.603.01	12 V via STNG	LCD 4,1"	320x240 (QVGA)

## Transducers and sensors for RAYMARINE instruments

Code	Reference	Description	ST40/i40	ST60/i50s/i60s	i70
29.590.13	E26009	Thru-hull depth plastic transducer (9-m cable)	•	•	
29.600.13	M78713-PZ	Thru-hull depth plastic (P19)	•	•	• (with POD iTC5)
29.600.17	E26001-PZ	Internal adjustable depth transducer	•	•	• (with POD iTC5)
29.590.12	E26008	Thru-hull speed/temperature plastic transducer (9-m cable) – Short	•	•	
29.600.12	E26031	Thru-hull speed/temperature plastic transducer (13,8-m cable) (P120-ST800)	•	•	• (with POD iTC5)
29.600.21	Z195	Wind Rotavecta transducer (20-m cable)	•	•	• (with POD iTC5)
29.600.20	E22078	Wind standard mast head transducer (30-m cable)		•	• (with POD iTC5)
29.600.42	E70010	Multiple POD converter for 5 iTC5 transducers			•
29.600.25	T120	Wind wireless transducer		•*	•*
29.600.26	E70670 RSW	Vento Smart Performance transducer, short arm with 30-m cable	-	-	-

\* Compatible via gateway interface 29.602.15

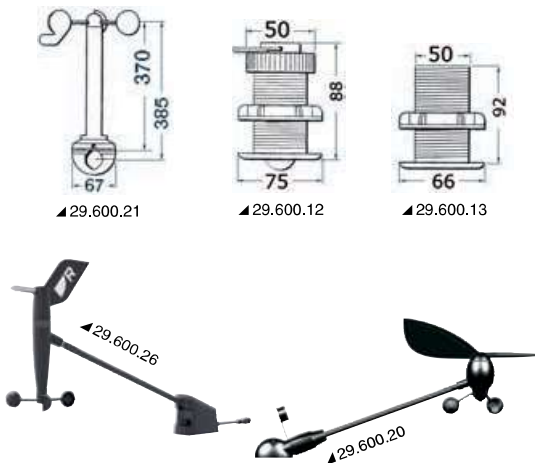



**TACKTICK wireless instruments**

The TACKTICK Wind system is 100% solar powered and needs no wiring. Install the display by means of its mounting bracket and mast head transducer, switch it on, and wind speed/direction will be displayed.

Code	Description	Package content
29.589.01	T101 wind system	Wind analogic display and masthead transducer with mounting base

29.602.15 MN 100 to STNG interface gateway available  
 29.600.25 Only wireless Wind transducer available.



**Autopilots RAYMARINE**



**Autopilots RAYMARINE**

RAYMARINE bar pilots, micro-processor control, Fluxgate compass; autolock course memory, off course alarm, automatic veering 100°, simple installation, LCD viewer, ST1000/2000.

Type	Code	Power V	W	Max thrust kg	Travel cm	Suitable for hulls max kg
ST1000Plus	29.620.10	12	6	57	25	2500
ST2000Plus	29.620.11	12	6	77	25	4500

Instructions available in the following languages: ITA - ENG



**RAYMARINE inboard/outboard cockpit autopilots**

The Evolution™ Autopilot Package includes the control unit, the EV-1 sensor, the power unit and an actuator. The most suitable actuator and ACU depends on the type of steering system and on the displacement of the vessel.

Code	Description	Boat type	Package includes				
			EV	ACU	rudder angle	control unit	actuator
29.623.07	EV-100 Power	Motor vessels, hydraulic steering (cylinder capacity: 50-110 cc)	EV-1	100	not supplied as standard	p70Rs	hydraulic pump, type 0.5
29.623.00	EV-100 Wheel	Sailing vessels, max displacement 7,500 kg * (wheel steering)	EV-1	100	not supplied as standard	p70s	wheel actuator
29.627.03	EV-150 Hydraulic pack	Motor vessels, hydraulic steering (cylinder capacity 80-230 cc.)	EV-1	150	no	p70Rs	hydraulic pump type 1
29.627.02	EV-200 Linear pack	Sailing vessels, max displacement 11,000 kg * (wire/quadrant steering)	EV-1	200	yes	p70s	mechanical linear type 1
29.623.03	EV-100 Tiller	Sailing vessels, max displacement 6,000 kg * (rudder steering)	EV-1	100	no	p70s	bar-type

\* Take into consideration full load displacement.



**RAYMARINE P70s/P70Rs instruments and autopilot control units**

New Light House interface easy to configure.

Code	Model	Version	Power	Display	Resolution
29.603.02	P70s	Push button control	Via STNG network	LCD 3.5"	320x240 (QVGA)
29.603.03	P70Rs	Push button/knob control	Via STNG network	LCD 3.5"	320x240 (QVGA)





**RAYMARINE SeaTalkNG networking cables**

STNG is a cabling and connection system compatible with NMEA 2000. One of the advantages of the STNG system is that the connector collars are retained on the product which allows for a smaller cable diameter making installations easier. Products with STNG connectors can be used on NMEA 2000 networks and conversely NMEA 2000 equipment networks to SeaTalkng cabling through simple connector adaptors.

Code	Description
29.602.01	Basic STNG kit includes: 1 x 5-way connector, 2 x terminators, 1 x 3-m spur cable and 1 x power cable.
29.602.03	ST1 to STNG converter kit
29.602.04	STNG T piece
29.602.05	5-way connector
29.602.06	3-m STNG Backbone cable
29.602.07	5-m STNG Backbone cable
29.602.08	9-m STNG Backbone cable
29.602.09	20-m STNG Backbone cable
29.602.10	1-m STNG Spur cable
29.602.11	0.4-m adaptor cable - adapts STNG to NMEA2000 network. Female end
29.602.12	1.5-m adaptor cable - adapts STNG to NMEA2000 network. Male end
29.602.13	STNG terminator
29.602.14	12V STNG power cable
29.602.15	STNG gateway interface for wireless wind transducer 29.600.25

BackBone and Spur cables of different length available upon request.



**NMEA 2000 connectors**

NMEA 2000 connectors are the industry standard for data communications among shipboard electronic devices (GPS data, wind, depth, AIS, etc.). Products supporting the NMEA 2000 system allow multiple electronic devices to be connected together (up to 50 devices) on a common channel for the purpose of easily sharing information (controls and status included).



**Kit of NMEA 2000 connectors**

**IP68** Connectors: made of metal.  
Type: Micro (22 AWG; 24AWG).  
Colour: blue.

Code	Description
29.360.01	Power cable for system with 3A TEE terminal, 5 x IP68 contacts, 4A connector, 3A cable Female terminal connector, 5 x IP68 contacts, 5 x 60V contacts, 120 Ω resistance Junction knot with 3 x NMEA 2000 2F+1M IP68 4A receptors, 60V NMEA 2000 IP68 3A male/female connection cable, 60V, 5 x 2-m contacts

**NMEA 2000 connector**

**IP68** Connectors: made of metal.  
Type: Micro (22 AWG; 24AWG).  
Colour: blue.



Code	Description	Length m	Power	Notes
29.361.01	Male/female cable	1	3 A	-
29.361.03	Male/female cable	3	3 A	-
29.361.05	Male/female cable	6	3 A	-
29.361.12	Male/female cable	12	3 A	-
29.363.02	Junction knot with 3 x NMEA 2000 2F+1M receptors	-	3 A	-
29.364.01	Male terminal connector	-	-	Resistance 120 Ω
29.364.02	Female terminal connector	-	-	Resistance 120 Ω
29.363.15	Power cable for system with TEE terminal	-	3 A (cable) 4 A (connector)	-
29.363.04	2-way connector NMEA 2000 IP68 5 contacts 4A 60V	-	4 A	-
29.363.06	4-way connector NMEA 2000 IP68 5 contacts 4A 60V	-	4 A	-

## Accessories for electrical equipment

### Noise suppressor

**29.451.20** For installation in the power lead to depth sounders, GPS, Plotters, radio-telephone, etc. It eliminates interference from energy-hungry alternator or onboard instruments (anchor windlasses, radars, etc) and protects instruments against power discharges; 12 V, 60 watt (5Amp), intervention time 5 nanos, peak power 4500 Amp, dissipated energy 45 joules.



### GLOMEX deck nylon fairlead

**29.140.00** Universal for one two cables, the connector is also able to pass through.



### GROUNDPLATE mass plates equipped with special nuts and bolts

Made of porous bronze, ideal for achieving an appropriate mass while installing Loran, GPS, Satellites, radio-telephones SSB and help cut-down radio interferences.

Code	Type	Equal to copper grounding m <sup>2</sup>	mm
29.630.01	Standard	1,15	155x51x13
29.630.00	Medium	2	205x64x13
29.630.02	Giant	3,45	300x80x13



## Portable and panel depth sounder

### VEETHREE echosounders for recessed mounting on dashboard

It reads from 0,7 to 61 meters up to 101 km/h (63 mph). LCD polarised display. Meters or feet scale. Min. and max. depth alarm (acoustic and optical), 250W max power, 200-khz stern transducer with 9-m cord. Depth calibration depending on the hull immersion (keel offset).

Code	Dial	Ring
29.230.31	Black	Black
29.230.30	White	Polished SS



▲ 29.230.30



▲ 29.230.31

### NORCROSS portable depth-sounder with built-in transducer

Easy to use: rest it on the boat bottom (fiberglass, aluminium, rubber, etc.) from the inside or put it into water for depth reading.

Technical data:

- Range 0,6-72 m (possibility to select 2-240 foot scale).
- Display of water and air instantaneous temperature.
- Smart DepthTrax™ transducer to prevent false signals.
- LCD display.
- Sensitivity gain automatic adjustment.
- Shoot-Thru™ technology: the signal passes through the bottom or the ice or putting it into the water.
- Float with shock resistant rubber cover.
- Waterproof up to 50 metres under water (it can also be used by scuba divers since it's IPX8 watertight).
- Power: 1 x 9V (6LR61) alkaline battery.



Code	mm
29.028.02	200x60



## Hand depth sounder and transducer support



### Manual depth sounders made from lead

Convenient probe, compact size.

Code	Cable		housetline marked	kg
	made of	length		
29.510.00	nylon	30 m	every meter and every 10 m, fitted with two marks	1.5



### Telescopic stern transducer support

**29.758.00** Made of AISI 316 stainless steel, fits into all stern transducers for depth sounders and can be raised lowered or removed, length 30 cm.



### Universal telescopic stern transducer support

Made of aluminium, the transducer can be raised, lowered by 115 mm or completely removed.

Code	Description
29.756.00	Vertical coupling, for stern transducers.
29.757.00	Horizontal coupling, for ground transducers.

## Radar brackets

**SCANSTRUT**



### SCANSTRUT 150-mm aluminium Power Tower

Designed to install the antenna on the cabin roof, on the flybridge or on the A-frame for optimum performance. For radomes Raymarine 2kW/4kW (ex. Quantum), Garmin and Navico 3G/4G and small satellite antennas such as TracVision KVH M2/M3.

Fitted with a SCANSTRUT DS30 watertight gland, it is made of polyester powder coated aluminium for a mirror finish that lasts in time.

Easy installation without sealant, it comes with inserts that adapt to the cables of all the above mentioned antennas.

Code	Colour
29.900.10	White
29.900.11	Black

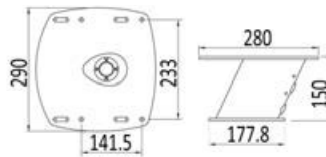

**SCANSTRUT**



### SCANSTRUT Mast Mount SC20

**29.901.10** Made from marine-grade aluminium and coated with a unique marine paint system.

It attaches to the mast with four swivel feet, matching a variety of mast profiles. 12-point fixing using high-quality rivets for the antenna to extend the minimum distance from the front of the mast.

It comes with a safety wire kit that independently attaches the radar to the mast in case an accident damages the installation.

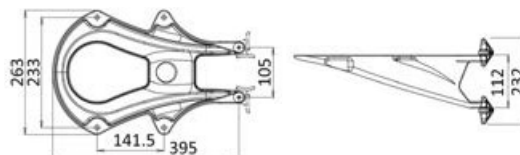

# GPS navigation charts

**New**

## RAYMARINE Lighthouse Chart

**29.070.03** The new Raymarine LightHouse Charts brings a new level of clarity to marine GPS navigation. These flexible marine charts can be downloaded for Axiom and Element display via the RayConnect dedicated app. When you buy the charts, you can download two regions. The Premium version offers satellite images and points of interest such as service centres, dealers, workshops, services, main roads and restaurants. The LightHouse Charts are also available with global coverage areas. See more on [www.raymarine.it](http://www.raymarine.it)

**Raymarine**



## NAVIONICS maps

**Navionics Platinum:** multi-dimensional Navionics mapping with 3D visualisation - satellite and aerial pictures - panoramic harbour pictures - harbour services and points of interest - dynamic tide icons

**Navionics Gold:** exceptional detail - bathymetric lines - harbour plans - currents and tides - services - excellent coverage.

**Navionics +:** exceptional detail - bathymetric lines - SonarChart™ - Auto-routing - Plotter Sync - harbour plans - currents and tides - services - excellent coverage. Chose between 29.080.08 (Mediterranean Sea areas, Black Sea, Canary Islands and Azores) and 29.080.11 (empty). This latter can be downloaded by the final user with one of the XL9 Navionics + areas from [navionics.com](http://navionics.com).

**Navionics + Small:** exceptional detail - bathymetric lines - SonarChart™ - Auto-routing - Plotter Sync - harbour plans - currents and tides - services. SD/Micro SD card sold empty; the user can download the desired Italian or European areas among those indicated here below from [navionics.com](http://navionics.com). It is also possible to download the Mediterranean Sea maps or the map of similar areas paying the difference on [navionics.com](http://navionics.com).

Code	Mapping model	Electronic support	Size
29.080.09	Navionics + Small	SD / Micro SD	Small
29.080.08	Navionics + 43XG	SD / Micro SD	XL9
29.080.11*	Navionics + empty	SD / Micro SD	XL9
29.080.35	Platinum +	SD / Micro SD	XL3

Areas of interest XL9 NAVIONICS +: **1XG** Us & Canada; **3XG** Caribbean & South America; **20XG** Greenland & Iceland; **28XG** Uk, Ireland & Holland; **30XG** Africa & Middle East; **31XG** Indian Ocean And South China Sea; **34XG** Pacific; **35XG** China Sea And Japan; **43XG** Mediterranean & Black Sea; **44XG** Baltic Sea; **45XG** Skagerrak & Kattegat; **46XG** Central & West Europe; **49XG** Norway; **50XG** Australia And New Zealand; **52XG** Russia West

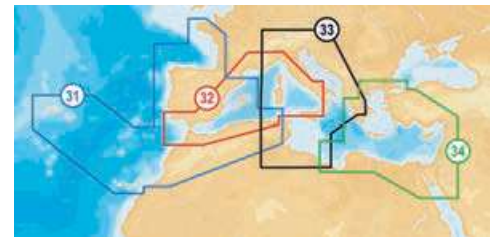

29.080.35 (XL3)

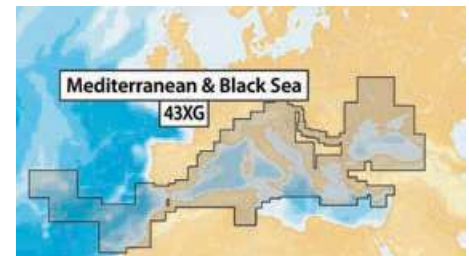

29.080.08 (XL9 Navionics +)

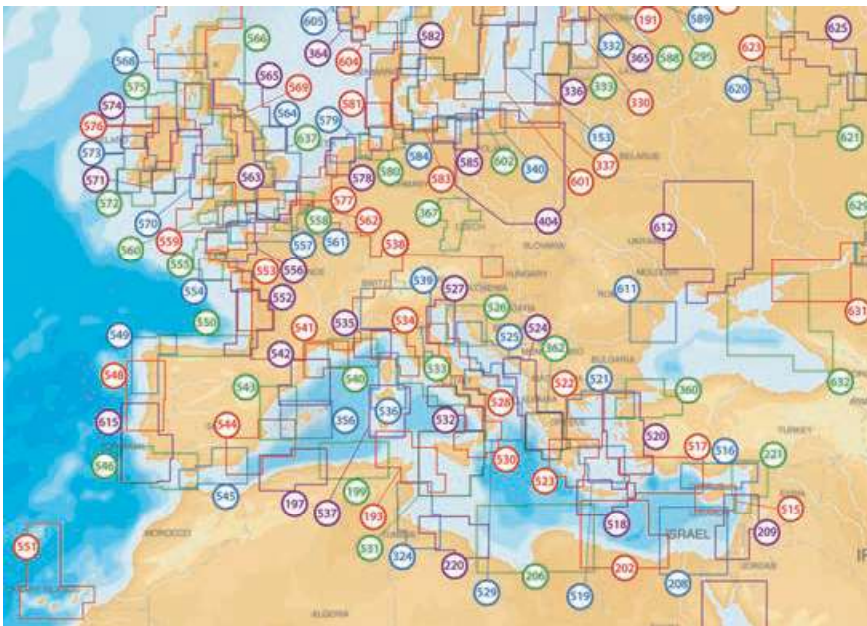

29.080.09 (Europe - Small)

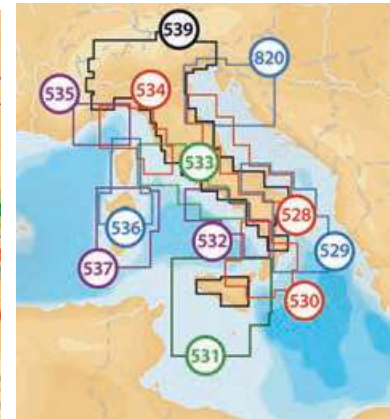

29.080.09 (Italy - Small)



29.080.11 (XL9 Navionics +)

## Navionics Updates

**29.080.10** It is the most convenient product devoted to continuously enhancing your old cartography and getting the most up-to-date Navionics+ (one-year update program included). This online upgrade service to Navionics+ is compatible with Navionics (Gold or Silver but not Platinum+) as well as cards from other brands such as C-MAP, Fishing Hot Spots, Garmin, LakeMaster, Lowrance, Magellan and TrakMaps. To activate your new Navionics Updates card, simply connect it to your computer, click Downloads & Updates and verify eligibility using any compatible card from Navionics or other manufacturers. In about 15 minutes you will get the Navionics+ XL9 most updated charts and services. Navionics Updates can also be used to update Navionics+ cartography one year after purchase, once the standard chart update has expired.



**GARMIN Navionics charts**



Garmin charts with integrated contents for coastal charts and inland maps. Garmin Navionics+ and Garmin Navionics Vision+™ premium maps offer bright Navionics® style colours, map daily updates, Auto Guidance+™ advanced technology and much more.

Code	GARMIN code	Chart model	Electronic support	Size
29.061.02	010-13158-00	Garmin Navionics+ Europe	Micro SD CARD	regular/regular
29.061.03	010-13159-00	Garmin Navionics+ Europe	Micro SD CARD	large
29.061.05	010-13166-00	Garmin Navionic Vision+ Europe	Micro SD CARD	regular
29.061.06	010-13167-00	Garmin Navionic Vision+ Europe	Micro SD CARD	large

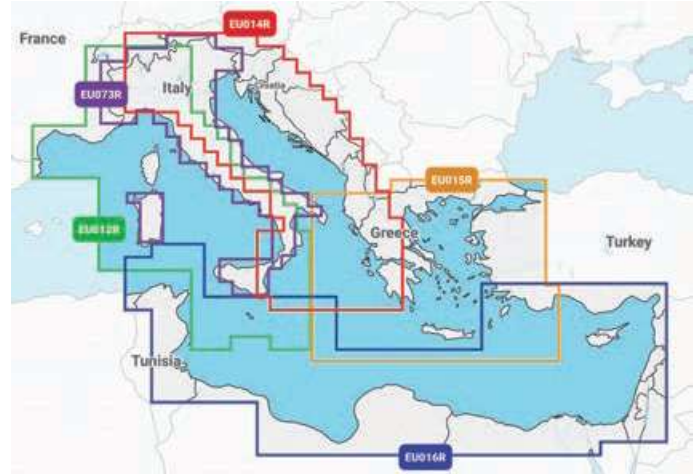
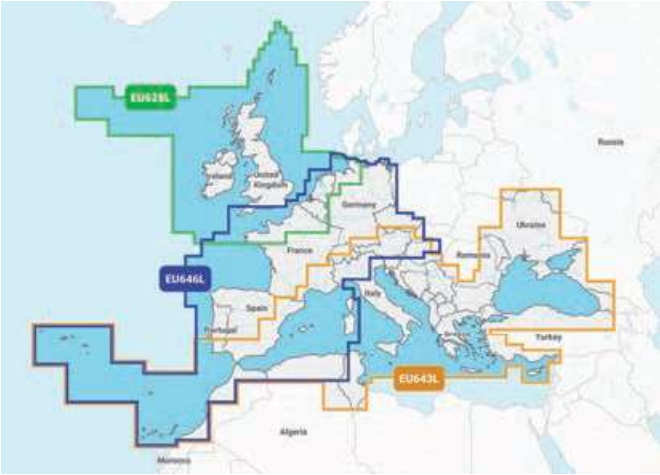

**Portable VHF and accessories**

**COBRA MARINE MR HH150FLTE portable VHF**



- Portable. - Manufacture: IPx7 (watertight for 30 minutes @ 1 metre depth).  
 - Floating. - Scanning: on all channels. - Dual Watch (scanning of Channel 16 + 1 to choose). - Rx indicator: on 3-notch graduated bar. - Tx power: Max 3W - Mid 1W - Min 0.5W. - Sound power: 250 mW - 8 Ω. - Intermediate Rejection: -70 dB. - Power supply: 5 x NIMH batteries or AAA alkaline batteries. - Duration: 9 hours. - Absorption: Tx: 1.1 A, Rx: 100 mA, Standby: 40 mA. - Dimensions: 117 x 69 x 38 mm.  
 - Weight: 227 g without batteries. - Other characteristics: Roger Beep, battery level

Code	mm	g
29.661.02	117x69x38	227 without batteries

**COBRA MARINE VHF MR HH 350**



Technical Details: - IPX7 waterproof and floating - 1/3/6 W power - All international channels - BURP function to expel water from microphone - Unlimited channel programming - TRI-WATCH: Channel 16 + 2 programmable channels - Jack for external microphone/speaker - Channel/ Memory scan - Background noise suppression - High-visibility display -- Key Lock to prevent accidental use - Signal strength Meter.  
 Supplied with 1000 mAh LION battery + 220V battery charger with desktop + 12V (cigarette lighter) charger + belt clip.

Code	mm	g
29.661.04	121x67x53	272

**VHF COBRA MARINE MR HH500 Bluetooth - floating**



This VHF has a **Bluetooth function for mobile phone interface** which can then be stored in a safe place. The product can be used as a standard VHF, or as a telephone using the Bluetooth connections.

Technical data: Waterproof to IPx7 - floating - 6-watt power - All international channels - "Rewind" function to listen to the last calls - Exclusive BURP function to drain excess water from the speaker grill, Signal Meter - Unlimited channel programming - Tri-Watch function for channel 16 + 2 selected channels - Jack for external microphone / speaker - Scanner for memorised channels - Key Lock to prevent accidental use - Background noise suppression - High visibility display.

Equipped with 1000-mAh lithium battery pack with 220V desktop charger + 12 V charger (cigarette lighter plug) + antenna + belt clips.

Code	mm	g
29.661.06	62x36x123	228

**COBRA MARINE MR HH600 GPS BT EU VHF**



Hand-held VHF complying with the highest safety standards. The MR HH600 GPS BT EU combines all the functions of a DSC class "D" with a 66-channel GPS, a torch, the strobo function, the Microblue Bluetooth Technology and many other Cobra Marine features.

Built-In GPS Receiver & DSC that shows GPS coordinates on screen and automatically sends GPS location and MMSI with DSC calls. The radio's light can be used as a flashlight or S.O.S. signal, and the light ashes automatically when dropped in the water.

Technical features: built-in DSC class "D", GPS with 66 channels programmed in memory up to 200 waypoints, built-in flashlight and emergency strobe, Microblue Bluetooth technology, IPX8 watertight, floating design and high-visibility orange core, 6 W, Rewind Say Again, Burp function, Noise Cancelling.

Code	mm	g
29.661.07	131x72x47	329

## Fixed VHF

### GARMIN 115i and 215i AIS VHF

Garmin last-generation communication systems feature innovative design, sturdy and compact. They provide standard Class D DSC functionality (distress calling and direct calling with user programmed MMSI). Just plug and play via the NMEA 2000 network to compatible Garmin chartplotters and MFDs for a real onboard integrated system. The VHF 215i AIS radio displays AIS (Automatic Identification System) on the chartplotter to enhance communication, situational awareness and collision avoidance between you and other mariners.

Code	GARMIN code	Description	Max power	Power V	Mounting	Built-in AIS	Removable microphone
29.084.20	010-02096-01	VHF Garmin 115i	25 W	12	Recess/Bracket	No	No
29.084.21	010-02098-01	VHF Garmin 215i AIS	25 W	12	Recess/Bracket	Yes	Yes



### COBRA MARINE F77-EU VHF

IPx7 watertight device.  
25/1 watt power. Instant access to channel 16 and DSC.  
In addition to all VHF standard functions:

- Built-in GPS: it shows the geographic coordinates when the DSC is activated
- Radio check (check of batteries, transmission power and antenna)
- Rewind say Again (to listen again important messages)
- NMEA inlet/outlet
- Vocal amplifier
- Soft Key function
- Alarm inlet
- Signal reception bar
- Kit for recess mounting included.

Code	Power V	Colour	mm
29.645.01	12	Grey	180x159x57 H



### RAYMARINE Ray63/Ray73 VHF radio

The new Ray63/Ray73 are full-sized VHF radios packed with all the essential communication features that every boater needs. Add the optional handset accessory and you can use your Ray63/Ray73 from 2 locations onboard. The handset also enables intercom calling from station to station.

- Class D DSC receiver.
- Integrated GPS with possible additional external passive GPS antenna (in compliance with the new EN301025 regulations).
- DSC button for GPS position data and digital mayday transmission.
- Instant access to channel 16.
- NMEA0183 and NMEA2000 connectivity.
- Large back-lit LCD screen.
- Dual station with optional RayMic accessory.
- 2 handsets can be connected wireless.
- Ray73 with integrated AIS module.
- IPX6 and IPX7 watertightness.
- Output for fog horn.

Code	Description	Power V	Mounting	Built-in AIS and loudspeaker output
29.718.26	VHF Ray63	12	Bulkhead or bracket	No
29.718.27	VHF Ray73	12	Bulkhead or bracket	Yes
29.720.06*	Raymic second station for Ray63/Ray73	-	-	-
29.720.07	10-m extension cable for Raymic 29.720.06	-	-	-

\* Extension cable not included.

## Raymarine

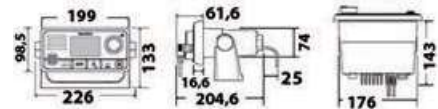

### RAYMARINE VHF Ray53 radio

This radio combines a powerful communication system into a case that is small enough to mount just about anywhere.

- 25W transmission power.
- Class D DSC transceiver.
- Simple integration with other onboard electronics via NMEA0183 or NMEA2000 networking.
- DSC button for GPS position data and digital mayday transmission.
- Instant access to channel 16.
- NMEA0183 and NMEA2000 connectivity.
- Large back-lit LCD screen.
- IPX6 and IPX7 watertightness.

Integrated GPS with possible additional external passive GPS antenna.

Code	Description	Power V	Mounting	Built-in GPS
29.718.25	VHF Ray53	12	Bulkhead or bracket mounting	Yes

## Raymarine

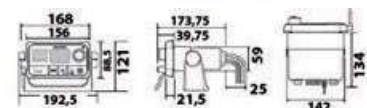

## WEATHER FLOW & SKYWATCH portable anemometers



### WEATHER FLOW anemometer for Smartphones

This small but very precise anemometer turns your devices into an information detector for everyday navigation. It is compatible with iPhone, iPad, iPod, and Android smartphones/tablets. iOS6.0 or Android 4.3 operating systems required. Just plug it into the audio socket.  $\pm 0,5\%$  or 0.1 m/s max error. 0.1 to 56 m/s range. It reads in meters/second, miles/hour, knots, and Beaufort scale. It saves wind speed (average and max) and direction. Shock-proof rubber case.

Code	Type	Tech spec	Connection	↔ mm
29.801.24	Wind meter	Wind speed and direction	AUX direct	82x40x18



### SKYWATCH Wind hand-held anemometer

**29.801.15** The Skywatch® Wind measures wind speed, air temperature and wind-chill rapidly and accurately.

Small enough to bring anywhere, insensitive to dust and shock with a user-replaceable propeller. Powered by a lithium battery (30-g weight, 41x109x17 mm, precision  $\pm 3\%$  FS).

Data displayed: 1) instant wind speed in knots, km/h, mph, m/s and maximum wind speed; 2) temperature from -30° C to +70° C (-22° F + 158° F); 3) wind chill (perceived temperature) depending on the wind speed, measure range from 3 to 185 km/h.

### SKYWATCH EOLE-METEOS portable anemometer

Professional instrument supplying the following:

- 1) wind instant speed
- 2) wind average speed over 24 hours
- 3) wind max speed over 24 hours

- Speed measured in km/h, m/s, knots, mph, fps, bft
- Back-lighting
- Size Ø mm 65x155
- 2 AA battery power
- Watertight and floating
- Propeller protection

Code	Type
29.801.16	EOLE 1



### SKYWATCH Atmos portable anemometer

Professional instrument indicating: instant, maximum and medium wind speed in Km/h, mp/h, m/s, fps, knots, beaufort 2 to 150 Km/h; instant, maximum and medium -20° + 70° temperature; perceived temperature; 2 to 100% instant, maximum and medium humidity hygrometer, dew-point calculation.

Code	Type	Batteries	Backlighting	Watertight	↔ mm
29.801.17	ATMOS	2xAA	YES	YES	Ø 65x115

## Instrument holder

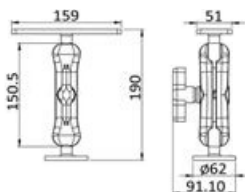

### Universal instrument holder

Made of black anodized light alloy, the base and the multi-bore plate for the instrument are connected by a ball joint for better adjustment. Loosen the wing nut locking on the side to pull out the plate and instrument from the base to prevent theft.

Code	↔ plate mm	Base Ø mm	Overall height mm
29.759.00	158x50	62	185

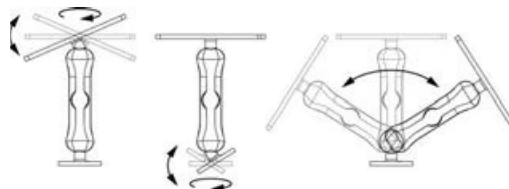



## EPIRB (emergency beacons)

### Man Over Board based on AIS transmission

The W420 device is an MOB signalling system designed to be carried by individual crewmembers on life vests or oilskins. It activates within 5 seconds of falling overboard. The in-built GPS receiver communicates the MOB position via AIS transmission.

- AIS operating modes (AIS1 and AIS2, power 2 W).
- Minimum 24h continuous operation.
- Inbuilt GPS receiver.
- Compact and lightweight.
- Manual activation and automatic activation when coming into contact with water (very useful in case of unconscious shipwrecked)
- High-efficiency flashing light to help rescuers pinpoint the shipwrecked's precise location in poor visibility or bad weather conditions.
- Ready to use, no specific maintenance needed.
- 5-year battery storage life. Batteries are easily replaceable by the final user.

Code	Model	↔ mm	📏
29.650.00	W420	125x65x25	140

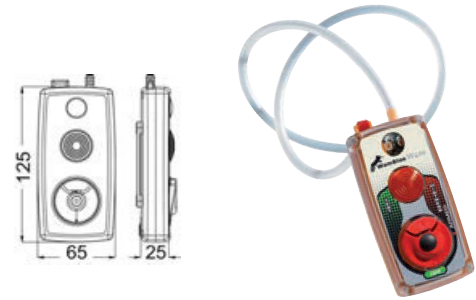

**New**

### Epirb1 OCEAN SIGNAL with manual GPS CAT2

MED type-tested. Manual-release Float-Free with 66-channel built-in GPS. Very bright LEDs. In compliance with Class 2 = -20°C +55°C, Slip-in antenna and quick coupling bracket, Safety strap, 48h operating time, 5-year warranty, 10-year battery duration.

Code	Model	↔ mm	📏
29.646.02	EPIRB1	178x89	422



**New**

### Pro OCEAN SIGNAL Epirb with CAT1 automatic GPS

MED type-tested. **Automatic-release** Float-Free with 66-channel built-in GPS. Very bright LEDs. IMO & GMDSS. In compliance with Class 2 = -20°C +55°C. It meets all the international standards, IMO and GMDSS included. Slip-in antenna. 48h operating time, 5-year warranty, 10-year battery duration.

Code	Model	↔ mm	📏
29.647.02	EPIRB1 Pro	237x191x121	1250



## Monitoring and remote-control system

### ZigBoat - GLOMEX wireless remote control system



ZigBoat™ is a cutting-edge wireless monitoring system that interacts with your boat from a remote or local control station for safe use. This system uses the ZigBee and WiFi wireless technologies as well as direct communication with onboard sensors without a cloud. This allows for real-time forwarding of push notifications when critical events occur. Moreover the ZigBoat™ application controls your boat's data at all times.

**ZigBoat is available in two kit versions:** the first includes gateway, battery sensor, bilge water sensor, hatch/portlight sensor; the second includes gateway, battery sensor, bilge water sensor and 4G device to connect the gateway to the Internet. **You can also create your own customized configuration** buying the gateway + single sensors.

Code	Description
29.304.00	ZigBoat kit including: gateway, battery sensor, bilge water sensor, hatch/portlight sensor
29.304.20	ZigBoat Connectivity kit including: gateway, battery sensor, bilge water sensor and USB key for SIM card for gateway-to-Internet connection)
29.304.01	ZigBoat gateway
29.304.02	Battery sensor
29.304.03	Bilge water sensor
29.304.04	Hatch/portlight sensor
29.304.05	Temperature variation sensor
29.304.06	Fume sensor
29.304.07	Motion sensor
29.304.09	Shore Power sensor
29.304.11	Smart plug (to switch on and off electronic devices from a remote station)
29.304.12	Wireless GPS sensor
29.304.13	ZigBoat Link: 5G Plug & Play device for Internet connection



▲ USB key



▲ Gateway



▲ 29.304.13



▲ Battery sensor



▲ Smart plug 220 V



▲ Hatch/portlight sensor



▲ Motion sensor



▲ Bilge water sensor



▲ Fume sensor



▲ Temperature sensor

# Internet and 5G/4G/wi-Fi/GPS mobile GSM antennas



▲29.921.07



▲29.921.08



▲29.921.30

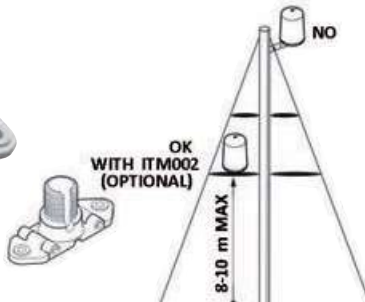

## GLOMEX WebBoat Antenna

### CAT 6

weBBoat® 4G Lite EVO and weBBoat® 4G Lite High Speed are COMPACT COASTAL INTERNET 4G/Wi-Fi SINGLE SIM and ALL-in-ONE integrated systems designed by Glomex to surf the web at sea (up to approximately 15 miles from the coast) and in marginal signal areas on land.

The system provides the perfect balance between small dimensions and great performance, ensuring stable and high speed connections.

The weBBoat® 4G Lite are equipped with two 4G diversity antennas, one Wi-Fi antenna (EVO model) and 2 Wi-Fi 2,4GHz MIMO antennas (High Speed model), and a 4G/Wi-Fi router that creates a safe hotspot on the boat and motorhome. Up to 24 different devices can be used simultaneously without any degradation to the signal or performance. The units built-in advanced switching software allows the user to save money on costly roaming and overage charges by automatically switching to Wi-Fi when available.

weBBoat® 4G Lite EVO ensures high connection speed, up to 100Mbps in DL, that allows you to surf the web, make video calls, watch streaming platform along the coast, weBBoat® 4G Lite High Speed is an enhanced system ensuring a much higher connection speed, up to 300Mbps in DL. Moreover, it has a new double power processor and the carrier aggregation function for optimizing the speed of data transfers and taking advantage of all the potential offered by the net.

The weBBoat® 4G Lite are true Plug & Play devices that requires minimal setup and only one power lead for the antenna which operates from 10-30 Vdc. Most importantly, all functions of the units are controlled by the free App which is available for both Android and iOS devices. weBBoat® 4G Lite have additional features such as automatic APN, SMS management/reading/sending to monitor internet consumption and automatic switching mode with onboard satellite internet devices/V-SAT and an encrypted real-time peer-to-peer connection for remote set-up and service

Code	Version	V	←→  mm	kg	Range
29.921.07	WeBBoat 4G Lite EVO	9/30	Ø 140 x 200 h	0,9	15 miles
29.921.08	WeBBoat 4G Lite High Speed	9/30	Ø 140 x 200 h	0,9	15 miles

**29.921.30** *OPTION Support for spreader on sailboat mast for WebBoat lite made of reinforced nylon, fitted with two hinges for mounting on curved or rounded surfaces. 1"x14 thread, side or central cable outlet. Install the WebBoat at a 8/10-m max height.*



▲29.921.10



▲29.921.31

## weBBoat® GLOMEX Plus 5G

**Connessione 5G / 5G Connection    LTE CAT 16    DUAL SIM AUTOMATIC**

weBBoat® Plus 5G is the new WORLDWIDE Dual SIM 5G/4G/Wi-Fi All-in-One Plug & Play COASTAL INTERNET system designed by Glomex to get the internet on board and a secure Wi-Fi hotspot inside and outside the boat thanks to the in-built 5G/4G and Wi-Fi antennas for fast connection over 20 miles from the coast. Download speed in 5G – up to 2,5 Gbps thanks to module CAT 24. 5G offers a connection with the same level of fibre connection, but totally wireless and therefore perfect to be used on board. Moreover, if you sail in an area with no 5G signal coverage, the LTE CAT 16 unit allows you to have a 4G connection speed up to 1Gbps. Inside the dome, there are 4 x high performance 5G and 2 x 2,4/5GHz MIMO Wi-Fi antennas for optimizing the speed of data transfers with a huge increase on the connection speed. That means that you can either watch streaming TV channels and platforms such as Netflix or Amazon Prime offshore, or work remotely from your boat, using internet connection as like you would be on the mainland. Equipped with the new revolutionary Glomex MIoT Routerboard platform with a super-powerful processor, that highly increases the connection speed compared to other existing internet wireless systems. Among the main weBBoat® Plus 5G features there are: -Carrier aggregation: flexible bandwidth option in LTE that allows to combine multiple bands of the carrier into one big channel and therefore significantly improve the achievable data rates and speed -Automatic APN: Easier and Faster configuration with the automatic selection of your SIM card carrier APN. -Easy configuration and management with weBBoat® App -Priority function: possibility to choose which type of Internet connection is used and in which assigned priority order between Wi-Fi of marina/internet data via SIM cards installed inside the unit -SAT - satellite internet -Encrypted real-time peer-to-peer connection for remote set-up & service. -In-built speed-test feature.

Code	Version	V	←→  mm	kg	Range
29.921.10	weBBoat® Plus 5G	10/30	Ø 250x300 h	1,2	25 miles

**29.921.31** *OPTIONAL: Anti-yellowing reinforced nylon mount with adjustable base for installation of the weBBoat 4G Plus on the cross tree. 25-mm Ø. Fixing rivets/screws not included.*



**New****GLOMEX weBBoat® Link PRO 5G**

5G/4G/Wi-Fi COSTAL INTERNET

DUAL MICRO SIM

weBBoat® Link PRO 5G is the new WORLDWIDE Dual SIM 5G/4G/Wi-Fi Coastal Internet system to get the internet on board and a secure Wi-Fi hotspot inside and outside the boat available to be used on 32 devices at the same time.

weBBoat® Link PRO 5G is fitted with 4 x 5G and 2 x 2,4/5GHz MIMO Wi-Fi antennas for optimizing the speed of data transfers up to 15 miles off the coast.

weBBoat® Link PRO 5G allows you to use different types of Internet connection, even combining Internet via a 5G/4G mobile network, Wi-Fi and satellite connection (if any). The performance will be at the same level of a fiber network but totally wireless and therefore ideal to be used on board.

Among the main weBBoat® Link PRO 5G features are:

- Brand new Firmware and user interface with new functions.
- Carrier aggregation: flexible bandwidth option in LTE that allows to combine multiple bands of the carrier into one big channel and therefore significantly improve the achievable data rates and speed.
- Automatic APN: easier and faster configuration with the automatic selection of your SIM card carrier APN.
- Easy configuration and management with weBBoat® App.
- Priority function: possibility to choose which type of Internet connection is used and in which assigned priority order between Wi-Fi of marina/internet data via SIM cards installed inside the unit/SAT - satellite internet.
- Encrypted real-time peer-to-peer connection for remote set-up & service.
- Built-in speed-test feature.

weBBoat® Link PRO 5G



Code	Version	V	Range	5G download speed	4G download speed (LTE) CAT16	Internet antennas
29.921.11	weBBoat Link PRO	10/30 Vdc	15 miles	up to 2,5 Gbps	up to 1 Gbps	4 x 5G + 2 x 2,4/5GHz MIMO Wi-Fi antenna

**New****GLOMEX weBBoat® Link PRO 5G EXT**

5G/4G/Wi-Fi COSTAL INTERNET

DUAL MICRO SIM

weBBoat® Link PRO 5G EXT is the new Dual SIM 5G/4G/Wi-Fi Coastal Internet system working worldwide. It consists of a unit to be placed inside the boat + 4 x 5G high-gain antennas to be placed outside and 4 x LMR200 7-m coaxial cables to surf the Internet and to have a safe Wi-Fi hotspot both inside and outside the boat up to 20 miles from the coast.

Up to 32 devices can be used at the same time with no signal or performance degradation.

weBBoat® Link PRO 5G EXT allows you to use different types of Internet connection, even combining Internet via a 5G/4G mobile network, Wi-Fi and satellite connection (if any). The performance will be at the same level of a fiber network but totally wireless and therefore ideal to be used on board

Among the main weBBoat® Link PRO 5G are:

- Brand new Firmware and user interface with new functions.
  - Carrier aggregation: flexible bandwidth option in LTE that allows to combine multiple bands of the carrier into one big channel and therefore significantly improve the achievable data rates and speed.
  - Automatic APN: easier and faster configuration with the automatic selection of your SIM card carrier APN.
  - Easy configuration and management with weBBoat® App.
  - Priority function: possibility to choose which type of Internet connection is used and in which assigned priority order between Wi-Fi of marina/internet data via SIM cards installed inside the unit/SAT - satellite internet.
  - Encrypted real-time peer-to-peer connection for remote set-up & service.
  - Built-in speed-test feature.
- Available on request with 10- or 20-m cable.

weBBoat® Link PRO 5G EXT



Code	Version	V	Range	5G download speed	4G download speed (LTE) CAT16	Internet antennas
29.921.12	weBBoat Link PRO EXT	10/30 Vdc	20 miles	up to 2,5 Gbps	up to 1 Gbps	4 x 5G outdoor antennas + 2 x 2,4/5GHz MIMO Wi-Fi antenna

**New****Mobile MiMo 5G antenna GLOMEX**

**29.921.13** Multi-band 5G/4G(LTE)/GSM/UMTS/GPRS high-performance antenna. It's the ideal solution for interfacing with the weBBoat® Link PRO 5G using a single omnidirectional antenna in a 250x300mm (10x12") radome with 4 SMA female pigtail terminals. Two terminals refer to two dipole antennas optimized for frequencies from 1,5GHz to 6GHz; the other two terminals are associated with a dual-monopole antenna optimized for frequencies from 600MHz up to 6GHz. It can also be used in conjunction with other 5G routers, respecting frequency ranges during installation.

1.5dB gain achieved at 600MHz.

7dB gain achieved at 6GHz.

Lightweight and resistant to shocks, corrosion, and extreme environmental conditions.

2 wideband vertical polarization dipole antennas + 1 dual-monopole antenna.

