

# 50



## Sinks and accessories



### Round sink

Made of mirror polished **stainless steel**. Drain plug **not included**.

Code	mm		Depth mm
	inner Ø (A)	outer Ø (B)	
50.187.35	260	285	180
50.187.36	300	330	180
50.187.37	360	385	180
50.187.38	380	420	180

50.186.98; 50.186.99 *OPTIONAL Drain plugs*

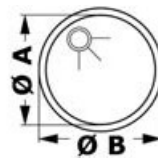

Profondità



### Rectangular sinks

Made of brush polished **stainless steel**. Drain plug **not included**. Rectangular sinks can match.



Code	mm		Depth mm
	internal AxB	external with an edge CxD	
50.187.23	238x300	260x325	150
50.187.24	150x300	175x325	150
50.187.25	298x328	325x350	150
50.187.26	237x330	250x360	150
50.187.33	330x330	360x360	150

50.186.98; 50.186.99 *Drain plug OPTIONAL*

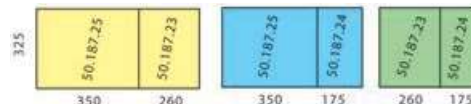
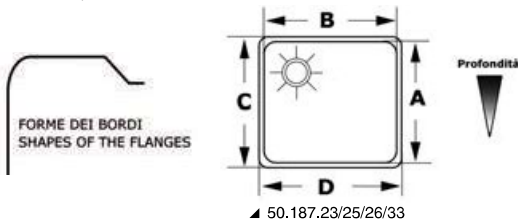

COUPLING SINKS LAYOUTS (size mm)

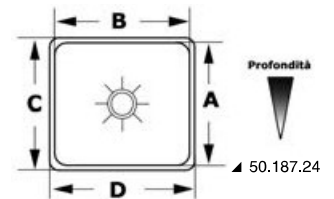

### Oval sink

Made of mirror polished **stainless steel**.



Code	mm			Drain OPTIONAL
	external	internal	depth	
50.186.84	265x385	240x355	125	50.186.98; 50.186.99

### Round and oval sinks

Made of mirror polished **stainless steel**.



Code	Shape	mm		Drain OPTIONAL
		mm	Depth mm	
50.186.85	circular	Ø 387	155	50.186.98; 50.186.99
50.186.86	oval	510x390	155	50.186.98; 50.186.99

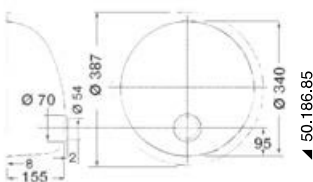

**Double sink**

Made of polished stainless steel.

Code	←→  mm		Height mm	Drain OPTIONAL
	external	basins		
50.186.80	600x320	330x300 + 240x300	155	50.186.98; 50.186.99

**Hemispherical bathroom sinks**

Made in stainless steel mirror polished.

Code	Ø mm		Overflow	Depth mm	Drain OPTIONAL
	internal	external			
50.188.91	360	385	no	150	50.186.98; 50.186.99
50.188.92	260	292	no	125	50.186.98; 50.186.99
50.188.93	300	335	no	140	50.186.98; 50.186.99

**Rectangular sink**

Made of stainless steel.

Sold with 90° drain and 20-mm hose connector.

Code	Width mm	Height mm	Depth mm
50.930.00	280	380	150

**Rectangular sink made of white polished plexiglas**

Very fine finish.

Code	←→  mm	Drain OPTIONAL
50.188.81	330x280x140	50.170.41; 50.270.41

**Oval plexiglas sink**

Specially suitable for bathrooms.

Code	←→  mm	Drain OPTIONAL
50.188.94	370x290x150	50.170.41; 50.270.41

**Angle sink**

Made of thermoformed white ABS.

Code	←→  mm	Drain OPTIONAL
50.270.47	280x270x102 (depth)	50.170.41; 50.270.41

**New Square sink**

White ceramic sink for surface mounting. Tap not included.

Code	←→  AxBxC mm
50.189.11	400x300x130

 **50.186.97** Chromed brass drain. 75-mm long with push-pull closure and 1" 1/4 thread. Also used to fix the sink onto the flat rest surface.



50.186.97  
Optional

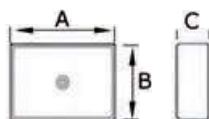



▲ 50.188.98/99

▲ 50.188.88

**Hemispheric ceramic sink, for surface mounting**

White	Black	Ø mm	Height mm
50.188.98	50.188.88	365	140
50.188.99	-	410	160

🔧 50.186.97 Chromed brass drain. 75-mm long with push-pull closure and 1" ¼ thread. Also used to fix the sink onto the flat rest surface.



▲ 50.186.97  
Optional



▲ 50.186.97  
Optional

**Transparent glass hemispheric sink**

Code	Ø mm	Height mm
50.189.34	280	105
50.189.36	360	130

🔧 50.186.97 Chromed brass drain. 75-mm long with push-pull closure and 1" ¼ thread. Also used to fix the sink onto the flat rest surface.



▲ 50.183.01



▲ 50.184.01



▲ 50.184.01

**Countertop sinks in Ocritech**

Matt colour sink featuring a modern and sleek design.  
Version with built-in drain plug of the same colour.  
Min. 20-pcs order: Round version with pre-assembled white drain plug included.  
Min. 20-pcs order: external coating in RAL colour available.

Code	Shape	Colour	Drain included	Drain optional	Dimensions mm	g
50.183.01	Round	White	-	50.186.97	Ø 300	-
50.184.01	Semi-oval	White	Yes	-	350 x 260	-
50.184.03	Semi-oval	White/Beige (RAL 1019)	Yes	-	350 x 260	-
50.184.21	Semi-oval	White	Yes	-	450 x 260	-



▲ 50.184.03



▲ 50.184.21

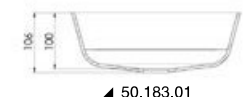
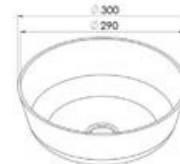

▲ 50.183.01

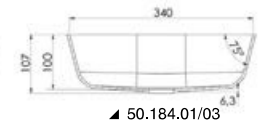

▲ 50.184.01/03

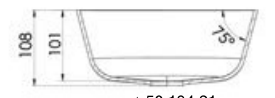
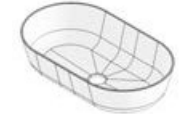

▲ 50.184.21



**Stainless steel wall mounting sink**

Foldable against the wall, fitted with stainless steel tap.  
Very sturdy, you can lay against it without breaking it.  
Fitted with soap holder.

Code	←→  mm	Overhang	
		closed mm	open mm
50.188.70	375x320	145	345



**OSCOLATI**

**ABS wall foldable sink**

Includes foldable faucet 17.046.02.

Code	Recess mm	External mm	Inside overhang mm	Open sink plane mm
50.188.68	440x390	520x460	320	380x390

**Fitted with 90° side drain outlet**

Made of **stainless steel and moplen**; includes plug handle.

Code	Ø mm	Grating Ø mm
50.186.96	20	70
50.186.98	25	70

**Straight drain outlet**

**Stainless steel and plastic**, fitted with plug.

Code	Threads	Grating Ø mm
50.186.99	1"1/4	70

**Sink drains**

Made of **white nylon**, suitable for all sink models 50.270.47; 50.188.81-94; 50.930.00.

Type		Hose connector mm	Ledge Ø mm
bent 90°	straight		
50.170.41	50.270.41	28	50

**Kit of drains with chain plug and drain pipes**

Fitting for two sinks, easy installation.

Code	Drain flange Ø mm	Bore Ø mm	Pipe Ø mm	Chain length cm
50.185.40	70	60	40	35

**Drain with 5° inclination horizontal outlet, plug with chain**

Convenient plug with chain. Easy to install.

Code	Drain flange Ø mm	Bore Ø mm	Inclined outlet	Outlet Ø mm	Chain length cm
50.185.01	70	60	5°	25.4 (1")	35

**60-mm Ø strainer drain**

Small space-saving strainer drain with no-overflow pipe. Removable strainer, easy installation.

Code	Drain flange Ø mm	Bore Ø mm	Fitting	Pipe Ø mm
50.185.02	70	60	M1 1/2"	40

**90-mm Ø strainer drain**

Small space-saving strainer drain with no-overflow pipe. Removable strainer, easy installation.

Code	Drain flange Ø mm	Bore Ø mm	Fitting	Pipe Ø mm
50.185.03	115	90	M1 1/2"	40

**Drain with chromed mushroom head plug**

Drain with strainer, and 1 1/4" fitting and mushroom head plug. Removable strainer, elegant design, easy to clean.

Code	Flange Ø mm	Bore Ø mm	Fitting
50.185.06	63	45	1 1/4"

**Push-Pull chromed brass drain outlet**

Length 75 mm, fitted with push-pull closing system and with thread size 1" 1/4; it is also used to mount the sink onto a support base.

Code	Length mm	Thread
50.186.97	75	1" 1/4

**Swivelling hose adaptor**

Can be removed for cleaning, to be used together with drains on stainless steel sinks.

90°	Straight	From mm	Threads	ORDER BY BOX
-	50.187.01	20	1"1/4	1
50.188.02	50.187.02	25	1"1/4	1





## Cooktops



### Portable gas hob with integrated bottle and cartridge

Stainless steel body, piezo incorporated, safety thermocouple. Supplied in hard plastic case for carrying or onboard stocking.

Code	mm	kg	Cartridge type	Cartridge OPTIONAL
50.275.05	33x28.5x8.8	2	A4	50.275.06

50.275.06 A4 cartridge, sold in 4-pc package



### External stainless steel hob units

Fitted with safety thermocouples.

Code	No of burners	external mm	Burner W	OPTIONAL trivet
50.103.45	1	210x290x90h	1750	50.100.91
50.103.47	2	440x290x90h	1900+1000	50.100.92



### External stainless steel hob units

Fitted with safety thermocouples.

Code	No of burners	external mm	Burner W	OPTIONAL pot holder
50.101.45	1	210x290x90h	1750	50.100.48



### Two burner cooker

Made of mirror polished stainless steel. Fitted with safety thermocouples.

Code	cm
50.281.00	50x31x10

## Flush mount Hob Units



### Stainless steel flush mount hob unit

Extra compact, fitted with safety thermocouples.

Code	No of burners	Outside mm	Overhang mm		Burner W	Pot holder
			external	internal		
50.101.44	2	350x320	30	80	1750x2	50.100.49 OPTIONAL
50.101.42	2	380x360	30	80	1750x2	50.100.49 OPTIONAL
50.101.48	3	470x360	30	80	1000+1750+3000	50.100.50 OPTIONAL

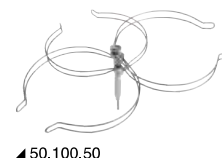
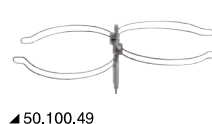

**Recess-fit stainless steel cooktop**

Extra-compact models complete with safety thermocouple.

Code	No of burners	mm		Burner W	Pot holder
		outside	recess		
50.102.43	1	323x263	305x245	1750	50.100.91
50.102.44	2	323x353	305x330	1750+1000	50.100.92
50.102.45	2	323x528	305x508	1750+1000	50.100.92



**Recess-fit stainless steel cooktop**

Supercompact version fitted with safety thermocouple

Code	No of burners	mm		Burner W	Pot holder
		outside	recess		
50.103.43	1	320x285	280x245	1750	50.100.91
50.103.44	2	350x320	280x310	1750x2	50.100.92
50.103.42	2	380x360	320x340	1750x2	50.100.92
50.103.48	3	470x360	320x430	1000+1750+3000	50.100.93

**OSCULATI**



**TECHIMPEX cooktop**

Made of stainless steel fitted with high quality burners. All equipped with safety thermocouples. Fine finish, top quality design.

**TECHIMPEX**

Code	N° burners	Burners W	Pot holder set + flame guard OPTIONAL
50.100.52	2	2300+1700	50.100.54
50.100.53	3	2300+1700+1000	50.100.55

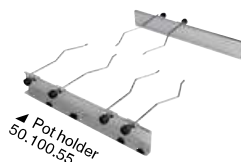
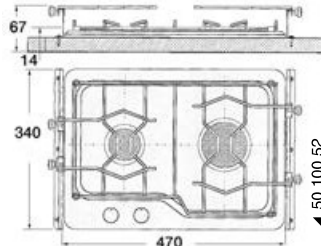
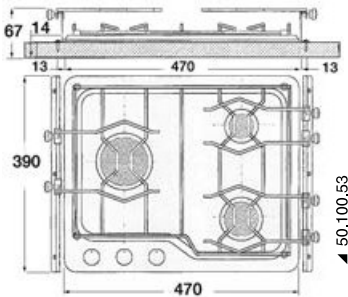
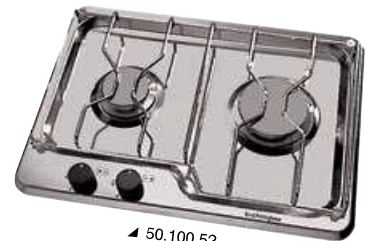



▲50.706.11



▲50.706.12



▲50.706.13

### Gas hob with pyroceram burners

Fitted with safety thermocouple.

Code	No of burners	←→  mm		Power W	Column pot holder OPTIONAL
		outside	recess		
50.706.11	1	325x290	270x305	1900	50.100.91
50.706.12	2	500x300	480x280	1750+3000	50.100.92
50.706.13	2	380x280	360x260	1000+1750	50.100.92
50.706.14	3	504x410	484x390	1000+1900+3000	50.100.93



▲50.706.14



▲50.100.93



▲50.100.92



▲50.100.91



▲50.709.12



▲50.709.13

### Gas hob with pyroceram burners

Fitted with thermocouple.

Code	No of burners	←→  mm		Power W	Column pot holder OPTIONAL
		outside	recess		
50.709.12	2	500x300	480x280	1900+3000	50.100.49
50.709.13	2	380x280	360x260	1000+1750	50.100.49



▲50.100.49

**New**

### Gas hob with glass top

**GAS**

**NON ELECTRIC**

Innovative hob for boats: safe, easy to use, ecologic and stylish. The burners are placed under the glass top and heat the surface so that the flame burns safely even in outdoor and windy places.

Designed to be installed even on boats without a generator.



Code	No of burners	←→  mm	V	Power kW	Current draw W	kg
50.601.02	2	460x280x70	12	2,4/2,8	15	4,8
50.601.12	2	545x450x70	12	3,8/4,4	17	10,2

## Electric hob units

**New**

### Touch control glass ceramic hob unit

Glass ceramic cooktop, hi-light units, touch controls with 9 heating levels. Glass ceramic resistant to high temperatures. Residual heat indicators, fast and easy cleaning.

Heat up technology: after choosing the max heating level, you can set a second level the system will switch to after reaching the max heating power for a preset period of time. This function is ideal to heat up soups while reducing the current draw.

All hob units are fitted with touch controls and child restraint system. At the touch of a key, all settings are reliably locked thus preventing any misuse.

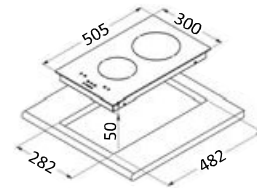

Code	No of burners	V	mm		Burners W	Ignition
			outside	recess		
50.707.82	2	220	505x300	482x282	1800 - 1200	Touch-control

### Ceramic induction hob unit

**INDUCTION**

High-efficiency system for its fast heating and optimized energy saving. Heat retention function. 4-mm thick ceramic top and fast installation with childproof lock.

Code	Burners	V	Hz	W	mm	
					outside	recess
50.707.91	2	220-240	50/60	3600	510x300	490x280
50.707.92	4	220-240	50/60	7200	510x600	490x560

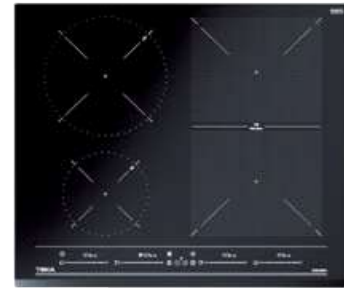

▲ 50.707.92

### Electric hob units

Made of glass ceramic with stainless steel frame, high quality parts, high speed hot plates, built-in thermal protectors, residual heat indicator light, virtually cool top on the cooker edge, 220V power.

Code	N° burners	Burner W	mm	Removable pan holders OPTIONAL
50.100.41	1	1200	300x300	50.100.42



**New**

### Universal removable pot holder set with flush base

50.707.00 The adjustable arms adapt to any type of pots and pans. Made of AISI316 stainless steel and PA6 nylon (V0 fire rating flame retardant plastic). Flush base to be installed on hobs or 2- to 42-mm thick kitchen tops.

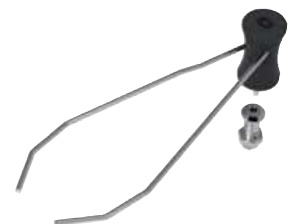
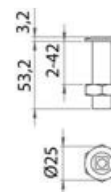

**OSCOLATI**



## Hobs and sinks fitted with worktop cover SMEV



## SMEV stainless steel sink with smoke tempered glass lid

Fitted with cold and hot water tap.

Code	Version	mm
50.800.50	Rectangular	420x370
50.800.60	Rectangular	420x440



50.803.41



Optional drain plugs

## SMEV/DOMETIC stainless steel hob with smoke tempered glass lid

Fitted with sink and chromed brass **folding tap (cold water)**.

Cramer version with piezoelectric safety ignition system, removable pan grids, stainless steel burners, rubber seal.

Code	Version	With sink	No of burners	Burners W	mm	
					outside	recess fit
50.803.41	CRAMER	RIGHT	2	1000+1600	600x445x146	590x435



50.530.00 OPTIONAL 90° drain

50.535.00 OPTIONAL Straight drain



50.535.00

50.530.00

## Drain outlets SMEV

Code	Type	Pipe Ø mm	Grating Ø mm	For sinks
50.535.00	Straight	25	47	50.800.50; 50.800.60; 50.803.60
50.530.00	90° angle	25	47	50.800.50; 50.800.60; 50.803.60

## Integrated crystal glass/stainless steel hob units

## Stainless steel hob unit with tinted glass cover

With self-locking black tempered tinted glass lid. Hidden hinges. Stainless steel grid with vibration-dumping rubber feet. High-efficiency burners. Manual starting. CE type-approval.

Code	No of burners	Burners W	mm			OPTIONAL pot holder
			outside	inside	recess	
50.801.00	1	1750	Ø 340	Ø 300	80	50.100.48
50.801.01	2	1000+1750	510x390	450x330	80	50.100.49
50.806.02	2	1000+1750	530x340	515x325	110	50.100.49
50.715.01	1	1750	352x322	342x310	119	50.100.91
50.715.02	2	1000+1800	530x326	505x305	119	50.100.92



50.801.01

50.801.00

50.806.02



50.715.01



50.715.02



50.100.49



50.100.91

**Sink with tinted glass lid**

Polished stainless steel, fitted with water tap. Optional drain.

Code	←→  mm			Water tap
	inside	outside	depth	
50.187.46	300	330	180	Cold, only
50.187.45	298x328	325x350	150	Cold, only
50.187.47	342x310	352x322	146	Cold, only

- 50.186.98 *OPTIONAL 90° drain plug*
- 50.186.99 *OPTIONAL straight drain plug*



**Cooktop with tinted tempered glass lid**

Fitted with sink and hot/cold water mixer.

Code	Sink	No of burners	Burners W	←→  mm			OPTIONAL pot holder
				outside	inside	recess depth	
50.805.04	Right	1	1750	530x340	515x325	150	50.100.48
50.805.05	Left	1	1750	530x340	515x325	150	50.100.48
50.805.06	Right	2	1000+1750	765x355	716x340	150	50.100.49
50.805.07	Left	2	1000+1750	765x355	716x340	150	50.100.49

- 50.186.98 *OPTIONAL 90° drain plug*
- 50.186.99 *OPTIONAL straight drain plug*

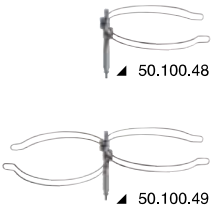

**Crystal glass worktop with hobs + Stainless Steel sink**

Code	No of burners	Burners W	←→  mm		Tap included	OPTIONAL pot holder
			external	recess		
50.100.68	2	2x1750	600x420X47 (overhang)	47 (overhang)	no	50.100.49

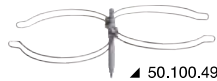

**Crystal glass worktop with hobs + Stainless Steel sink**

Code	No of burners	Burners W	←→  mm		Tap included	OPTIONAL Pot holder
			external	recess		
50.100.69	2	2x1750	600x420X47 (overhang)	47 (overhang)	No	50.100.92



## Sinks with fold-out hob

## Hinge stove folding into the sink

Made of **polished stainless steel**, fitted with folding tap, pot holder and tempered glass cover.



50.102.01

Code	Version	No. of burners	Burners W	mm		OPTIONAL pot holder
				outer	recess	
50.102.01	Round	1	1750	Ø 340 x 180	-	50.100.48
50.102.05	Rectangular	1	1750	320 (depth) x 350 x 180	-	50.100.48



50.186.xx OPTIONAL 70-mm Ø drain plug with grating



50.102.05



50.100.48

## DOMETIC Cookers with hobs/grill

## DOMETIC Slim compact gas range

Kitchen range. Fitted with pot holders and gimbals.  
Tempered glass front, internal light, thermostat, safety ignition, Stainless steel frame.



50.366.22

50.366.02

Code	Version	Burners	Grill	Oven	mm		kg
					with gimbals	without gimbals	
50.366.02	Sunlight	2 (2,2 + 1,8 kW)	No	1,1 kW	475x357x398 (h)	449x357x398 (h)	15,5
50.366.22	Starlight	2 (2,2 + 1,8 kW)	Yes (1,3 kW)	1,1 kW	475x357x540 (h)	449x357x508 (h)	18,5

## TECHIMPEX kitchens with oven

TECHIMPEX

## TECHIMPEX Classic version

Features: **two high power burner**; pot holder bars; side cardanic support; safety thermocouples; double front glass; thermostat; central oven burner for better heat distribution; double removable over tray, easy maintenance.

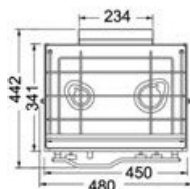

Code	Burners	overall size mm		
		Width	Depth	Height
50.375.00	2 of 1700/2300 W	450+30 for joint	442	442

## TECHIMPEX XL2/XL3 version

Features: pot holder bar; side cardanic support; safety thermocouples; thermostat; double front glass; large size hob unit suitable for household pots; central oven burner for better heat distribution; removable oven tray, easy maintenance; **large oven** (900 cm<sup>3</sup>).



50.385.00

50.385.02



Code	Burners	overall size mm		
		Width	Depth	Height
50.385.00	3 x 900/1700/2300 W	500+30 for cardan joint	484	460
50.385.02	2 x 1700/2300 W	500+30 for cardan joint	484	460

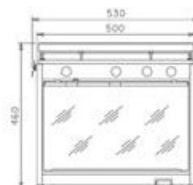
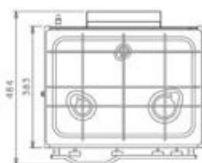



**TECHIMPEX Marinertwo version**

Features: **two high power burners**; pot holder bar; **adjustable** cardanic side support; safety thermocouples; **piezoelectric switching on system** powered by batteries; **mirror** front glass; grill; infinitesimal adjusting thermostat; large hob unit suitable for household pots; central over burner for better heat distribution; double removable oven tray, easy maintenance; large oven (900 cm<sup>2</sup>).

Code	Burners	overall size mm		
		Width	Depth	Height
50.370.00	2 of 1700/3000 W	500+30 for joint	475	460

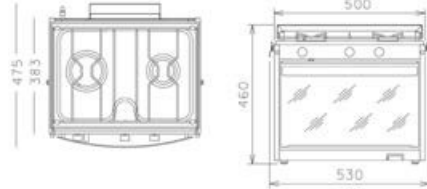

**Gas kitchen "Topline" series TECHIMPEX**

High quality product, professional performance; **features**: very sturdy stainless steel structure; solid stainless steel pot holder, adjustable by length and height; removable side flame trap, easy maintenance; cardan joint with adjustable patented system; piezoelectric switching on system powered by AA batteries.

Code	Type	N. burners	Burners W	Oven + Grill	kg
50.380.00	TOPTHREE	3	3000/1700/1000	1700 + 1600	27

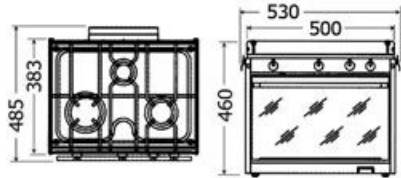

**TECHIMPEX Horizon electric kitchen with oven**

50.390.04 Mirror-polished stainless steel construction, **ceramic glass** top, fitted with cardanic joint and pot holder bar. Oven with grill and large drip pan. Version fitted with 4 burners (1200x2+1800x2) and 1500-watt oven, weight 25 kg. 220 V.

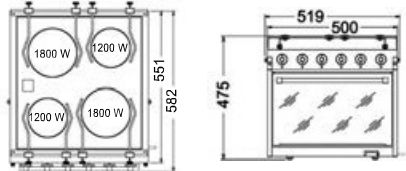

**Electric barbeques**

**Electric barbecue with pyroceramic top.**



Stainless steel body. Automatic ignition. Residual heat indicator. Connection cord with plug.

Code	V	Power W	external mm
50.381.02	220-240	2500	510x300

**Compact electric barbecue**

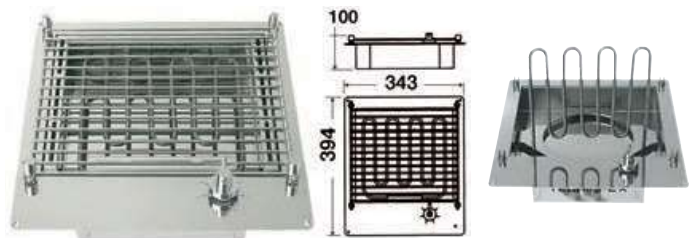

50.382.00 Made of AISI 316 stainless steel, fitted with removable drip tray, tilt electric resistant, removable grill, fixed with special anti-vibration hooks, energy consumption of 1.5 Kw at 220 V.

**New Satin-finish stainless steel electric barbecue**

Stainless steel surface. Black enamel cast iron grid. Overheat prevention circuit.

Code	V	Power W	mm	
			external	recess
50.709.09	220	2400	510x305	482x282

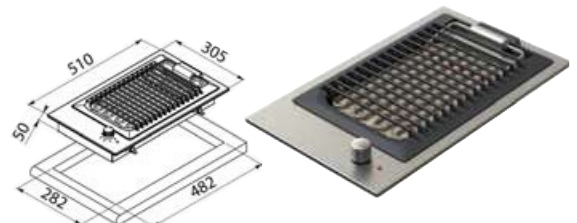



## Containers and accessories for gas systems

### Gas bottle housing



Made of **polyethylene** in accordance with RINA regulations, designed for mounting outside the cabin.

Code	Ø mm	Height mm
50.250.00	270	320

### Watertight gas bottle housing

**OSCULATI**



Made in compliance with the ISO 10239 standard, which requires for gas bottles inside boats to be stored in a well ventilated and insulated compartment connected to the outside. Made of **polyethylene**. It fits camping gaz bottles or similar types and has to be completed with kit 50.013.92. 8-mm gas fitting, 20-mm nylon vent.

Code	External Ø mm	Internal Ø mm	Height mm	Fixing OPTIONAL
50.251.00	270	200	348	50.251.05

### Plastic locker suitable for housing gas bottles (includes vent)

**OSCULATI**



For 3 kg bottles, fitted with respective pressure regulator. Product includes UV-resistant Luran hatch and watertight gas hose joint. In compliance with ISO 10239 standard. Remote ventilation by means of 16-mm Ø hose.

Code	front mm	Recess mm	Overhang mm
50.252.00	370x370	305x305	250

### Plastic locker suitable for housing gas bottles (includes built-in vent)

**OSCULATI**



For 3-kg bottles, fitted with respective pressure regulator. Fitted with UV resistant Luran hatch and watertight gas hose joint. In compliance with the ISO 10239 standard. Ventilation integrated into the hatch. Right opening as in the picture. Possibility of left opening for a minimum order of 5 units.

Code	front mm	Recess mm	Overhang mm
50.253.00	405x375	330x300	250

### Wall mounting system for bottles



50.251.05 Plastic holder and polypropylene adjustable strap. Suitable for wall mounting model 50.251.00

### Bottle holder



White soft PVC compartment suitable for 3-kg Camping Gaz bottles or similar. To be used as antiskid, shock absorber and to prevent the bottle from scraping the peak and staining it with rust.

Code	Ø mm
50.249.00	203



**OSCULATI**

### Original alcohol for ORIGO/DOMETIC kitchens

Alcohol specially suited for all Origo/Dometic kitchens and ovens, 99% pure, high calorie power with respect to normal alcohol, supplied in 1 litre container.

Code	Package I
50.202.00	1

## GOK accessories for gas installations

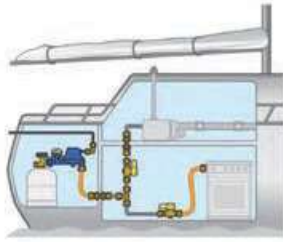

G 1/4 LH (Left-hand thread, cone)



RST 8 (Pipe socket)



RVS 8 (Compression fitting, right-hand)

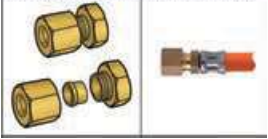

### Kit for remote "Campingaz" cylinders or similar

Code	Description
50.013.90	Includes: pressure regulator 30 mbar with tap to be screwed on the bottle; flexible hose 65 cm long, from the pressure regulator to the 8 mm copper pipe; low pressure tap to be mounted to the cooper pipe end; flexible hose 85 cm from the cooper pipe tap to cooker; fitted with 4 reinforced <b>brass</b> bushings, to be mounted on each pipe joint.



### Kit for remote standard gas cylinders 5/10/20 kg

Code	Description
50.013.91	Includes: tap to be screwed on the bottle; pressure regulator 30 mbar to be screwed on the tap; flexible hose 65 cm long from the pressure regulator to the 8 mm copper pipe; low pressure tap to be mounted to the cooper pipe end; flexible hose 85 cm from the cooper pipe tap to cooker; fitted with 4 reinforced brass bushings, to be mounted on each pipe joint.



### Kit for Campingaz bottles or similar, for mounting under the kitchen in a watertight container

Code	Description
50.013.92	Includes: 30-Mbar regulator fitted with tap to screw up onto the bottle + 65-cm hose going from the regulator to the container + 80-cm hose going from the container to the intercepting tap + 120-cm hose going from the tap to the gas cooker.



### G 1/4 LH x RST 8 tubes



1/4 threaded tubes (connection to 50.013.12) + 8-mm smooth tube (connection to cock 50.013.14).

Code	Length mm
50.013.25	600
50.013.26	800
50.013.27	1000

### RVS 8 X RST 8 tubes



Connection to M5 fittings or to 50.013.14 cock + female to be fastened on kitchen hose adapter (8-mm smooth hose adapter).

Code	Length mm
50.013.30	600
50.013.31	800
50.013.32	1000

### G 1/4 LH x G 1/4 LH tubes



Code	Length mm
50.013.51	600
50.013.52	800
50.013.53	1000

### G 1/4 LH x RVS 8 tubes



Code	Length mm
50.013.61	400
50.013.62	600

### RVS 8 x RVS 8 tubes



Code	Length mm
50.013.71	400
50.013.72	600

## Gas bottle cock



50.013.10 With overpressure safety device. M16x1.5 thread + shell.

## 30-Mb pressure regulator with monometer



50.013.12 Shell thread (connection to 50.013.10) + 1/4 (connection to 50.013.25/26/27).



▲ 50.013.41



▲ 50.013.40



▲ 50.013.44



▲ 50.013.43



▲ 50.013.42

## M5 fittings

8+8-mm femal fitting, DIN 8434-1.

Code	Type
50.013.40	Bulkhead
50.013.41	90° bulkhead
50.013.42	Tee
50.013.43	90° elbow
50.013.44	Straight

## Spare ogive for 8-mm copper tube fittings



50.013.97 To be replaced any time the tube is changed.  
5-pcs display blister.

## Brass nut for 8-mm copper tube, M14 x 1.5F pitch.



50.013.98 3-pcs display blister.

## Shut-off valve with fixing plate



50.013.14 DIN EN12514-2 - EN331, 8+8-mm female fitting (connection to tubes 50.013.25 and copper pipe).



## Gas leak detector

This device has to be installed near the gas bottle, downstream the pressure regulator. It detects possible gas leaks downstream the butane bottle.

Code	Model
50.013.16	Universal for RST8 copper pipes or rubber tubes

## Pots and kitchen accessories

## Toaster



Made of **stainless steel**. To be used on an onboard kitchen burner.

Code	base mm
50.819.00	136x113

## Waste container fitted with snap-in locking

OSCOLATI



50.420.01 Uses standard waste bags, the automatic locking system prevents bad odours leakages.

## Household appliances for pleasure boats

### DOMETIC air-recirculation cooker hood

Air-recirculation cooker hood with activated carbon air filter. Washable filter, 2-speed fan, 2 x 10W integrated halogen spotlights.



Code	V	Suction	Current draw	Lights	mm	kg	Spare activated carbon filter
50.236.13	12	38/45 m <sup>3</sup> /h	5 W	2x10 W	400x280x56 (H)	2.2	50.236.15

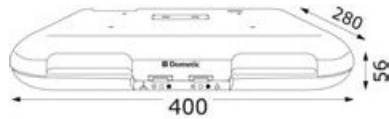

### WAECO Power-vac battery-operated portable vacuum cleaner

12V 2.6A battery-operated vacuum cleaner. 3.8-litre capacity, 18-minute (± 10%) uninterrupted operation. Cleaning power: approx. 400-mm water column (±10%).



Code	volt	Life	Recharge time	mm
50.848.00	12	18 (± 10%)	10/14 hours	298x171x175

### DOMETIC central vacuum cleaner

It can be flush mounted into the bulkhead. Suction power: 2500 mm (H<sub>2</sub>O column). The system includes: 12-m suction hose, brushes and crevice tool. Efficient and hypoallergenic triple filter.

Code	V	Power W	mm
50.851.01	220	950	298x171x175



## Water heaters and accessories

### Boat Boiler by ATI

Bivalent operation with heat exchanger or 1250W 230V electric resistance (110V for US market available on request).

Driven insulation between tank and polyurethane foam body to keep water hot for at least 123 hours.

Overdimensioned heat exchanger that provides real performance exceeding by far competitors' products yielding double capacity. Horizontal and vertical mounting. Safety valve calibrated at 4 bar, 8-bar testing pressure.

**Model A)** Fitted with porcelain glass boiler and aluminium external coat. Cathodic protection with magnesium anode. Enameled heat exchanger.

**Model B)** Fitted with AISI316 stainless steel boiler and mirror-polished inox-like aluminium external coat. Stainless steel heat exchanger. With front exhaust tap. Installation on three axes possible.

Version A	Version B SS	Model	Volume l	Shape	total with flange P mm	only boiler L2 mm	bracket centre distance L1 mm
50.290.51	-	Boat Boiler 20	20	Rectangular	190	420	457
50.289.49	50.389.50	Boat Boiler 22	22	Cylindrical	485	410	335
-	50.389.55	Boat Boiler 30	30	Cylindrical	619	544	470
50.289.52	50.389.52	Boat Boiler 45	45	Cylindrical	320	880	320

50.289.54 Spare anode, for all mode







▲ 50.198.58



### ISOTEMP INDEL WEBASTO MARINE boiler - SPA series

AISI 316 stainless steel internal tank and corrugated coil.  
Grey propylene external shell. 750 W 220 V **nickel-plated copper** electric resistance. Safety valve set at 6 bar. CFC-free polyurethane foam insulation. AISI 304 stainless steel fixing brackets. Thermostatic mixer 50.189.58 to be purchased separately.

Code	Type	Volume litre	↳  LxØ mm	Max pressure bar	W	kg
50.292.01	SPA15	15	450x310	6	750*	7.5
50.292.02	SPA20	20	550x310	6	750*	9
50.292.03	SPA25	25	650x310	6	750*	10
50.292.04	SPA30	30	535x390	6	750*	12
50.292.05	SPA40	40	640x390	6	750*	14
50.292.06	SPA50	50	745x392	6	750*	15
50.292.07	SPA60	60	850x392	6	750*	17

\* 1200 W resistance





### ISOTEMP INDEL WEBASTO MARINE boiler

**Stainless steel** internal tank, coil and external cover.  
The tank has a 5-year warranty against leaks. It works with a 750W 220V **nickel-plated copper** resistance or with a heat exchanger connected to the engine cooling system. The resistance is positioned on the lower part of the boiler to avoid heat stratification. Fitted with dual safety/service thermostat and 7-bar safety valve. Polyurethane foam insulation, horizontal or vertical installation.

Code	Volume l	↳  LxØ mm	Max pressure bar	Electric resistance W	kg
50.291.00	15	520x295	7	750	9
50.291.20	20	645x295	7	750	10.5
50.291.01	25	765x295	7	750	12
50.291.25	24	470x395	7	750	12.5
50.291.02	40	640x395	7	750	15.5
50.291.03	50	760x395	7	750	17
50.291.04	75	1050x395	7	750	24.5
50.290.00*	16	560x400x180	5	750	15.5

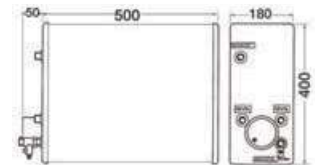
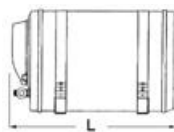
\* Thermostatic mixer not included.



▲ 50.290.00



### Thermostatic mixer for water heaters

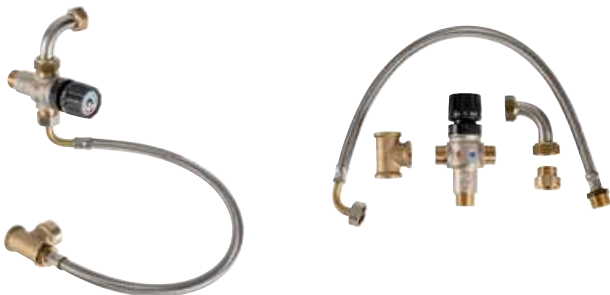

50.189.58 Designed to adjust the output temperature of hot water to avoid **high temperatures**, universal size fits all water heaters.

### Water heater joint hot water outlet pipe



50.289.56 Made with **stainless steel** metal braid, replaces PVC pipe that does not withstand high temperatures from the boiler water output, length 45 cm, standard size screw thread 1/2".

## Portable fridges

### Powerbox® Plus 28L portable electric cooler

Click-and-lock lid and folding handle. Antimicrobial liner to resist odours, mould and mildew. It keeps the content 20°C below the ambient temperature. For 1.5-l bottles. 12V/230V power supply.

Code	Volume l	↔ mm
50.171.32	28	410x310x470



### Power box Plus TE36L electric cooler

It keeps the content 20°C below the ambient temperature. Antimicrobial liner to resist odour, mould and mildew. 2-l bottles fit into it. 12V/230V power supply.

Code	Volume l	↔ mm
50.171.33	36	560x350x410



### Portable fridge/freezer with compressor

Fitted with a 12/24V noiseless airtight compressor. Electronic digital control panel for temperature setting from -18° to +10°. 45/55 W ± 10% current draw. ECO operating mode. Built-in foldable carrying handles. Ligther-type plug included.

Code	Usable volume l	↔ mm	kg
50.810.24	22	591x363x350	8,5



### ISOTHERM compact and portable built-in refrigerator/freezer

Compact and portable refrigerator/freezer with Secop BD Micro compressor. 12/24-volt supply. 35-watt consumption. Temperature adjustable by means of a thermostat. Made with stainless steel materials.

Code	Type	Volume l	↔ (HxLxP) mm	kg
50.832.28	TB18	18	405x235x565	8,6

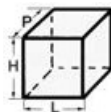

isotherm



### Travel box portable cool box

Portable fridge/freezer designed for indoor and outdoor use and to withstand shocks. Fitted with thermostat and completely made of stainless materials. 12/24V supply.

Code	Type	Volume l	Current draw* (W/24h)	↔ (HxLxP) mm	Secop compressor type	kg
50.832.32	TB 31 DC	30	220 - 740	380x585x350	BD35F	18
50.832.42	TB 41 DC	40	250 - 790	445x585x350	BD35F	21
50.831.07	TB 51 DC	50	240 - 770	530x585x350	BD35F	23

\* Energy consumption when operating at 12V, +5°C in the refrigerating compartment, +25°C room temperature

isotherm

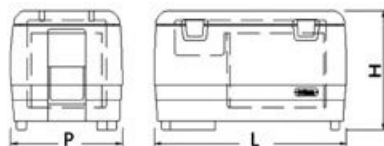

## IGLOO® iceboxes

IGLOO®



## IGLOO rigid icebox (up to 100 litres)

Made with UV-resistant, high-efficiency thermal insulation materials. Designed for onboard use. Ideal for food and fish conservation as well as live bait well. Anti-odour plastic lining. Sturdy frame you can sit on.

Code	Volume l	Model	Drain plug	UV protection	Ice retention days*	↔ cm	kg	OPTIONAL cushions	
50.558.33	New	23	MARINE ULTRA 25	No	Yes	3	52X27X33 H	3	-
50.558.16	New	28	MARINE ULTRA 30/3	No	Yes	3	43X27X44 H	3,6	-
50.558.05		34	MARINE ULTRA 36	No	Yes	3	60x34x33 H	3,6	-
50.558.50	New	47	PROFILE 50 QT	No	No	2	64x37x37,5	4,1	50.566.71
50.558.54		51	MARINE ULTRA 54	Yes	Yes	5	65X37X41 H	4,8	50.566.71
50.558.26	New	66	MARINE ULTRA 70	Yes	Yes	5	76x42x41 H	6,2	50.566.80
50.558.14		88	MARINE ULTRA 94	Yes	Yes	5	88x42x45 H	7,6	-
50.558.24	New	94	MARINE ULTRA 100	Yes	Yes	5	88x43x47 H	9,1	50.566.81

\* Days of ice retention at an external temperature of 32°C



## Spares for IGLOO ice makers

Made of rugged and UV-resistant material. Supplied with fixing screws, easy to install.



Code	Type	Couleur	↔ cm	Compatible with
50.559.01	Standard hinge	White	5,87x0,05x3,21	all models
50.559.02	Long lasting hinge	Black	5,87x0,45x3,21	all models
50.559.10	Standard lock	White	8,58x1,59x14,61	50.558.12; 50.558.14; 50.558.18; 50.558.30
50.559.11	Plastic/SS lock	-	-	50.558.54; 50.558.26; 50.558.24
50.559.15	Foldable handles	White	13,28x2,51x14,3	50.558.05
50.559.16	ULTRA handles	White	13,28x2,51x14,3	50.558.54; 50.558.26
50.559.17	ULTRA handles	White	13,28x2,51x14,3	50.558.24

**IGLOO rigid icebox (over 100 litres)**

Code	Volume l	Model	Drain plug	UV protection	Reinforced hinges	Lock	cm	kg	OPTIONAL cushions
50.558.25	113	MARINE CONTOUR 120	Yes	Yes	Yes	Plastic	98x44x45 H	8,4	50.566.90
50.558.18	114	POLAR 120	Yes	-	-	Plastic	98x44x45 H	12,7	50.566.92
50.558.29 <b>New</b>	142	MAXCOLD CONTOUR	Yes	Yes	Yes	Plastic	107x48x53H	11	50.566.95
50.558.30*	157	MAXCOLD CONTOUR 165	Yes	-	-	-	107x48x59H	14	-

\* Additional hatch for fast access + 4 glass holders



**IGLOO BMX icebox**

Code	Volume l	Model	Drain plug	UV Protection	Reinforced hinges	Lock	Ice retention days*	cm	kg
50.558.40	23	BMX 25	Yes	No	Yes	Rubber T lock	4	51x33,5x41,5 H	4,7
50.558.41	49	BMX 52	Yes	No	Yes	Rubber T lock	5	67x41,5x42 H	7,4

\* Days of ice retention at an external temperature of 32°C



**IGLOO iceboxes on wheels**

Code	Model	Capacity l	cm	kg
50.558.10	WHEELIE 38	36	58x33x40 H	4,3
50.558.12*	MARINE ULTRA GLIDE 110	104	101x47x50 H	11,5

\* Comfort lifting handle, stainless telescopic haulage handle



**IGLOO soft ice boxes**

Made of 600-denier polyester with durable TPE padding.

Code	Model	Type	Capacity l	Thermal grade / Marine Grade*	cm
50.556.09	COAST CLR 36 SDRFT WHT/GRY 2P DI	Semi-rigid	30	1	45x24x29

\* Ice retention days at 32°C external temperature.



**Universal spare part kit for IGLOO iceboxes**



50.559.00 It contains: 4 hinges, 2 locking hooks, 2 drain caps, 24 S.S. screws.

**Anchoring system for ice boxes**



50.156.11 Fitted with 4 angles and two elastic cables for mounting through the handles, universal size.

**Universal fixing system for iceboxes**



50.156.12 It includes 4 corner plates + 2 elastic cables with stainless steel rings.



## ISOTHERM Indel Webasto Marine fridge unit

For a complete group, you have to order one fridge unit + one evaporator



### Evaporator with quick coupling and thermostat to be connect to 50.932.00/02

Code	Type	Suitable for litres max		←→  mm	Matching compressor
		Fridge	Freezer (-12°)		
50.932.10	Plate accumulator	60	20	350x130	50.932.00
50.932.11	Plate accumulator	80	26	350x250	50.932.00
50.932.12	Plate accumulator	150	50	386x361	50.932.00
50.932.13	Plate accumulator	170	56	815x210	50.932.00; 50.932.02
50.932.14	Plate accumulator	260	86	1000x270	50.932.02
50.932.17	L-shaped	60	20	(250+110)x350	50.932.00
50.932.18	L-shaped	125	41	(400+170)x200	50.932.00
50.932.05	Evaporator box	125	41	240x210x85	50.932.00
50.932.06	Evaporator box	150	50	320x230x100	50.932.00
50.932.19	Evaporator box	200	66	380x270x140	50.932.00; 50.932.02
50.932.07	2L eutectic plate	100	40	300x210x60	50.932.00
50.932.08	3L eutectic plate	150	50	355x280x60	50.932.00; 50.932.02
50.932.15	Coated lamellar evaporator, with ball bearing fan and quick cooling	150	-	220x275x70	50.932.00



### ISOTHERM refrigerating unit by Indel Webasto Marine

Cooling unit with SECOP compressor and automatic electronic control that automatically switches off the unit when the battery voltage drops under 10.4 at 12V (22.8 at 24V). Fitted with quick couplings precharged with R134 eco-friendly gas. Evaporator to be purchased separately.

Code	Type	V	Consumption	←→  mm
50.932.00	BD 35 F	12/24	320/380 W / 24h *	280x160x175
50.932.02	BD 50 F Vent	12/24	400/600 W / 24h *	330x160x175

\* Temperature: external 25°C, inside the box 5°C

50.932.20 Smart Energy Control OPTIONAL



### ISOTHERM by Indel Webasto Marine Secop cooling unit with VE150 ventilated evaporator

The well-known SECOP cooling unit with voltage automatic control disconnects when voltage drops below 10.4 (22.8) V. DANF 0SS/Secop. The ventilated evaporator is fitted with white plastic casing, cools up to 150 l and is very compact.

Code	V	Consumption	←→  Condenser mm	←→  Evaporator mm
50.931.98	12/24	0,380 kW/24 h *	388x132x160	220x275x58

\* External temperature: 25°C; temperature in the box: 5°C.



### ISOTHERM ITC+ cooling unit with evaporator box

Kit including ventilated evaporator box and compressor whose combination reduces current draw by 25-30%. The ITC electronic systems makes the compressor work in Soft Start mode and manages the Fast Cooling and Over Cooling functions: when the boat engine is on, the ITC detects a current surplus and makes the compressor work at its maximum operation rate for faster cold storage; when the boat engine is off, the compressor works at minimum rate to ensure the minimum temperature setting.

Digital panel for temperature control.  
Battery protection with selection of 3 different levels.  
Air-cooled NIDEC (Secop) 12/24 V compressor.  
Click-On fastening system for compressor.

Code	Max volume		V	Compressor	Temperature range	←→  mm	
	Cooling unit	Freezer				Evaporator	Compressor
50.931.92	100	35	12/24	BD35F	+2° -6°	300x210x60	280x160x175
50.931.93	150	50	12/24	BD50F	+2° -6°	355x280x60	330x160x175
50.931.94	200	65	12/24	BD50F	+2° -6°	355x280x90	330x160x175

## Accessories for refrigerators

### INDEL WEBASTO MARINE ISOTHERM Smart Energy Control

By means of a sophisticated micro-processor, this device drastically reduces the energy consumption of fridges and refrigerating units. It continuously adjusts the compressor RPM and, by means of a special sensor, it detects the refrigerator air temperature thus cooling food a bit more than necessary when the boat engine is on or when the boat is connected to the dock. During navigation, it exploits the food surplus frigories to reduce the compressor operation with an energy saving of about 50%. This device can match any fridge or refrigerating unit fitted with SECOP 101N0212 electronic unit. The kit includes: panel with micro-processor, adjustable potentiometer, air sensor.

It doesn't match the CR42 fridge version.

Code	V input (AC)	mm
50.932.20	12/24	225x155x80



### Power Pack ISOTHERM 108W VAC 50/60HZ 24V for refrigerators

Optimized on the absorption curves of the Osculati compressors, this power pack supplies any DC 12/24V and AC 115/220V 50/60Hz refrigerators and Isotherm units.

High-power outlet up to 108W. Lightweight and compact in size, it can be used with several compressor models.

Compatible with any 12/24V Isotherm refrigerators fitted with a BD35 / BD50 / BDMICRO 1.4 compressor.

Code	V		Output power W	Output current A	mm
	input (AC)	output (DC)			
50.820.02	100-240	26,5	> 108	> 4,5	131x35x255



## ISOTHERM fridges



### DIVINO THE ONE electric glacette

Recess-fit cooling device for bottles. It keeps the wine or champagne perfectly refrigerated. Touch the stainless steel crown to activate it. Interactive LED lighting with 27 colour options. IP65 on the outer side, IP22 on the inner side.

Code	Capacity	V	Power W	Bore Ø mm	Ring Ø mm	Depth mm	Inner light
50.835.20	1 bottle	12	60	152	169	301	27 colour options



### ISOTHERM refrigerator with maintenance-free 42-l Secop hermetic compressor

Fitted with electronic control that turns off the fridge when the voltage goes under 10,4 volts and turns on again when voltage goes up to 11,7 volt (adjustable values respectively up to 9,6 and 10,9 volt). Rotation speed at 2000-2500-3000 RPM adjusted according to the volume to be cooled.

Forced ventilation. Compressor can be remote controlled.  
Current draw: 275 W/24h.



Code	Model	Volume l	V	Eutectic plate cool accumulation	Compartment	mm			kg	OPTIONAL finish frame	
						width	depth	height		Black	SS
50.830.04	CR42/V	42	12/24	No	Single	380	452/310	520	13,5	50.934.01	50.934.02
50.833.01	CR42EN	42	12/24	Yes	Single	380	475/310	530	17	50.934.01	50.934.02

### ISOTHERM refrigerator with maintenance-free 49-l Secop hermetic compressor

Fitted with electronic control that turns off the fridge when the voltage goes under 10,4 volts and that starts up again when voltage goes up to 11,7 volt (adjustable values respectively up to 9,6 and 10,9 volt).

2000-2500-3000 RPM rotation speed adjusted according to the cooling volume. Forced cooling.  
Current draw: 280 W/24h.



Code	Model	Volume l	V	Eutectic plate cool accumulation	Compartment	mm			kg	OPTIONAL finishing frame	
						width	depth*	height		Black	SS
50.935.00	CR49	49	12/24	No	Single	380	470	525	17	50.934.01	50.934.02
50.936.00	CR49EN **	49	12/24	Yes	Single	380	470	525	18	50.934.01	50.934.02

\* The depth cited excludes the door and handle (± 40 mm)

\*\* Cold accumulating system, reduced energy consumption



#### ISOTHERM refrigerator with maintenance-free 65-l Secop hermetic compressor

Fitted with electronic control that turns off the fridge when the voltage goes under 10,4 volts and that starts up again when voltage goes up to 11,7 volt (adjustable values respectively up to 9,6 and 10,9 volt).

2000-2500-3000 RPM rotation speed adjusted according to the cooling volume. Forced cooling. Current draw: 290 W/24h.

Code	Model	Volume l	V	Eutectic plate cool accumulation	Compartment	←→  mm			kg	OPTIONAL finishing frame	
						width	depth*	height		Black	SS
50.935.11	CR65	65	12/24	No	Single	450	500	530	18	-	50.934.03
50.936.11	CR65EN **	65	12/24	Yes	Single	450	500	530	19	-	50.934.03

\* The depth cited excludes the door and handle ( $\pm 40$  mm)

\*\* Cold accumulating system, reduced energy consumption



#### ISOTHERM refrigerator with maintenance-free 85-l Secop hermetic compressor

Fitted with electronic control that turns off the fridge when the voltage goes under 10,4 volts and that starts up again when voltage goes up to 11,7 volt (adjustable values respectively up to 9,6 and 10,9 volt).

2000-2500-3000 RPM rotation speed adjusted according to the cooling volume. Forced cooling. Current draw: 380 W/24h.

Code	Model	Volume l	V	Eutectic plate cool accumulation	Compartment	←→  mm			kg	OPTIONAL finishing frame	
						width	depth*	height		Black	SS
50.935.02	CR85	85	12/24	No	Single	475	515	625	23	50.934.04	-

\* The depth cited excludes the door and handle ( $\pm 40$  mm)



#### ISOTHERM refrigerator with maintenance-free 100-l Secop hermetic compressor

Fitted with electronic control that turns off the fridge when the voltage goes under 10,4 volts and that starts up again when voltage goes up to 11,7 volt (adjustable values respectively up to 9,6 and 10,9 volt).

2000-2500-3000 RPM rotation speed adjusted according to the cooling volume. Forced cooling. Current draw: 400 W/24h.

Code	Model	Volume l	V	Eutectic plate cool accumulation	Compartment	←→  mm			kg
						width	depth*	height	
50.935.12	CR100	100	12/24	No	Single	485	455	745	26

\* The depth cited excludes the door and handle ( $\pm 40$  mm)



#### ISOTHERM refrigerator with maintenance-free 130-l Secop hermetic compressor

Fitted with electronic control that turns off the fridge when the voltage goes under 10,4 volts and that starts up again when voltage goes up to 11,7 volt (adjustable values respectively up to 9,6 and 10,9 volt).

2000-2500-3000 RPM rotation speed adjusted according to the cooling volume. Forced cooling. Current draw: 440 W/24h.

Code	Model	Volume l	V	Eutectic plate cool accumulation	Compartment	←→  mm			kg	OPTIONAL black finishing frame
						width	depth*	height		
50.935.03	CR130	130	12/24	No	Single	525	510	745	27	50.934.06
50.936.03	CR130EN **	130	12/24	Yes	Single	525	510	745	28	50.934.06

\* Depth is door and handle excluded ( $\pm 40$  mm)

\*\* Cold storage system, reduced current draw



**ISOTHERM refrigerator with maintenance-free Secop hermetic compressor - double compartment**

Fitted with electronic control that turns off the fridge when the voltage goes under 10,4 volts and when starts up again goes up to 11,7 volt (adjustable values respectively up to 9,6 and 10,9 volt). Rotation speed of 2000-2500-3000 RPM adjusted according to the cooling volume.

Code	Model	Finish	Volume l	V	Current draw (W/24h) A	mm			kg
						width	depth	height	
50.837.01	CR90	Grey	70+20	12/24	550	478	430	845	28
50.838.05	CR225	Silver	225	12/24	650	566	491	1440	44
50.838.06	CR280	Silver	280	12/24	-	566	491	1700	50



**Classic trim frame for built-in mounting**

Code	Series	Version	For l	Inside dimensions (fixing) mm	Outside dimensions (look) mm	Sides
50.934.01	Classic	Black	42/49	380	422	3
50.934.02	Classic	Satin finish SS	42/49	380	422	3
50.934.03	Classic	Satin finish SS	65	450	492	3
50.934.04	Classic	Black	85	Height 625	Width 35	2
50.934.06	Classic	Black	130	526	564	3

**ISOTHERM Cruise Elegance refrigerator**

New range of products with front door and different technical characteristics in comparison with the standard line: door ventilation system built in the cover lid; easyfix system for installation from inside the cabinet; freezer compartment featuring a new design features such as steel door and high-power LED internal lighting. Fitted with safety closure.

Code	Model	Capacity l	V	Current draw (W/24h) A	mm			OPTIONAL silver finishing frame	
					L	P	H	3 sides	4th side
50.827.18	CR42E	42	12/24	265	380	452	525	50.934.10	50.934.21
50.827.20	CR49E	49	12/24	265	381	500	520	50.934.10	50.934.21
50.827.22	CR65E	65	12/24	275	448	530	527	50.934.11	-
50.827.24	CR85E	85	12/24	368	477	555	620	50.934.12	-
50.827.26	CR130E	130	12/24	418	528	555	746	50.934.13	-

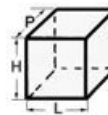

 Standard silver finishing for panel/door

 **50.932.20** OPTIONAL Smart Energy Control for energy absorption up to 25%



**Elegance series trim frame for flush mounting**

Code	Series	Version	For l	Inside dimensions (fixing) mm	Outside dimensions (look) mm	Sides
50.934.10	Elegance	Silver	42/49	380	422	3
50.934.11	Elegance	Silver	65	450	493	3
50.934.12	Elegance	Silver	85	476	541	3
50.934.13	Elegance	Silver	130	525	592	3
50.934.21	Elegance	Silver	49	322	424	4° (lower part)



**ISOTHERM refrigerator with stainless steel panel - clean touch**

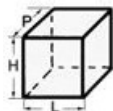

Fitted with flange for recess fit: the door is flush with the flange. Snap lock door, quite 12/24V SECOP compressor, inside LED light, Ready to fit smart energy control 50.932.20. Clean touch film, stainless steel panel freezer, improved insulation door and ergonomic handle.

Code	Model	Volume l	V	Current draw W/24h	←→  mm			kg
					L	P	H	
50.827.30*	CR42 SS CT	42	12/24	285	400	500/385	525	17
50.827.31	CR49 SS CT	49	12/24	265	400	500	525	18
50.827.32	CR65 SS CT	65	12/24	275	470	520	528	20
50.827.33	CR85 SS CT	85	12/24	368	495	550	625	24
50.827.34	CR130 SS CT	130	12/24	418	545	555	750	29

\* Compressor can be remote operated up to 1.5 m. In this case depth is 385 mm.

Dimensions of the refrigerator do not include the mounting flange.



▲ 50.827.30/31



▲ 50.827.32



▲ 50.827.33



▲ 50.827.34



▲ 50.827.05



▲ 50.827.05

**ISOTHERM refrigerator with stainless steel front panel - double compartment**

Complete with a flush-mount stainless steel flange, it allows installation of the door with a flush appearance. Closure by means of a flush snap lock.

CR220 model: 130-l front door upper unit + 90-l front door lower freezer unit. CR260 model: 130-l front door hybrid upper unit + 130-l drawer unit (with 9.8-l freezer compartment).

Code	Model	Volume l		V	Current draw A	←→  mm			kg
		refrigerator	freezer			L	P	H	
50.827.05**	CR195 SS	130	65	12/24	2.3/6.2	545	580	1345	63
50.827.07**	CR200 SS*	150	50	12/24	2.3/6	735	620	880	53
50.827.16	CR220 SS	130	90	12/24	2/4	545	565	1538	69
50.827.15	CR260 SS	130+130	-	12/24	2/4	545	565	1538	74

\*\* Refrigerator with freezer.

\* Complete with AC-DC 115/230 kit



▲ 50.827.07



▲ 50.827.15



▲ 50.827.16

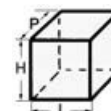

**Isotherm fridges with removable drawer**

Fitted with 12/24V universal voltage Secop compressor.  
The clean touch models feature an anti-fingerprint finish.

Code	Model	Capacity l	V	Consumption A-h	←→  LxDxH mm	OPTIONAL SS finishing frame on 4th side
50.826.00*	CR36	36	12/24	0.6-2.7	440x675x250	-
50.827.00	CR36 inox	36	12/24	0.6-2.7	440x715x255	-
50.826.29	DR42	42	12/24	-	400x525x500	50.934.27
50.826.30	DR49 inox CT	49	12/24	-	400x502x520	50.934.27
50.826.31	DR65 inox CT	65	12/24	-	470x526x525	50.934.28
50.826.17**	DR70 inox	70	12/24	0.55-3.5	627x724x444	-
50.826.07	DR85 inox	85	12/24	1-4	494x544x619	50.934.24
50.826.01	DR105 inox	105	12/24	1.2-5	520x590x520	-
50.826.08	DR130 inox	130	12/24	2-5	544x557x744	50.934.31 <b>New</b>

\* White door

\*\* With remote compressor P=580



**ISOTHERM Drawer stainless steel refrigerator/freezer**

Series of refrigerator/freezer appliances with stainless steel front opening drawer and stop. With Secop compressor (12/24 V universal voltage).

Code	Model	Description	Power V	Capacity l	←→  cabinet LxDxH mm	OPTIONAL SS finishing frame on 4th side
50.826.06	DR55 SS Freezer	Drawer freezer, 55-l volume, automatic defrosting	12/24	55	470x520x540	50.934.23
50.826.18	DR70 SS Freezer	Drawer freezer, 70-l volume	12/24	70	611x724x444	-
50.826.19*	DR70 SS Freezer/ice maker	Drawer freezer, ice maker included, 70-l volume	12/24	70	611x786x444	-
50.826.32	DR100 SS fridge	Drawer fridge, 100-l volume	12/24	100	546x778x501	50.934.30
50.826.11	DR160 SS fridge/fridge	Double-drawer ventilated fridge (95 + 65 l), light in the upper drawer, mechanical thermostat. BD50 compressor.	12/24	95+65	625x545x865	50.934.25
50.826.12	DR160 SS fridge/freezer	Fridge (95 l, upper drawer), freezer (65 l, lower drawer). Mechanical thermostat. Light in the upper drawer. BD80F compressor.	12/24	95+65	625x545x865	50.934.25

\* Available upon request



**ISOTHERM Cruise 90 Classic and Cruise 90 Inox freezer**

Extra-thick insulation for excellent cooling performance and low current draw.  
Fitted with built-in compressor.  
Current draw: 550 W/24h.

Code	Model	Description	Flow l	V	↳  LxPxH mm
50.839.00	CR90 Freezer classic	Door with safety lock and magnetic rubber seal	90	12/24	527x520x746
50.827.23	CR90-F-CT	SS front panel with touch finish. Fitted with recess fit SS fastening flange and door flush with the flange. Flush snap lock.	90	12/24	545x565x750



50.839.00



50.839.00



50.827.23



50.827.23

**ISOTHERM 130-I refrigerator with stainless steel front panel**

Fitted with a flush-mount stainless steel flange, it allows installation of the door with a flush appearance. Flush snap lock.

Code	Model	Volume l	V	Current draw A	↳  mm		
					L	P	H
50.827.14	CR130 DRINK SS	130	12/24	1,4/5,2	545	545	755

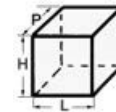
**ISOTHERM drawer refrigerator**

Fitted with stainless steel rails and black or silver painted stainless steel door.  
Elegance line and user-friendly digital display.  
Silent and high-efficiency BD 12/24V 1.4F Secop compressor.  
Easy Fix system.

Code	Model	Volume l	V	Current draw W/24 hours	↳  mm	Colour	OPTIONAL frame for external mounting
50.826.09	DR16	16	12/24	160	250x380x540	Silver	50.934.26
50.826.14	DR30	30	12/24	270	260x440x700	Silver	50.826.24
50.826.15	DR30	30	12/24	270	260x440x700	Black	50.826.25
50.826.16	DR30	30	12/24	270	260x440x700	White	-



50.826.09



50.826.14



50.826.15



50.826.16



50.826.14



50.826.24



50.826.25

**Drawer series recess-fit finish frame**

Code	Series	Version	For l	Inside dimensions (fixing) mm	Outside dimensions (look) mm	Sides
50.934.23	Drawer	Satin-finish SS	55	456	508	4° (lower part)
50.934.24	Drawer	Satin-finish SS	85	481	530	4° (lower part)
50.934.25	Drawer	Satin-finish SS	160	614	664	4° (lower part)
50.934.26	Drawer	Satin-finish SS	16	386	444	4 sides
50.934.27	Drawer	SS CT	49	384	438	4° (lower part)
50.934.28	Drawer	SS CT	65	452	508	4° (lower part)

**ISOTHERM top-loading cooling box by Indel Webasto**

Small size and high-performing, access from top lid.  
Fitted with SECOP last-generation compressor.

Code	Model	Lid	Thermosts	Capacity l	V	mm	kg
50.835.00	BI16	Opens with hinge	Digital	16	12/24	384x240x557	11.9
50.835.05	BI30	Opens with hinge	Digital	30	12/24	449x724x240	18
50.835.10*	BI36	Removable	Mechanical	35.5	12/24	438x556 + 125x240	15.3

\* 130-mm compressor (remote operation possible)



**Fridge/freezer Isotherm model BI29**

Fully removable, fitted with roller slides. Single lid for access from the top.  
Stainless steel inner lining and plastic bottom. +10°/-12° C temperature.

Code	Model	Volume l	V	Consumption W/24h	mm	kg
50.826.02	BI29	29	12/24	175	650x342x365	18



**ISOTHERM - "Cruise 40 Cubic" 40-l cockpit refrigerator/freezer**

Very versatile product that can be used as refrigerator and freezer. It can be installed for front or top opening. The SECOP compressor can be radio remote controlled up to 1.3-m distance. White door that can be covered with a panel, coating to be varied according to the customer's needs.

Code	Power V	With front door		With top door		kg
		Consumption A	Adjustable temperature range	Consumption (W/24h)	Adjustable temperature range	
50.039.00	12/24	0,186 Kwh/24 h	+10° / -12°	186	+10° / -18°	17.6

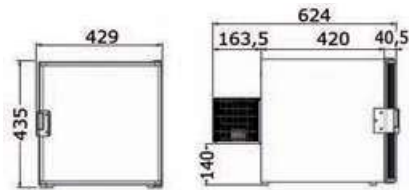

**ISOTHERM cockpit refrigerator/freezer**

Fitted with plastic bottom, internal removable baskets, Secop compressor with 12/24 volt universal voltage.

Code	Type	Volume l	Version		Consumption W/24 h	Internal coating inox	Housing mm HxPxL
			refrigerator	freezer			
50.040.00	BI40	40	x		270	no	405x420x400+160*
50.041.00*	BI41	41	x	x	222	no	342x451+161x500
50.042.00**	BI75	75	x		340	yes	430x470+160*x650
50.043.00**	BI92	95	x	x	360	yes	485x455+160*x805

\* Remote controlled compressor up to 0.90 meters - Sizes reduced by 161 mm.

\*\* Furniture with bevelled lower part for better hull adhesion.

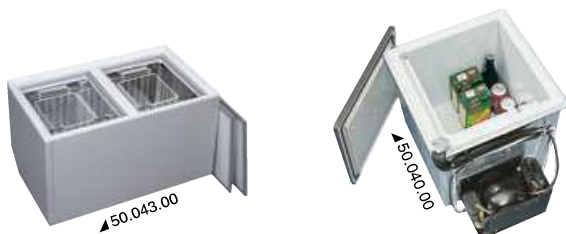



## DOMETIC refrigerators



New

## DOMETIC refrigerator

Innovative design and high energetic efficiency for a 3-in-1 cooling solution: refrigerator only, freezer only, or both. The NRX compressor refrigerators are ingenious artists: their trick is no secret, but a patented Dometic invention. The freezer compartment can be easily pulled out to make room for a larger refrigeration. The NRX refrigerators have superior energy efficiency.

Powerful, high-efficiency compressors and high-quality panels to improve isolation e minimize energy transmission losses.

- Well-equipped interior: freezer, shelves, bottle holder, door tray, crispers;
- Touch control panel with integrated LED light bar;
- Reversible door hinge;
- Full-width door handle neatly integrated for easy access;
- Smart closing mechanism to create a gap between the fridge and the door to airing out;
- Energy-efficient, light, compact compressor with 3 operating modes (Eco/Boost/Silent);
- Compressor can be remote-controlled in the 35-litre version to reduce depth to minimum;
- Standard or flush-mount installation frame.

Code	Model	Capacity l	Door panel	V	Average current draw W	↳ ↔  LxDxH mm	Ⓚ kg
50.914.01	NRX0035C	34	Dark silver	12/24	0,2296	380x355x525	16
50.914.03	NRX0050C	46	Dark silver	12/24	0,2222	380x510x525	17
50.914.05	NRX0060C	58	Dark silver	12/24	0,2335	448x537x525	17
50.914.07	NRX0080C	78	Dark silver	12/24	0,3036	475x537x625	20
50.914.09	NRX0115C	116	Dark silver	12/24	0,3671	525x568x745	25
50.914.11	NRX0130C	130	Dark silver	12/24	0,3729	525x568x812	26
50.915.01	NRX0035S	34	SS	12/24	0,2296	380x355x525	16
50.915.03	NRX0050S	46	SS	12/24	0,2222	380x510x525	17
50.915.05	NRX0060S	58	SS	12/24	0,2335	448x537x525	17
50.915.07	NRX0080S	78	SS	12/24	0,3036	475x537x625	20
50.915.09	NRX0115S	116	SS	12/24	0,3671	525x568x745	25
50.915.11	NRX0130S	130	SS	12/24	0,3729	525x568x812	26



◀ 50.914.xx



◀ 50.915.xx



◀ 50.914.xx



◀ 50.915.xx



New

## Frame for DOMETIC refrigerators

Code	Type	Refrigerator model
50.907.03	Flush-mounted/standard	NRX 35/50 dark silver
50.907.05	Flush-mounted/standard	NRX 60 dark silver
50.907.07	Flush-mounted/standard	NRX 80 dark silver
50.907.09	Flush-mounted/standard	NRX 115 dark silver
50.907.11	Flush-mounted/standard	NRX 130 dark silver
50.908.03	Flush-mounted/standard	NRX 35/50 SS
50.908.05	Flush-mounted/standard	NRX 60 SS
50.908.07	Flush-mounted/standard	NRX 80 SS
50.908.09	Flush-mounted/standard	NRX 115 SS
50.908.11	Flush-mounted/standard	NRX 130 SS



◀ 50.907.xx



◀ 50.908.xx

## CoolPower

CoolPower MPS 35 is a mains adapter for connection of 12-/24V cooling appliances to 110-240V mains systems. 24V output voltage. Suitable for all DOMETIC cooling appliances with SECOP BD35F compressor. Ideal for permanent installation. 230V priority circuit.

Code	Power w/Ah	↳ ↔  mm (LxHxP)
50.820.00	75/3	115x55x160

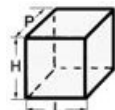

**DOMETIC drawer fridge**

12/24V compressor drawer fridge. The cooling unit can be fitted up to 1.5 m away in case of limited depth. Stainless steel front.

Code	V	Volume l	Temperature range	W	←→  mm		←→  depth mm	
					width	height	with compressor	without compressor
50.913.20	12/24	20	0° + 15°	36	438	250	565	422
50.913.30	12/24	30	-2° + 12°	36	440	250	730	560

 **50.913.40** Stainless steel frame for mounting of the 20- and 30-l version.



**Compressor wine cooler, bi-zone**

Bi-zone cooler for bottles. It keeps wine or champagne perfectly cooled. Convenient control panel, elegant internal light, removable and sliding wooden shelves. Active carbon filters with automatic humidity control. Low maintenance, automatic defrosting, condensate evaporation. Reversible door. Adjustable height (820-890 mm).

Code	Volume	V	←→  mm	
50.920.18	18 bottles	220	820x575x295	30



**OSCULATI refrigerators**



**New** Frigo° refrigerator

Compact and versatile refrigerators. Easy to install on any boat or vehicle. Convenient freezing compartment that can be pulled out if you don't need to increase the refrigerating capacity. Internal control panel to adjust the temperature. Fitted with Huayi compressor.



Code	Volume l	V	←→  mm				OPTIONAL frame
			width	depth	height		
50.960.00	50	12/24	380	490	530	17	50.960.30
50.960.02	85	12/24	475	545	630	21	50.960.32

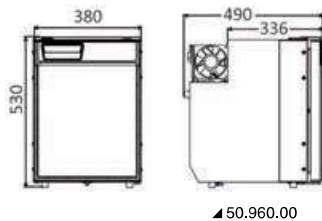

▲ 50.960.00

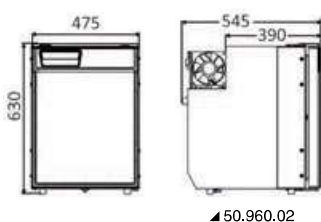

▲ 50.960.02



Ice-makers

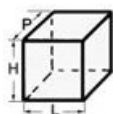

**Indel Webasto Marine ISOTHERM Ice Drink Clear ice maker**

100% stainless steel body, 18 kg/day max ice production, spray technology delivering clear ice.

Code	V	Current draw A-h	HxLxD mm	kg
50.840.00	220V (110V available upon request)	1.4	582x353x405	28

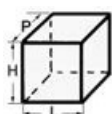

**IceDrink Clear WT ice maker with built-in tank ISOTHERM by Indel Webasto Marine**

100% stainless steel body, 18 kg/day ice production, spray technology delivering clear ice.

Version with 3-l built-in tank. The external dimensions are **exactly the same** of the model with an external water kit.  
External finish flange on 3 sides, available as an option.

Code	V	Current draw A-h	H x L x D mm	kg
50.840.10	220V (110V available upon request)	1.4	590x355x404	26

50.934.29 *Stainless flange on 3 sides.*

▲ 50.840.10

**ISOTHERM White Ice stainless steel ice maker by Indel Webasto Marine**

100% stainless steel, 8 kg/day ice production. Unique design and possibility of partial flush mounting with a complete frame or on 3 sides (lower flange to be bought separately). Ideal for applications at elevated external temperatures since the unique ventilation system pulls air in through the front, 180W power consumption and variable dimensions depending on the use of flanges. It is recommended to leave a 5-mm space on the ice maker rear part for water draining and relating connections. Weight: 29 kg.



Code	Version	H x L x D mm		V
		with flange	without flange	
50.840.04	Connection to the water system	640*410x436	629x375x428	220
50.840.06	<b>New</b> Built-in 8-l jerrycan	634x409x502	628x359x495	220

\* With lower flange upon request height is 661 mm.

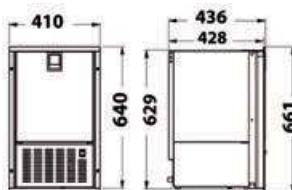

▲ 50.840.06



**ISOTHERM Low Profile White Ice maker by Indel Webasto Marine**

Having the same characteristics of the White Ice model, the Low Profile version is very flexible in terms of installation. The rear motor unit allows for installation in a location with lower height dimensions such as in external cockpits.

The elegant and practical stainless steel frame is ideal for any boat, even small ones. 8 kg/day ice production, 180W absorption. It is recommended to leave a 5-mm space on the ice maker rear part for water draining and relating connections. Weight: 29.5 kg.

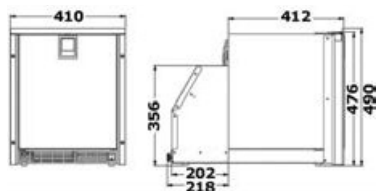

Code	H x L x D mm		V*
	with flange	without flange	
50.841.00	490x410x630	476x372x630	220

\* 110V upon request.

# WC, toilet and accessories

## Manual toilet unit



Very sturdy, low modern line; can be installed above or below the water level line, fitted with 19-mm (3/4") inlet and 38-mm (1" 1/2) outlet pipe.

The pump can be mounted on the right or on the left. **With pump removable from the top.**

**Spray Nozzle** washing fitting for faster and more effective cleaning at very high pressure on all the toilet bowl surface.

Code	Bowl	Board	Model	←→  mm			kg
				height	width	depth	
50.207.50	white porcelain	white lacquered wood	Space saver	305	450	425	10
50.217.30	white porcelain	soft close plastic	Space saver	285	450	425	10
50.207.25	white porcelain	white lacquered wood	Compact	345	450	425	10.5
50.217.25	white porcelain	soft close plastic	Compact	340	450	425	10.5
50.206.25	white porcelain	big soft close plastic	Grande	340	470	490	10.5

**50.207.41** Complete spare pump (new type with opening from the top "YEAR 2000")

**50.207.19** Seal spare kit



## Spare parts and accessories for manual toilets

Code	Description
50.207.50	Space Saver manual WC, wooden board
50.217.30	Space Saver manual WC, soft close plastic board
50.207.25	Compact manual WC, wooden board
50.217.25	Compact manual WC, soft close plastic board
50.207.50	Space Saver manual WC, wooden board
50.206.25	Big bowl manual WC

Number	Description	Code
1	Standard bowl white lacquered wood WC board for 50.207.25; 50.207.50; 50.217.25; 50.217.30	50.207.28
1	Standard soft close plastic WC board for 50.207.25; 50.207.50; 50.217.25; 50.217.30	50.207.51
1	Large soft close plastic WC board for 50.206.25	50.207.52
3	Spare pump with base gasket	50.207.42
4	Gasket kit mod, 2000	50.207.19
4A	Gasket kit up to 1999	50.207.26
5	Inlet nozzle kit, 90° joint	50.207.43
8	Spare pump with base	50.207.41
9	Compact spare bowl 50.207.25; 50.217.25	50.207.36
9	Space Saver spare bowl for 50.207.50; 50.217.30	50.207.37
9	Large spare WC bowl for 50.206.25	50.207.44
14	Hinge kit for toilet board	50.207.49

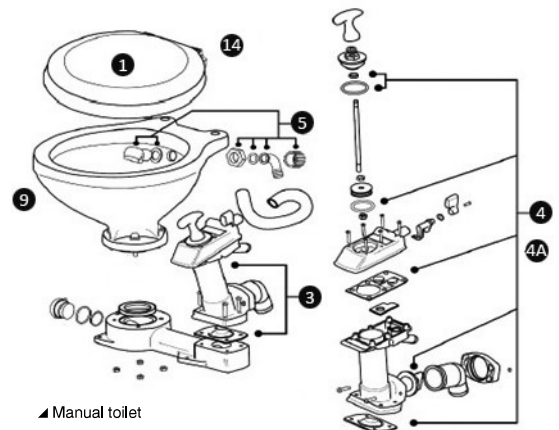





### RM69 ultra-lightweight manual toilet

Made of ABS, very compact and lightweight.

The pump can be mounted on the right or on the left.

20-mm inlet tube and 38-mm outlet tube.

Bayonet-mount of the bowl on the base, easy disassembling for cleaning purposes.

Code	Bowl	Board	←→  mm			kg
			height	width	depth	
50.207.48	ABS	ABS	350	440	420	3.2







### JABSCO manual toilet

Vitreous china bowl, wooden seat.

Pump with lock/unlock system against syphonic flooding, 3/4" (19 mm) inlet hose, 1" 1/2 (38 mm) outlet hose.

Code	←→  mm	kg
50.224.00	450x410x340 (H)	9.3

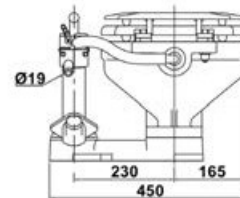
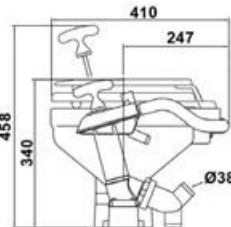
-  50.224.03 Service kit with valve
-  50.224.04 Complete pump assembly
- 50.207.28 Wooden board





### THETFORD Porta Potti portable toilet

Portable toilet that doesn't have to be connected to a drainage or water system.

Revolutionary design, optimum quality and functionality.

The toilet consists of two sections: the upper section is a combined flush-water tank and toilet bowl, the lower section is the waste-holding tank.

White and grey.

Code	Model	Upper tank		Outer dimensions AxLxP mm	kg	Deck planking fixing kit (option)
		Litres	Litres			
50.217.05	Porta Potti Qube 145	15	12	330x383x427	3,6	-
50.217.06	Porta Potti Qube 165	15	21	414x383x427	3,9	50.217.50



Rear

Front

50.217.50

**Manual-to-electric toilet conversion kit**

To be used on JABSCO toilets 50.224.00 + old models and on Osculati, Matromarine, Jhonson pump, Ocean Technologies toilets and other brands such as 50.206.25; 50.207.25/27/50 and 50.217.25/30.

Complete support that replaces the manual pump. Inlet/outlet pipes shall not be replaced. Operation under and above the waterline.

Code	V	Flow l/min	Fuse	↔ mm
50.225.32*	12	18,9	20 A	260x90x150

\* With levelling seal for the different WC bowl types

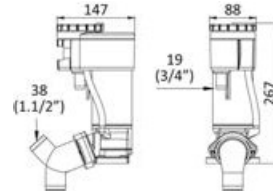

**JABSCO electric toilet conversion kit 50.224.00**

It directly replaces the manual pump assembly. Inlet/outlet hoses remain the same. For use above or below waterline.

Code	V	Fuse	↔ mm
50.225.32	12	25 A	270x90x150

**50.225.30** Service kit with impeller, seal and O rings.

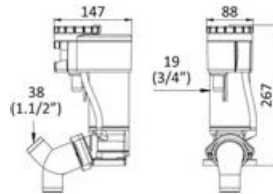

**Toilet conversion kit, from manual to electric operation**

For manual toilet units models 50.206.25, 50.207.25/27, 50.217.25/30, 50.207.50.

The kit includes: base, pump and electric motor compatible with toilet units by JABSCO, SPX, RARITAN, GROCO.

12 V	24 V	Version
50.209.12*	50.209.24*	Classic with rubber suction impeller
50.209.13**	50.209.25**	Evolution using the mechanical parts of toilet units 50.245.12; 50.246.12/24

\* **50.209.90** Spares impeller and seal kit  
 \*\* **50.207.14** Impeller, seals and valves kit



**Kit for converting manual or electric toilet units SILENT type**

For converting traditional manual or electric toilet units (50.205../50.206.. / 50.207.. / 50.211.. / 50.217.. / JABSCO / RARITAN / RN69 / etc..) in vacuum toilet units.

**the kit includes:** the base pump unit and the electric control panel, as all vacuum toilet units, self-priming pumps 16.193.12-24 and any electro-valves 50.203.10-11 are sold separately.

12 volt	24 volt	Self priming pump OPTIONAL	electro-valve OPTIONAL
50.212.12	50.212.24	16.193.12; 16.193.24	50.203.10; 50.203.11



## Electric toilet unit

OSCOLATI

Fitted with **bronze** self-priming pump and neoprene rotor. Push-button operated, permanent-magnet motor and **stainless steel** shaft, built-in macerator. White seat and cover, 19-mm (3/4") inlet pipe and 25-mm (1") outlet pipe. Control panel INCLUDED. **Spray Nozzle** washing fitting for faster and more effective cleaning at very high pressure on all the toilet bowl surface.

Code	Bowl	Board	Model	volt	ampere	mm			kg
						height	width	depth	
50.207.13	white porcelain	Soft close plastic	space saver	12	15	340	345	420	14
50.205.13	white porcelain	White lacquered wood	space saver	12	15	340	345	420	14
50.207.12	white porcelain	Soft close plastic	compact	12	15	370	345	420	14,5
50.207.24	white porcelain	Soft close plastic	compact	24	7,5	370	345	420	14,5
50.205.12	white porcelain	White lacquered wood	compact	12	15	370	345	420	14,5
50.205.24	white porcelain	White lacquered wood	compact	24	7,5	370	345	420	14,5
50.206.12	white porcelain	Big soft close plastic	big	12	15	385	365	490	14,5
50.206.24	white porcelain	Big soft close plastic	big	24	7,5	385	365	490	14,5

 50.207.23 Gasket kit for electric toilet unit.

50.204.44 Electric control panel



OSCOLATI



## Evolution electric toilet unit

## LOW NOISE

Fitted with special self-priming pump reducing by 80% the typical noise of electric toilets.

Permanent magnet motor, built-in macerator.

19-mm (3/4") inlet hose, 25/38-mm (1"-1/2") outlet hose. Control panel included. White ceramic bowl, technopolymer Soft Close seat, 360° adjustable drain fitting.

Code	V	A	Model	mm		
				Height	Width	Depth
50.245.12	12	15	Space Saver	335	330	420
50.246.12	12	15	Compact	385	330	420
50.246.24	24	8	Compact	385	330	420



50.207.14 Impeller, seals and valves kit

## JABSCO electric toilet

White vitreous china bowl, wooden seat. Push button switch included. 19-mm inlet hose, 25-mm outlet hose. Self-priming pump up to 1.2 m. It can be installed up to 90 cm below the waterline.

JABSCO



Code	volt	Fuse	mm		kg
			Height	Width	
50.225.12	12	25A	350	430x350 (H)	15,4
50.225.24	24	15A	350	430x350 (H)	15,4



50.225.00 Service kit with impeller, seals and O rings.

50.207.28 Wooden board

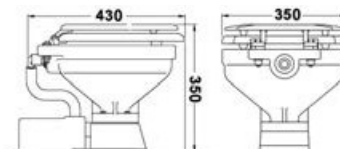

**Spare parts and accessories for STANDARD and EVOLUTION electric toilets**

Code	Description
50.207.13	Space Saver 12V electric toilet, soft close plastic board
50.205.13	Space Saver 12V electric toilet, wooden board
50.207.12/24	Compact 12V/24V electric toilet, soft close plastic board
50.205.12/24	Compact 12V/24V electric toilet, wooden board
50.206.12/24	12V/24V electric toilet, big bowl, soft close plastic board
50.245.12	Evolution Space Saver 12V electric toilet
50.246.12/24	Evolution Compact 12V/24V electric toilet

Number	Description	Code
1	White lacquered wood WC board, standard bowl for 50.205.12/24; 50.207.12/24; 50.205.13; 50.245.12; 50.246.12/24	50.207.28
1	Large soft close plastic WC board for 50.206.12/24	50.207.52
1	Standard soft close plastic WC board for 50.205.12/24; 50.207.12/24; 50.207.13; 50.245.12; 50.246.12/24	50.207.51
2	Base + gasket 50.245.12; 50.246.12/24	50.209.81
3	12V motor unit 50.246.12; 50.245.12	50.209.91
3	24V motor unit 50.246.24	50.209.92
2+9+10	Kit including: base + gasket + straight discharge fitting + check valve for 50.205.12/24; 50.206.12/24; 50.207.12/24; 50.205.13; 50.207.13	50.209.82
3+4+6+7+8	Spare 12V pump kit 50.205.12; 50.206.12; 50.207.12; 50.205.13; 50.207.13	50.209.62
3+4+6+7+8	Spare 24V pump kit 50.205.24; 50.206.24; 50.207.24	50.209.63
4	Hose connector + ring nut discharge kit 50.245.12; 50.246.12/24	50.209.17
5	Water inlet kit straight connection	50.207.16
5A	Water inlet kit 90° connection	50.207.43
6	Inlet pump complete kit 50.246.12/24; 50.245.12	50.209.66
7	Gasket and impeller kit 50.205.12/24; 50.206.12/24; 50.207.12/24; 50.205.13; 50.207.13	50.207.23
7A	Gasket kit for 50.246.12/24; 50.245.12	50.207.14
8	Water inlet impeller	16.193.73
9+10	90° elbow discharge fitting + check valve for 50.205.12/24; 50.206.12/24 50.207.12/24; 50.205.13	50.209.15
9+10	Straight discharge fitting + check valve 50.205.12/24; 50.206.12/24 50.207.12/24; 50.205.13	50.209.14
11	Spare Compact ceramic bowl for 50.205.12/24; 50.207.12/24; 50.245.12	50.207.36
11	Spare large ceramic bowl for 50.206.12/24	50.207.44
11	Spare Space Saver ceramic bowl for 50.205.13; 50.207.13; 50.245.12	50.207.37
14	Hinge kit for WC board	50.207.49
15	Switch panel	50.204.44

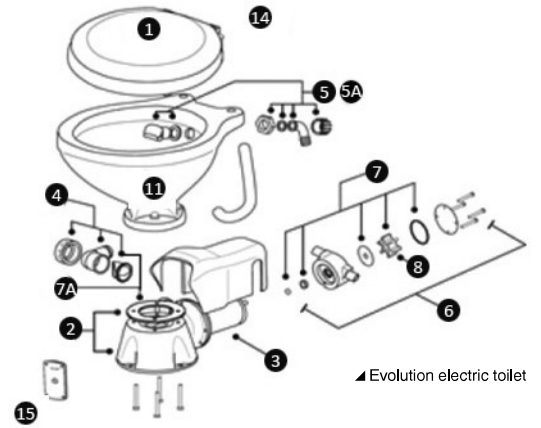

▲ Evolution electric toilet



▲ 1



▲ 7



▲ 7A



▲ 8

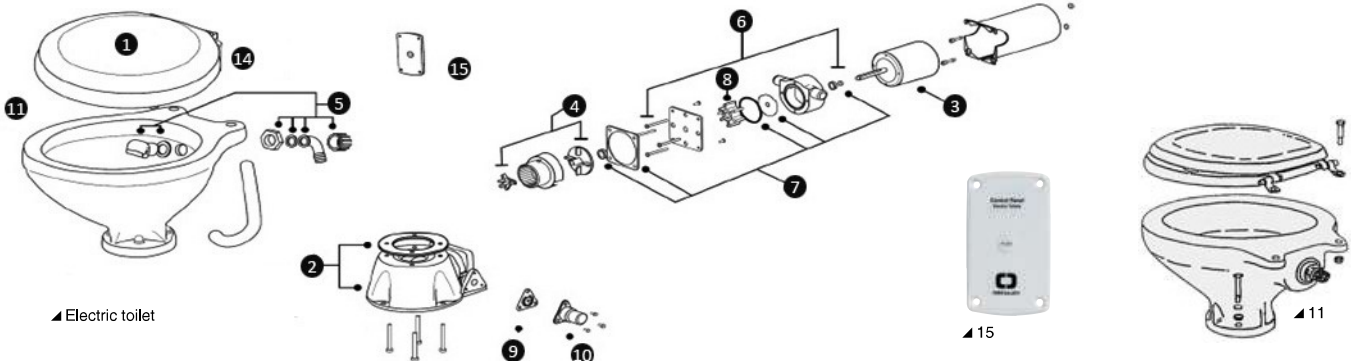

▲ Electric toilet

▲ 15

▲ 11

**Toilet installation kit**

Includes thru-hull scoop strainer, skin fitting, 2 hose adaptors and 2 sphere gate valves.

Code	For toilet type	Brass ball valve	Brass thru-hull scoop strainer	Hose	Composition
50.205.02	Manual	1/2" x 1"1/4	1/2" x 1"1/4	1"1/4 x 39 mm + 1/2" x 20 mm	17.228.02+17.228.05+17.198.09+17.198.18+17.321.81+17.321.84
50.205.03	Electric	1/2" x 1"1/4	1/2" x 3/4"	3/4" x 25 mm + 1/2" x 20 mm	17.228.02+17.228.03+17.198.09+17.198.12+17.321.81+17.321.82





**Laguna Slim electric toilet**

High-quality **ceramic** bowl and **soft close plastic** board, Permanent-magnet motors and stainless steel shaft. 19-mm (3/4") inlet pipe and 25-mm (1") or 38-mm (1 1/2) outlet pipe.

**Version with built-in suction pump + centrifugal grinder.** Control panel INCLUDED. **Spray Nozzle** washing fitting for faster and more effective cleaning at very high pressure on all the toilet bowl surface.

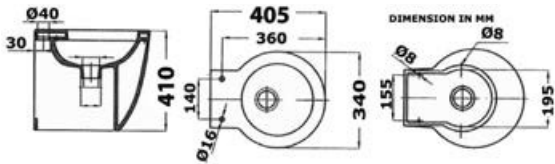

Code	V	A	mm			kg
			height	width	depth	
50.214.12	12	19	410	340	405	16
50.214.24	24	10	410	340	405	16

**50.209.80 Seal kit**



▲ 50.204.44

**Luxury electric toilet**

Faired **white ceramic toilet bowl**. Built-in self-priming pump, with water and liquid suction/drainage/**macerator** functions. 19-mm (3/4") suction pipe, 25-mm (1") outlet. Control panel INCLUDED.

**Spray Nozzle** washing fitting for faster and more effective cleaning at very high pressure on all the toilet bowl surface.



▲ 50.213.01/02



▲ 50.213.03/04



▲ 50.204.44

Supply		Version	Board	Control panel OPTIONAL
12 V	24V			
50.213.03	50.213.04	HIGH	Duroplast soft close	50.207.07; 50.207.08; 50.207.09
50.213.01	50.213.02	LOW	Duroplast soft close	50.207.07; 50.207.08; 50.207.09

**50.209.80 Seal kit**

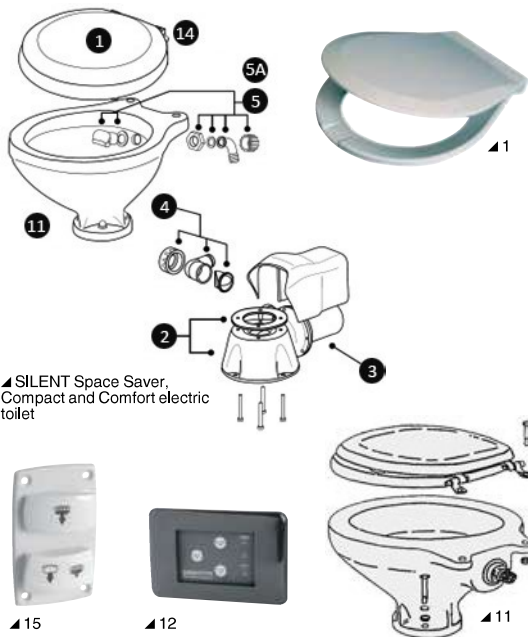
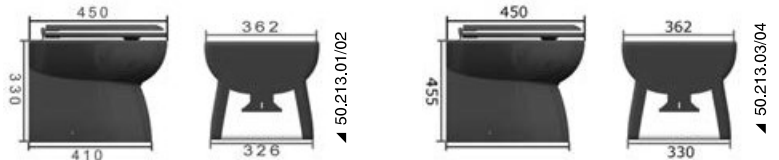

▲ SILENT Space Saver, Compact and Comfort electric toilet



▲ 15



▲ 12



▲ 11

**Spare parts and accessories for SILENT Space Saver, Compact and Comfort electric toilets**

Code	Description
50.210.12	Silent Space Saver 12V toilet
50.212.01/02	Silent Compact 12V/24V toilet
50.212.03/04	Silent Comfort 12V/24V toilet

Number	Description	Code
1	Standard soft close WC plastic board for 50.246.12/24; 50.210.12; 50.212.01/02	50.207.51
1	Large soft close WC duroplast board for 50.212.03/04	50.207.52
2	Base + gasket	50.209.81
3	12V motor unit for 50.210.12; 50.212.01/02; 50.212.03/04	50.209.93
3	24V motor unit for 50.210.12; 50.212.01/02; 50.212.03/04	50.209.94
4	Drain kit (hose connector + ring nut)	50.209.17
5	Water inlet kit straight connection	50.207.16
5A	Water inlet kit 90° connection	50.207.43
11	Compact spare bowl for 50.246.12/24; 50.212.01/02	50.207.36
11	Space Saver spare bowl for 50.210.12	50.207.37
11	Large spare bowl for 50.212.03/04	50.207.44
12	Spare panel for 50.210.12; 50.212.01/02; 50.212.03/04	50.204.42
14	Hinge kit for toilet board	50.207.49
15	Spare panel for 50.215.01/02; 50.216.01/02; 50.218.01/02	50.204.43

## SILENT ELECTRIC TOILETS



**Electric toilet**, with automatic load and waste. Very quiet operation. It needs 1 to 5 litres of water for every washing cycle. High-capacity centrifugal grinder to prevent clogging. Built-in Water Lock and anti-siphon valve. Designed to be connected to waste water tanks. Possibility of series mounting with a single pump and several solenoids. High-quality **ceramic bowl**. **Soft close plastic board**. Designed for "bidet kit" (except models 50.212.01-02-03-04). 38-mm Ø outlet.

Supplied with control panel 50.204.42.

### WC SILENT Space Saver - low bowl

SoftClose board. Control panel INCLUDED.  
Spray Nozzle washing fitting for faster and more effective cleaning at very high pressure on all the toilet bowl surface.

Code	V	←→  mm	Self-priming pump for sea water suction OPTIONAL	Electro-valve * OPTIONAL
50.210.12	12	330x420x360h	16.525.12	50.203.10

\* OPTIONAL Electro-valve to connect suction to the onboard circuit.



### WC SILENT Compact - standard bowl

SoftClose board. Control panel INCLUDED.

**Spray Nozzle** washing fitting for faster and more effective cleaning at very high pressure on all the toilet bowl surface.

Code	V	←→  mm	Self-priming pump for sea water suction OPTIONAL	Electro-valve * OPTIONAL
50.212.01	12	330x420x390h	16.525.12	50.203.10
50.212.02	24	330x420x390h	16.525.24	50.203.11

\* OPTIONAL Electro-valve to connect the water intake to the W.C.



### WC SILENT Comfort - big bowl

Control panel INCLUDED. Soft close board.

**Spray Nozzle** washing fitting for faster and more effective cleaning at very high pressure on all the toilet bowl surface.

Code	volt	←→  mm	Self-priming pump for water suction OPTIONAL	Electro-valve * OPTIONAL
50.212.03	12	365x460x385h	16.525.12	50.203.10
50.212.04	24	365x460x385h	16.525.24	50.203.11

\* OPTIONAL Electro-valve to connect the water intake to the W.C.





### WC SILENT Slim

Version with sole built-in centrifugal grinder. Very silent, minimum water consumption. Control panel INCLUDED.

**Spray Nozzle** washing fitting for faster and more effective cleaning at very high pressure on all the toilet bowl surface.

Code	V	A	Cycle	mm			kg	Self-priming pump for sea water intake OPTIONAL	Electrovalve * OPTIONAL
				height	width	depth			
50.215.01	12	8	Automatic	410	340	409,3	16	16.525.12	50.203.10
50.215.02	24	4	Automatic	410	340	409,3	16	16.525.24	50.203.11



\* OPTIONAL Electro-valve to connect the water intake to the W.C.



50.215.01; OPTIONAL Automatic cycle: equipped with electric panel 50.204.42 for water suction, cleaning and automatic draining.

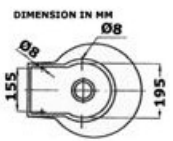
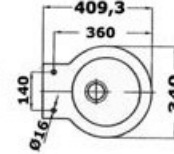
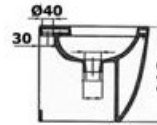

### WC VACCUM BLUE WAVE Low Elegant model with SILENT 80-db pump

The SILENT pump reduces drain noise to as low as 80 dB, the lowest on the market. Control panel INCLUDED.

**Spray Nozzle** fitting for fast and effective high-pressure washing of the whole toilet bowl.



Code	V	Board	Self-priming pump for sea water suction OPTIONAL	Electro-valve * OPTIONAL
50.216.01	12	Duroplast Softclose	16.525.12	50.203.10
50.216.02	24	Duroplast Softclose	16.525.24	50.203.11



\* Electrovalve to be placed between the loading pump and the toilet.



50.207.39 Spare cover board made of Duroplast SoftClose for 50.216.01; 50.216.02.

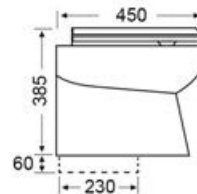

### WC VACUUM BLUE WAVE Elegant high model with Silent 80 dB pump

The SILENT pump reduces drain noise to as low as 80 dB, the lowest on the market. Control panel INCLUDED.

**Spray Nozzle** fitting for fast and effective high-pressure washing of the whole toilet bowl.



Code	Board	V	Self-priming pump for sea water suction OPTIONAL	Solenoid valve * OPTIONAL
50.218.01	Duroplast Softclose	12	16.525.12	50.203.10
50.218.02	Duroplast Softclose	24	16.525.24	50.203.11



\* Electrovalve to be placed between the loading pump and the toilet.



50.207.39 Spare cover board made of Duroplast for 50.218.01; 50.218.02.

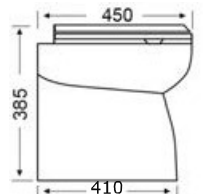

**WC self-priming pumps for water intake**

CE It pairs fresh water pump 16.517.24 fitted with strainer with an art spray nozzle. 36.189.00 + 36.189.01 + 36.189.02. Ideal for deck washdown as well as cleaning of bilges, anchors, stern drive units and propellers. Strainer and 4 fittings included.



Code	Type	Volt	Capacity l/min	Joints
16.525.12	4 valves	12	17	1/2 " and 14 mm
16.525.24	4 valves	24	17	1/2 " and 14 mm

**Electro-valve**

Designed to be positioned between the loading pump and the toilet unit if installing more than one toilet unit with just one pump. This valve also works as anti-siphon for loading when toilet units mounted under the water level.



Code	V	Female thread
50.203.10	12	1/2"
50.203.11	24	1/2"

**SILENT series ceramic bidet**

Delivered without tap.

Code	Version	Rear
50.219.02	high	straight
50.219.03	high	chamfered

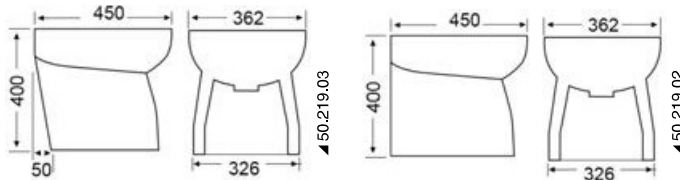

**Spare parts and accessories for Laguna and Luxury electric toilets, and SILENT Slim and Elegant toilets**

Code	Description
50.214.12/24	Laguna Slim 12V/24V electric toilet
50.213.01/02	Luxury 12V/24V electric toilet, low model
50.213.03/04	Luxury 12V/24V electric toilet, high model
50.215.01/02	Silent Slim 12V/24V automatic toilet
50.216.01/02	Silent Elegant 12V/24V automatic toilet, low model
50.218.01/02	Silent Elegant 12V/24V automatic toilet, high model

Number	Description	Code
1	Soft close plastic WC board for 50.215.01/02; 50.214.12/24	50.207.51
1	Soft close duroplast WC board for 50.216.01/02; 50.218.01/02; 50.213.01/02; 50.213.03/04	50.207.39
2	Water inlet nozzle kit, straight fitting	50.207.16
2A	Water inlet nozzle kit, 90° fitting	50.207.43
7	Slim 12V complete pump for 50.215.01	50.209.64
7	Slim 24V complete pump for 50.215.02	50.209.65
7A	Elegant 12V complete pump for 50.216.01; 50.218.01	50.209.60
7A	Elegant 24V complete pump for 50.216.02; 50.218.02	50.209.61
7B	Laguna 12V complete pump for 50.214.12	50.209.68
7B	Laguna 24V complete pump for 50.214.24	50.209.69
7C	Luxury 12V complete pump for 50.213.01; 50.213.03	50.209.71
7C	Luxury 24V complete pump for 50.213.02; 50.213.04	50.209.72
8	Silent 12V electric motor for 50.215.01	50.209.95
8	Silent 24V electric motor for 50.215.02	50.209.96
8	Slim 12V electric motor for 50.214.12; 50.213.01; 50.213.03	50.209.97
8	Slim 24V electric motor for 50.214.24; 50.213.02; 50.213.04	50.209.98
10	Spare Laguna ceramic bowl for 50.215.01/02; 50.214.12/24	50.207.45
10	Spare low ceramic bowl for 50.216.01/02; 50.213.01/02	50.207.56
10	Spare high ceramic bowl for 50.213.03/04; 50.218.01/02	50.207.57
11	Gasket kit for 50.215.01/02; 50.216.01/02; 50.218.01/02; 50.214.12/24; 50.213.01/02; 50.213.03/04	50.209.80
12	Spare panel for 50.215.01/02; 50.216.01/02; 50.218.01/02	50.204.42
15	Switch panel for 50.214.12/24; 50.213.01/02; 50.213.03/04	50.204.44
16	Spare panel for 50.215.01/02; 50.216.01/02; 50.218.01/02	50.204.43



▲7

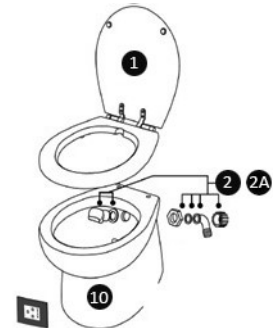

▲ Laguna and Luxury electric toilets, and SILENT Slim and Elegant toilets



▲7A

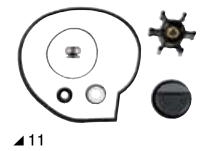

▲11



▲7B; 7C



▲12



▲15

▲16



## TECMA electric toilet bowls



Tecma products feature ultra quiet operation, reliable systems, low consumption in terms of power and water (0.5 to 2.7 litres per cycle), fast installation and high-quality components. The product range comes in different lines and formats to suit all needs still offering the same technology and respecting the installations design restrictions.



▲ 50.227.00/01/05/06;  
50.227.10/11/15/16

▲ 50.227.07/08;  
50.227.17/18

Floor installation



Installation below the floor



### TECMA Silence Plus 2G electric toilet bowl

The second generation of Silence Plus 'big bowl' model. The length of 51 cm creates the at-home seating feeling. Made-in-Italy white ceramic, soft-close thermosetting plastic board that covers the seat. Control panel included. Fitted with solenoid to bypass the onboard plumbing. For installation with sea water inlet pump, order code 16.525.12 / 16.525.24 or similar ones.

Model	V	mm			kg
		height	width	depth	
Silence Plus 2G Short Deep Bowl	12	360	397	513	23.5
Silence Plus 2G Short Deep Bowl	24	360	397	513	23.5
Silence Plus 2G	12	460	390	510	25.5
Silence Plus 2G	24	460	390	510	25.5
Silence Plus 2G	12	460	390	510	25.5
Silence Plus 2G	24	460	390	510	25.5

WC		Model	Built-in bidet	Installation
All in one panel	Touch panel			
50.227.07	50.227.17 <b>New</b>	Silence Plus 2G Short Deep Bowl	No	Under the floor
50.227.08	50.227.18 <b>New</b>	Silence Plus 2G Short Deep Bowl	No	Under the floor
50.227.00	50.227.10 <b>New</b>	Silence Plus 2G	No	Above the floor
50.227.01	50.227.11 <b>New</b>	Silence Plus 2G	No	Above the floor
50.227.05	50.227.15 <b>New</b>	Silence Plus 2G	Yes	Above the floor
50.227.06	50.227.16 <b>New</b>	Silence Plus 2G	Yes	Above the floor

All models can be ordered in ivory or black, and can have a built-in bidet function



▲ Built-in bidet



▲ Built-in bidet

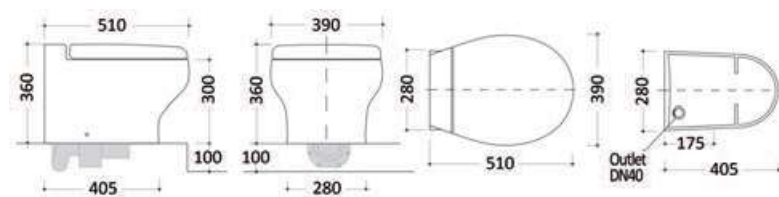

▲ 50.227.07/08; 50.227.17/18

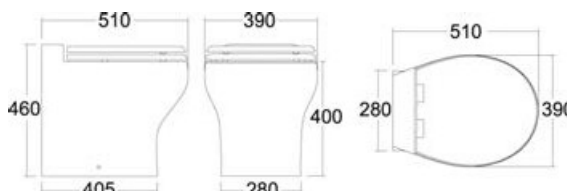

▲ 50.227.00/01/05/06; 50.227.10/11/15/16



▲ All in one Panel 50.226.50



▲ Touch Panel 50.226.51



### TECMA Nano electric toilet bowl

The Nano is the shortest model on the market combining comfort, reliability and performance.

As silent as the other Tecma electric bowls, it is as short as 295 mm. Italian white ceramic, thermosetting polyester seat. Eco Rocker Switch control panel included. Fitted with solenoid to bypass the onboard plumbing. For installation with sea water inlet pump, order code 16.525.12 / 16.525.24 or similar.



▲ Control panel

Code	Model	V	mm			kg
			Height	Width	Depth	
50.228.00	Nano	12	295	370	446	17.6

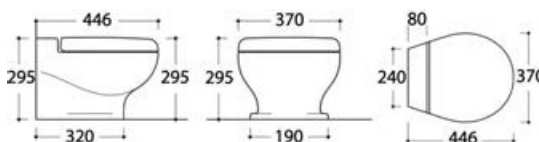

**TECMA Compass electric toilet bowl**

The Compass has been designed for vessels from 30' to 50' and is Tecma's entry level bowl combining reliability and performance.

As silent as the other Tecma electric bowls. Italian white ceramic, soft-close thermosetting polyester seat.

Eco Rocker Switch control panel included. Fitted with solenoid to bypass the onboard plumbing. For installation with sea water inlet pump, order code 16.525.12 / 16.525.24 or similar.



▲ Control panel



▲ 50.229.01/02



▲ 50.229.03/04

Code	Model	V	mm			kg
			Height	Width	Depth	
50.229.01	Compass High	12	445	365	485	21.5
50.229.02	Compass High	24	445	365	485	21.5
50.229.03	Compass Short	12	365	365	485	19.5
50.229.04	Compass Short	24	365	365	485	19.5

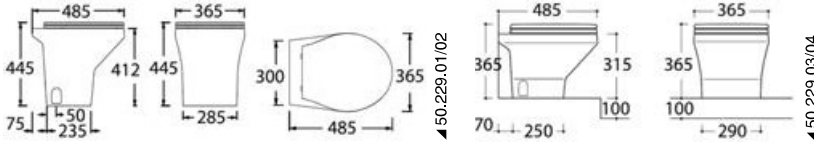

**TECMA Elegance 2G electric toilet bowl**

The second generation of Elegance 2G is the 'small bowl' model. The length of 43 cm maximizes comfort within reduced spaces onboard. Made-in-Italy white ceramic, soft-close thermosetting plastic board that covers the seat.

Control panel included. Fitted with solenoid to bypass the onboard plumbing. For installation with sea water inlet pump, order code 16.525.12 / 16.525.24 or similar ones.



▲ 50.227.24/25; 50.227.34/35



▲ 50.227.20/21; 50.227.30/31

Model	V	mm			kg
		height	width	depth	
Elegance 2G Short Deep Bowl	12	355	377	434	23.5
Elegance 2G Short Deep Bowl	24	355	377	434	23.5
Elegance 2G	12	460	370	430	25.5
Elegance 2G	24	460	370	430	25.5

WC		Model	Installation
All in one panel	Touch panel		
50.227.24	50.227.34 <b>New</b>	Elegance 2G Short Deep Bowl	Under the floor
50.227.25	50.227.35 <b>New</b>	Elegance 2G Short Deep Bowl	Under the floor
50.227.20	50.227.30 <b>New</b>	Elegance 2G	Above the floor
50.227.21	50.227.31 <b>New</b>	Elegance 2G	Above the floor

All models can also be ordered in ivory or black with built-in bidet function.



Installation below the floor



Floor installation

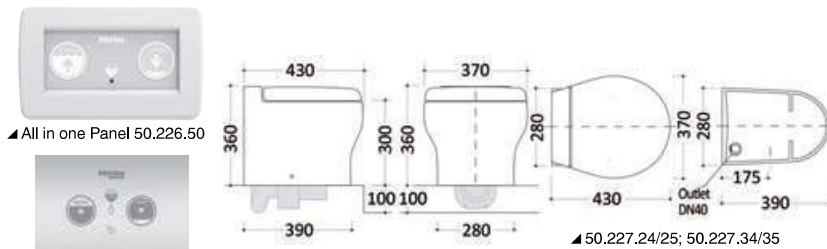

▲ All in one Panel 50.226.50



▲ Touch Panel 50.226.51

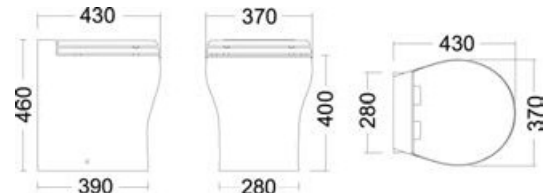

▲ 50.227.20/21; 50.227.30/31

**TECMA Silence Plus 2G bidet**

Bidet matching the Silence Plus 2G electric toilet bowls. Made-in-Italy white ceramic bowl.



Code	Model	mm			kg
		height	width	depth	
50.227.04	Silence Plus 2G	400	390	510	16

The item can also be ordered in ivory or black.

Mixer not included

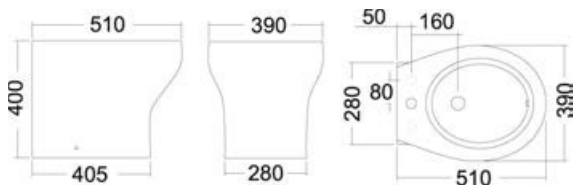

**TECMA**

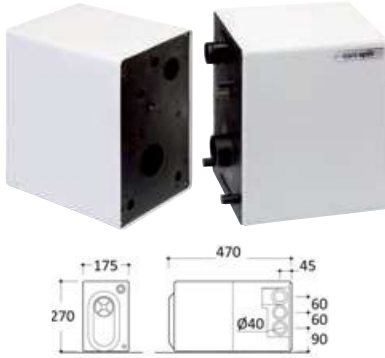

**TECMA Sanisplit NK grey water transfer systems**

Grey water transfer system for increased installation flexibility of washbasins, bidets, washing machines and dishwashers on board.  
This system grinds and pumps waste into the collection tank. No clogging.

Efficient and rugged macerating pump.  
Silent operation: the silent pump operation combined with the internal rubber tank reduce the sound level

Easy to service: the removable part of the Sanisplit, containing the pump and the pressure switch, can be rapidly disengaged from the fixed parts.

Code	V	mm	Pipe Ø mm		kg
			delivery	intake	
50.260.24	24	270x470x175	1x40	2x40	8
50.260.22	220	270x470x175	1x40	2x40	8

**TECMA**



**TECMA spare seat cover for electric toilets**

Seat covers compatible with several generations of Tecma toilet bowls.  
White colour, soft close system.

Two versions available:

- A. With wooden core coated in polyester and fitted with stainless steel hinges.
- B. Thermosetting plastic (lightweight version that hides the seat).

Code	Material	Hinges	Depth cm	For Tecma electric toilet bowls
50.226.90	Wood and polyester	316 SS	42	Silence Plus (G1 and G2)
50.226.91	Thermosetting plastic	Plastic	42	Silence Plus (G1 and G2)
50.226.92	Wood and polyester	316 SS	36	Elegance (G1 G2)
50.226.93	Thermosetting plastic	Plastic	35.5	Elegance (G1 G2)

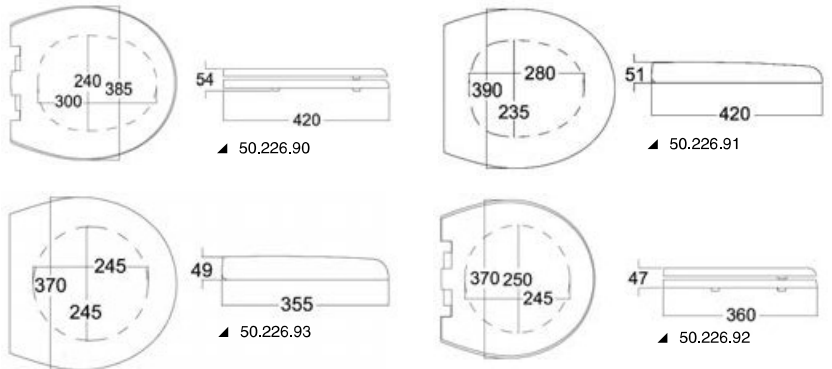

**TECMA**

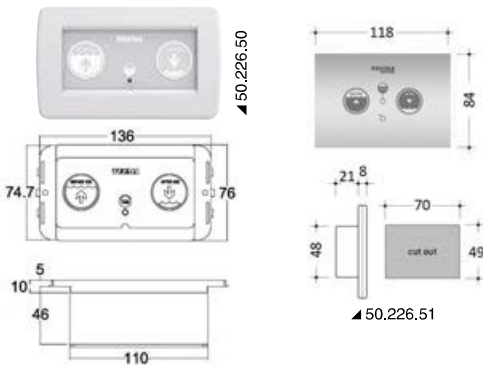

**Spare parts for TECMA electric toilets**

Code	Description	V	For Tecma electric toilets
50.226.50	All in One 2-button control panel, 2 frames (one white and one black).	-	G1 and G2
50.226.51 <b>New</b>	Multipurpose SFT Touch control panel	-	G1 and G2
50.226.60	Macerator pump	12	G1 and G2
50.226.61	Macerator pump	24	G1 and G2
50.226.65	Plastic solenoid (it also replaces brass solenoids)	12	G1 and G2
50.226.66	Plastic solenoid (it also replaces brass solenoids)	24	G1 and G2
50.226.71	Seal and valve kit	-	G1 and G2
50.226.80	Clean water inlet kit (white)	-	G1 and G2

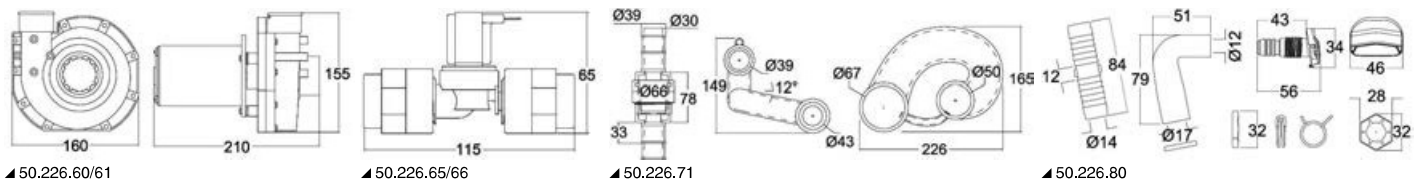

## WC control panels

### Switch "toilet FLUSH"



For driving electric toilet units size 15 A of any brand, **watertight**; automatic return toggle and built-in **magnetohermic** fuse.

Code	volt	Panel mm
50.207.09	12/24	80x60

### Electric control panel, universal size for electric toilets



100% waterproof; fitted with protective fuse, 2 position micro-relay power and control; partial bowl filling option (aprox. 21) or full bowl (aprox 4l).

Code	volt	Board mm
50.207.07	12	110x80
50.207.08	24	110x80

### Toilet unit control panel

Fitted with touch key button and LED light indicator that signals the waste water level on the respective tank, version suitable for traditional electric toilet units.

Code	←→  mm		For WC
	frontal	overhang recess	
50.204.41	125x80	10	50.205.12; 50.205.24; 50.206.12; 50.206.24; 50.207.12; 50.207.24; 50.213.01; 50.213.02; 50.213.03; 50.213.04; 50.205.13; 50.207.13



### Manual control panel

Manual control panel for WC SILENT series 50,212.xx / 50,216.xx / 50,213.xx / 50,218.xx / 50,215.xx. Designed for those who prefer a simpler and very strong control system. Equipped with CARLINGSWITCH watertight switches. Double function push button: water inlet in position 1, water outlet in position 2. The second push button let the water in and out at the same time and also makes a final washing.

Code	V	←→  mm
50.204.43	12/24	100x60



### Electronic control panel



**50.204.42** Standard panel supplied with all SILENT toilets. Three buttons for use: "before use", it lets water inside the bowl, "after use" for rinsing and emptying of the bowl, "short use" for rinsing and emptying with water reduced consumption. Size compatible with Vimar plates. The panel has 3 LED lights indicating the level of the collection tank when connected to the probe 50.204.33 to be ordered separately.

### Electric control panel for standard electric toilets



**50.204.44** Manual and simplified control panel for any traditional electric toilet. Watertight and button-operated microswitch. 24A max. amperage @ 12V. 12/24V operating voltage. Measurements all out: 12/24 mm.

### Electronic depth probe

Depth probe for black water tanks. Adjustable length by cutting the little rods. To match the WC control panel (50,204,42). International 5-hole standard flange.

Code	OPTIONAL To combine with control panel
50.204.33	50.204.41; 50.204.42





## Water level indicators



### Waste Guardian 10-180 ohm waste water gauge

White dial White bezel	Black dial Black bezel	OPTIONAL chromed bezel	V	←→  mm		
				A	B	C
27.538.01	27.438.01	27.455.02	12	59	52	45
27.538.02	27.438.02	27.455.02	24	59	52	45



### Waste water gauge

Black dial, black bezel	Black dial, glossy bezel	White dial, glossy bezel	Signal	Volt	←→  mm		
					A	B	C
27.320.05	27.321.05	27.322.05	10-180 Ω	12/24	57	51	45



### Capacitive sensor

5-bore international flange. 10-180 ohms resistance.  
It matches items 27.438.xx / 27.538.xx and all 10-180 Ω instruments.

Code	Length mm	For tanks h mm
50.204.82	240	260
50.204.83	280	290/300
50.204.84	380	400

**OSCULATI**



### Black and clear water vertical level sensors

Made of stainless steel, they have a s.s. coating avoiding dirt to enter. 5-bore international flange. 10-180 Ω frequency. Combine with our instruments 27.438.xx / 27.538.xx / 27.320.05 / 27.321.05 / 27.322.05 or all 10-180 Ω instruments.

Code	Length cm
50.202.25	25
50.202.28	28
50.202.32	32
50.202.38	38
50.202.48	48



### Panel kit + black water level probe

It includes: panel with 4-LED signalling device (<1/2 - 1/2 - 3/4 - FULL) + 5-bore international flange probe preset for 15/55-cm high tanks. The probe sensors will have to be cut depending on the tank height.

Code	←→  panel mm	Length of prewired cable m	V
50.204.60	75x62	4	12/24



50.204.61 4-m extension cable with male/female connectors.

## GOBIUS level gauges

**Gobius®**  
Level Indicators

**Gobius®**  
Level Indicators



### GOBIUS PRO level sensor - Bluetooth

**BLUETOOTH** Sensor to be mounted on the outside of any tank whose vibrations indicate the inside level.

- It can be mounted on tanks of any materials.
- It works with any kind of liquid.
- Easy to install without drilling the tank (no leaks or bad smell).
- 1 to 9 sensors can be mounted on a single tank (each indicating a single step).

1 sensor only is recommended to indicate 3/4 waste water or water/fuel reserve. Gobius Pro can be programmed via Bluetooth and it can be connected to a warning light, relay or buzzer.

It can be read **also via Bluetooth** (App available for download on your smartphone or other devices).  
App languages: English, Italian, French, German, Norwegian, Swedish.

Code	Description	Recommended for	No. of sensors
27.182.01	GOBIUS PRO 1	12/24	1

## Waste water tanks

### Flexible tanks for waste water

Made with a special fabric with **anti-odour** non-breathable barrier, ideal for boats that don't have waste water tanks and if wish to fit one without making difficult modifications on the bilge, supplied with outlets Ø 38 mm for filling and draining, the outlets can be mounted on the most convenient position, making sure that the tank can inflated and deflated freely.

Code	Volume l	Pipe unions Ø mm	↔ cm
50.146.01	50	38	69x72
50.146.02	100	38	69x110

**OSCULATI**



### Universal waste water collection tank

**OSCULATI**

For mounting **around** the toilet unit, fits all existing toilet unit brands Par, Raritan, RM, Groco as well as our models 50.207.25, 50.217.25, 50.207.12, 50.205.12, either manual or electric; for a correct installation with manual or electric toilets, it requires a by pass and a draining pump; the pumps can be removed if the draining is used with a "Waste" plug on the deck.

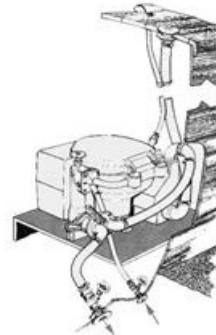
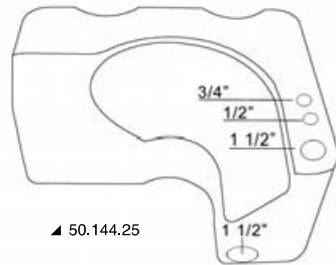

Code	Capacity l	↔ cm			With hand WC, to complete with		With electric WC, to complete with	
		width	depth	height	pump	bypass	pump	bypass
50.144.25	26	50	40	25	50.527.00/15.268.01 or similar	50.233.38	50.527.00/15.268.01 or similar	17.229.02

### Rigid polyethylene waster water tanks

Fitted with female connectors on the two heads size 3/4" and 1 1/2" for loading, drain and vent. Thick polyethylene mouldings preventing bad smell. Certified in compliance with ISO 8099 standards.

Code	Capacity l	Base mm	Hight mm
50.140.50	50	430x550	290 with blunting for hull
50.140.51	75	430x800	290 with blunting for hull
50.140.52	100	430x1050	290 with blunting for hull
50.142.50	47	480x400	260 rectangular
50.142.51	78	700x400	300 rectangular
50.142.52	130	880x500	300 rectangular
50.142.55	215	1000x400	600
50.144.51*	86	1000x350	320 with blunting for hull

Suggested connectors: see group 52 (nylon fittings) and group 17 (metal fittings).

\* Symbols: A = 1" - B = 1 1/4" - C = 1 1/2" - D=3/4" - IS = Inspection - SDL = Level Sensor

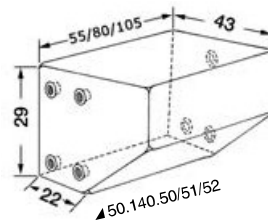

▲ 50.140.50



▲ 50.140.51

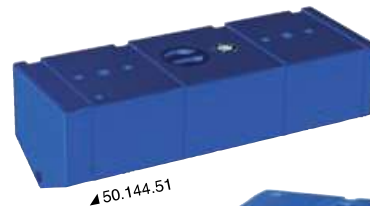

▲ 50.144.51



▲ 50.142.51

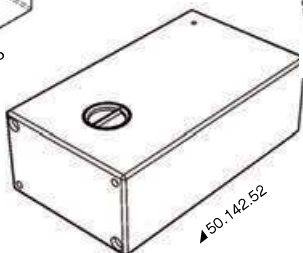
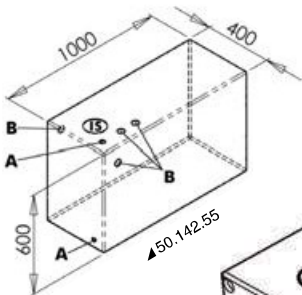

▲ 50.142.52

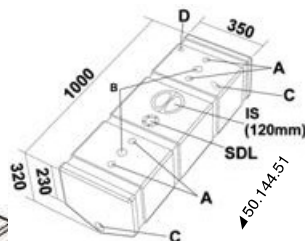

**OSCULATI**



**Waste water tank, for bulkhead mounting**

Designed with **gravity** draining system, no pump required, includes 3/4" - 1" 1/2 female threadings for load, 1" 1/4 female threadings for unload, vent and level indicator flange, made according with ISO 8099 standards.

Code	Capacity litres	Max length for float cm	mm
50.145.60	60	60	450 x 350 depth x 670 total height

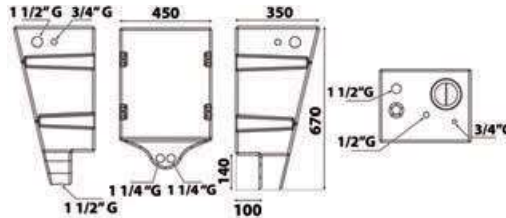

**OSCULATI**



**Waste water tank with built-in WHALE macerator**



Pre-assembled tank with "Whale Gulper toiler" macerator 50.113.xx. The Whale unblockable and non-clog macerator doesn't have impellers. The tank is designed with inlets/outlets to hose connectors in order to avoid threaded connections as much as possible thus preventing bad smell.

Equipped with: inspection trapdoor; 5-bore flange for level sensor (to order separately); sockets for fixing hooks 52.195.00 (flat bottom version). Made in compliance with ISO 8099 standards.

Code	Net volume l	volt	Macerator included	Macerator outlet Ø mm	Max length for float cm
50.143.12	100	12	50.113.12	38	35
50.143.24	100	24	50.113.24	38	35
50.143.62	115	12	50.113.12	38	35
50.143.64	115	24	50.113.24	38	35

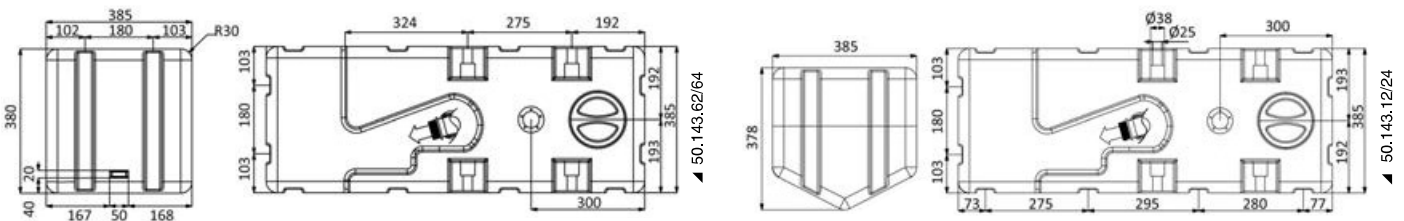

**OSCULATI**



**Waste water tank with in-built soaker**

Ready for installation. Compatible with all electric and manual toilet systems. **EQUIPPED WITH:** Electric macerator. 1" 1/2 + 3/4" load female adaptor. 3/4" unload female adaptor. 1" 1/2 back vent manual emergency female adaptor.

Mounting hollows 52.195.00; Shut-off valve to detach the macerator for maintenance. 5-bore flange for level indicator (to be ordered separately). Protection for sensor level. Complying with ISO 8099.

Code	Net volume l	V	Recess D mm	Macerator model INCLUDED	macerator outfeed Ø mm	Max length for float cm	mm		
							A	B	C
50.147.12	52	12	100	50.220.12	25	39	450	350	400
50.147.24	52	24	100	50.220.24	25	39	450	350	400
50.148.12	72	12	100	50.220.12	25	39	650	330	400
50.148.24	72	24	100	50.220.24	25	39	650	330	400
50.149.12	112	12	100	50.220.12	25	39	650	490	400
50.149.24	112	24	100	50.220.24	25	39	650	490	400

Suggested connection: group "52" in nylon, group "17" in metal

52.195.00 Stainless steel plate, tank mounting

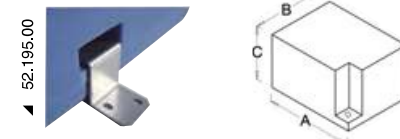



**Black water tank with horizontal soaker**



Sold already mounted and ready for installation. Compatible with all manual and electric WC. EQUIPPED WITH: electric soaker; 1" 1/2 + 3/4" loading female threads; 3/4" vent female threads; 1" 1/2 manual emergency drain female threads; housing for fastening hooks 52.195.00; shut-off valve for soaker drainage in case of maintenance; 5-bore flange for level sensor (sensor to order separately); protection for sensor level. Manufactured in compliance with the ISO 8099 standard.

Code	Net volume l	volt	Macerator included	Macerator outlet Ø mm	Max length for float cm	mm			SS plate for tank fastening OPTIONAL
						A	B	C	
50.147.50	40	12	50.220.12	25	25	500	390	300	52.195.00
50.147.51	40	24	50.220.24	25	25	500	390	300	52.195.00
50.147.65	60	12	50.220.12	25	25	650	390	300	52.195.00
50.147.66	60	24	50.220.24	25	25	650	390	300	52.195.00
50.147.80	80	12	50.220.12	25	25	800	390	300	52.195.00
50.147.81	80	24	50.220.24	25	25	800	390	300	52.195.00
50.147.91	105	24	50.220.24	25	25	1050	390	300	52.195.00

Recommended joint: group "52" made of nylon, group "17" made of metal

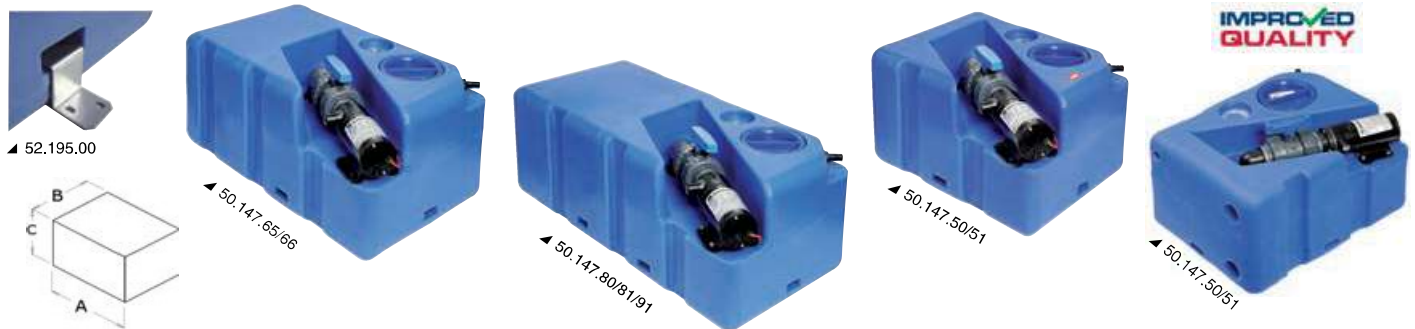

**Black water tank with horizontal macerator and hose connector inlets**



Sold already mounted and ready for installation. Compatible with all manual and electric toilet units.

FITTED WITH: electric macerator; vent with 16-mm Ø hose connector; housing for fastening hooks 52.195.00; shut-off valve for soaker drainage in case of maintenance; 5-bore flange for level sensor (sensor to order separately); protection for sensor level. Manufactured in compliance with the ISO 8099 standard.

Code	Net volume l	Macerator included	Macerator outlet Ø mm	V	Max length per float cm	SS plate for tank fastening OPTIONAL
50.141.50	50	50.220.12	25	12	25	52.195.00
50.141.70	70	50.220.12	25	12	25	52.195.00
50.141.90	91	50.220.12	25	12	25	52.195.00
50.141.91	91	50.220.24	25	24	25	52.195.00

Recommended joint: group "52" made of nylon, group "17" made of metal

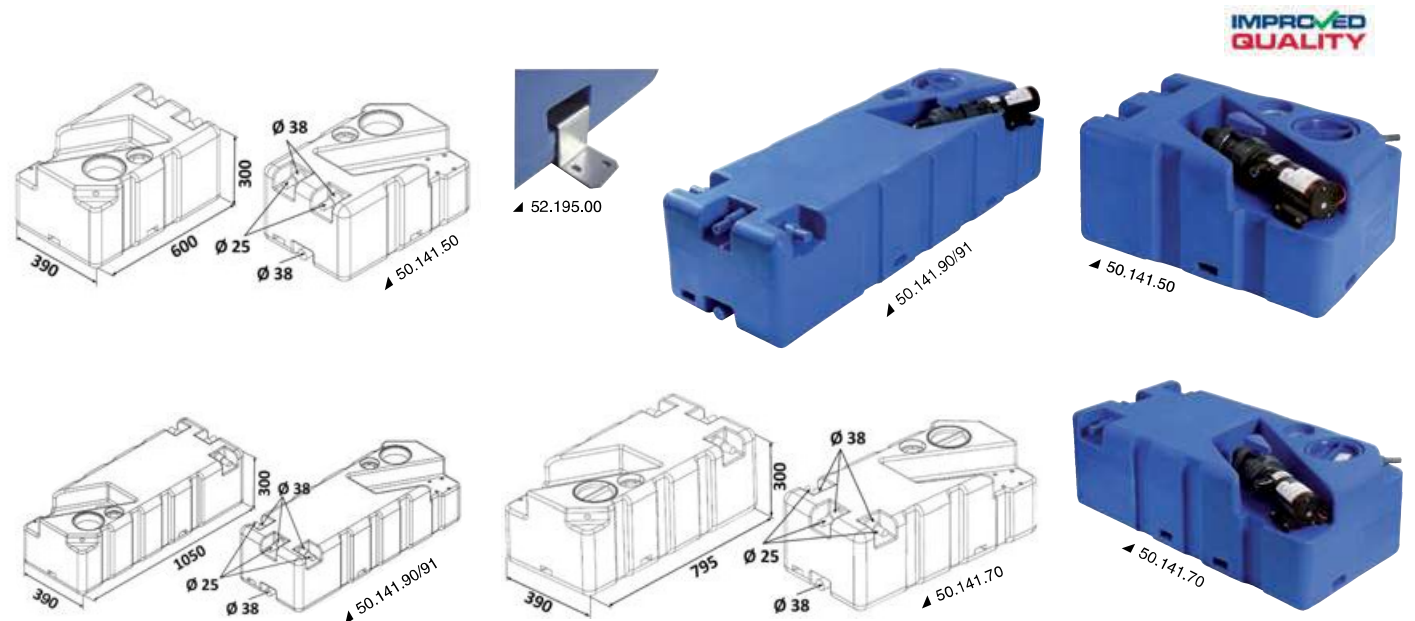



## Macerating pumps for waste water draining

**OSCOLATI**



### Self-priming macerator

It sucks, crush and ejects toilet waste by tapping from the waste water tank. 38-mm inlet port, 25-mm outlet port. Intake: max 100-cm dry parts, max 125-mm wet parts.

Code	V	Flow l/min	Flow l/min with 3-m head	Consumption A	mm
50.222.13	12	45	23	9	284x121x100
50.222.14	24	45	23	4,5	284x121x100

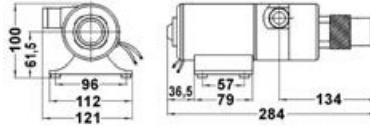

**OSCOLATI**



### Self-priming macerator

**MADE IN ITALY**

Useful for draining waste water tanks, inlet 38 mm, outlet 25 mm. CE certified in compliance with EN ISO 8846 standards.

Supply		Flow l/min	Flow l/min with 3-m head	Consumption A	mm	Spare impeller
12 V	24 V					
50.220.12	50.220.24	43	23	12/6	240x130x90	16.193.73
50.221.12	50.221.24	47	33	18/9	260x140x90	16.193.73



### Macerating pumps for toilet units "Whale Gulper"

**PATENT**

It is connected to the toilet unit or to the waste water tanks, is used to drain toilet units or tanks. Virtually **unblockable**, can run dry, self priming and can also be used with **vacuum** toilet units. Materials: **nylon/fibreglass + Hypalon rubber + brass + stainless steel**. Maximum suction and head of 3 metres, requires inlet/outlet pipes size 1 1/2 (38 mm).

Code	V	Volume l/min	Consumption A	kg
50.113.12	12	18	3,5	2,120
50.113.24	24	18	1,8	2,120



50.113.99  
16.155.98

Maintenance kit for Whale Gulper macerator: diaphragm, valves and screws.  
Gulper 220 closing ring and screw.

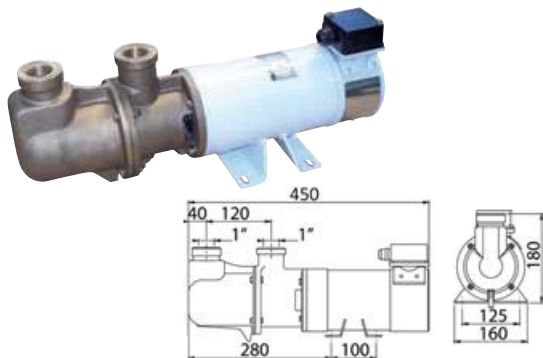

**New**

### CEM Sbr self-priming electric pump with bronze single screw

Consisting of a worm screw rotor revolving inside an NBR rubber stator. These electric pumps are used in the marine sector to drain waste boxes, toilet black waters and particularly viscous liquids with small suspended bodies.

Bronze pump body, AISI316 stainless steel shaft and rotor, AISI316 stainless steel and NBR joint, ceramic/graphite/NBR (anti-corrosion) mechanical seal. 24V permanent magnet motor, IP44 protection degree, F insulation class, continuous service S2 (40 minutes).

Code	Model	V	Flow l/min	Current draw A	Power		RPM	Max head m	kg
					HP	kW			
50.229.25	SBR	24	50	18	50	0,37	1400	40	12

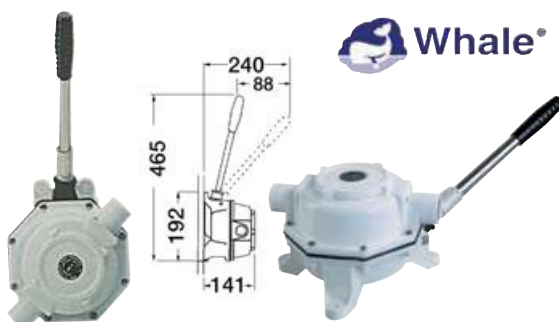

### Hand pump for waste water tanks WHALE

Code	Volume capacity l/min	Ø inlet/outlet
50.527.00	56	1" 1/2 (38 mm)



15.268.04 Spare seal kit for 50.527.00 OPTION

## Valve for waste water systems

Can be used in two ways:

- 1) the toilet drains into the sea or onto the waste water tank with a safety block on the lever, made in accordance with **ISO 8099 standards**
- 2) from the waste water tank the macerator is loaded onto the sea or dock with a back pump.

### Classic valve



Made of **ABS**, ready for remote control with a push-pull cable.

Code	Ø pipes mm	↔ mm
50.233.38	38	140x150x150

### STRONG valve



Made of **nylon reinforced** with fibers, meets with **ISO 8099 standards**. Fitted with outlets size **38/25 mm** + bulkhead extension cord that enables for non-visible handle mounting and keeps the valve hidden, the handle can be locked with a padlock.

Code	Ø pipes mm	↔ mm
50.234.00	38/25	200x80x60

### Whale valve

Wall mounting or mounting behind the bulkhead.

Code	Ø pipes mm	↔ mm
17.713.00	38	104x180
17.713.01	25	-



### Gate valve fitted with lock for waste water tanks

Made of chromed brass, **stainless steel handle** with perforated hole for fitting a padlock; ideal for meeting with **ISO 8099 standards** concerning waste water draining regulations.

Code	Size
17.228.55	1" 1/4
17.228.56	1" 1/2



### 3-way sphere valves

**AISI 316** Made of **AISI 316 stainless steel**; fitted with handle lock, meets with **ISO 8099 standard** for waste water drainage regulations.

Code	Size
17.722.05	1" 1/4
17.722.06	1" 1/2

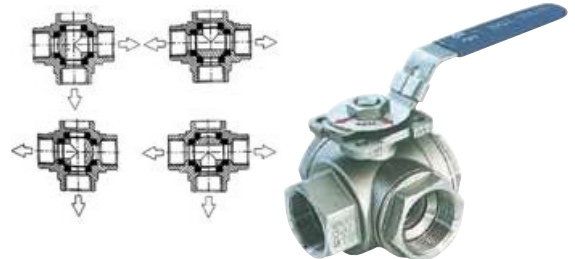

### 3-way ELECTRIC Y-valve

Electrified valve based on the manual version 50.234.00. With **ON-OFF-ON switch** to start the valve from either the control panel or the cabin. Designed to be used manually in case of failure. For pipes Ø 38/25 mm. External dimensions mm 250x180x200. Absorption 1,5 ampere 12 V.

volt	COMPLETE electric valve	Kit to electrify valve 50.234,00	Optional panel with fuse and switch
12	50.230.12	50.231.12	50.232.00
24	50.230.24	50.231.24	50.232.00



▲ Reduction joints INCLUDED

### OSCULATI



### Black water tank spare valve

50.141.98 OSCULATI black water tank spare valve



## WC accessories and waste water tanks

**OSCOLATI**



### "Deodorsan"

Active carbon filter for black water vents, it removes bad odours. Made of **aluminium** and **nylon**. Fitted with rubber coated **stainless steel** straps for bulkhead mounting.

Code	↔ mm	Hose adaptor
50.138.00	Ø 50 x 250	1/2" (17.236.00/01 - 17.199.08/09)



### Anti-smell filter

Active carbon filter for waste water tank draining.

Code	Description	Hose adaptor mm	↔ mm
50.136.00	complete filter	16	110 x 120
50.136.02	spare filtering element	-	



### Polypropylene U-trap for toilet units

Essential for safety, when the toilet is mounted **under the water level**; supplied with vent valve. NB: These water traps are **also suitable for onboard generator's cooling systems**.

Code	With barber mm	Type
50.203.19	19 (3/4")	load
50.203.25	25 (1")	Discharge electric WC
50.203.38	38 (1" 1/2)	discharge



### Connecting joints for toilet draining

Made of polished stainless steel.

Code	Type	For hoses Ø mm
50.237.01	90° elbow, perfect for confined space	38
50.237.02	"Y" joint to connect 2 discharges	38
50.237.03	"T" joint to connect 2 discharges	38



OCEANAIR

### OCEANAIR Brush & Stow

50.207.70 Brush & Stow is a unique cleaning brush, specifically developed to tackle the challenges of marine bathrooms.

Features:

- Bulkhead mounting.
- Small brush head designed for marine toilets.
- Clip-in lid traps odours in.
- Replaceable brush head, push-release.
- Clip-in lid, to secure brush into bowl.
- Removable bowl for easy cleaning.
- Discrete and compact, perfect for any bathroom, whatever the size.



50.207.71 Set of 3 x Brush & Stow spare heads.

▲ Replaceable brush head, push-release

### Toilet paper holder

**OSCOLATI**



**Waterproof white ABS.** Designed for boat toilets where toilet paper can easily become damp or saturated due to the proximity of the shower. **Universal** model.

Code	↔ mm
50.207.17	130x170x150 (length x height x overhang)

### Toilet brush holder

**OSCOLATI**



Made of **white ABS**, fitted with bulkhead bracket, **compact size made on purpose for the boat toilet units** available in our catalogue or equivalent foreign products (US, England, Taiwan, Holland, etc.).

Code	Height (handle included) mm	Ø mm	Overall protrusion mm
50.207.15	355	89	125

**DryRoll toilet paper stand OCENAIR**

OCENAIR

50.207.80 Watertight, ideal for showers with combined WC. Long lasting moulded ABS. Paper automati re-winding and release. Hygienic and easy to clean, can be recessed mounted or fixed on the surface. Colour: RAL 9016 white.



▲ 1 - Automatic rewinding; 2 - Automatic release



**Chem WC - Disintegrating and anti-fermentative product for chemical toilet units and waste water tanks**

OSCOLATI



Disintegrating anti-fermentative product, it prevents encrustations and smells in portable and fixed tanks. Super-concentrated formaldehyde-free solution in compliance with the regulations in force. Use: dilute 100 ml of product in 10 litres of water.

Code	Package	PACKAGE
50.208.80	1	6

**Grey Water anti-fermentative deodorant for waste water on motor campers and boats**

OSCOLATI



It prevents incrustations and bad odours, does not contain formaldehyde or corrosive substances. Usage: pour 60 ml into an empty tank for every 10-litre capacity.

Code	Package	PACKAGE
50.209.00	1	6

New

**Delysoft water-soluble toilet paper**



50.210.01 Toilet paper designed for marine toilets. It rapidly dissolves when it gets in contact with water thus preventing clogging and making the tank evacuation easier. 4-pc package.

**YACHTICON WC OIL**



Product based with natural oils; pour onto the toilet bowl: removes salt deposits; lubricates and cleans pump's rubber gaskets; lubricates and cleans gate valves.

Code	Bottle ml
50.610.31	100

**PURITEC ecological disinfectant for toilets**



Designed for installation with a special support on the toilet water draining piping line (electric or manual). Disinfects and deodorizes water from the bowl; supplied on a 100 ml container (400 washing operations). Universal hose adaptor size 15/19 mm suitable for all toilet units.

Code	Description
50.208.70	Spare screw cartridge 100 ml.
50.208.65	Complete kit

**Toilet protective cleaner**



Special formula device for boat's toilet units made of plastic or ceramic, removes dirt, limescale and other deposits, act as a disinfectant, protects and preserves gaskets and valves.

Code	Package ml
50.209.50	750

**YACHTICON PURYCLEAN disinfectant and cleansing agent**



Used to clean waste water tanks, removes bad odours and deposits, concentrated powder.

Code	Package g
50.209.52	500

**YACHTICON Free Hose toilet hose cleaner**



Specifically formulated to clear build up inside toilet drain pipes, and eradicate offensive odours due to its anti-bacterial action.

Code	Package g
50.209.53	1000

**YACHTICON Pury Tabs for toilets**



A simple and effective way to prevent bad smell in the toilets and to keep clean the black water tank.

Code	Package
50.209.54	15 pills 25 gr



## Heaters, defrosters

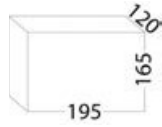

### Electronic forced-air heater

Connected to the onboard power, it heats the boat in a matter of minutes. Instant heating, automatic temperature control, secure and long lasting.

Control symbols: on/off - fan only - heating - fan speed.

Code	V	Consumption
50.383.00	12	300 W

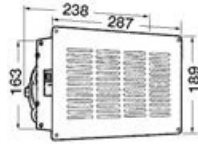
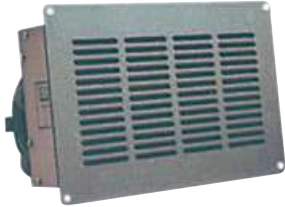

### HEATER CRAFT bulkhead heater

The kit includes a heater, a 4 position panel switch, electrical cable and screws. The system exploits the engine cooling water to convey heat to the cabin, 3-speed motor, simple and fast mounting.

Code	V	Consumption at 3 speeds	Calorific yield
50.263.00	12	3,9 - 5,0 - 7,7 A	28,000 BTU/hour with water volume 11 l/min at 76° and with ambient temperature 15°

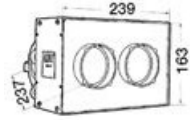

### HEATER CRAFT 2-outlet centralized heater

Mounting is possible where needed. Two 75-mm Ø hoses connect to two adjustable outlets for bulkhead mounting. Same technical features as model 50.263.00.

The kit includes a heater, a 4-position switch panel, mounting bracket, 3,6-m hose, 2 outlets, electrical cable and screws.

The system exploits the engine cooling water to convey heat to the cabin, 3-speed motor, simple and fast mounting.

Code	V	Consumption at 3 speeds	Calorific yield
50.263.01	12	3,9 - 5,0 - 7,7 A	28,000 BTU/hour with water volume 11 l/min at 76° and with ambient temperature 15°

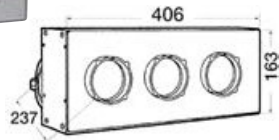

### HEATER CRAFT 3-outlet centralized heater

Upgraded model similar to 50.263.01. Three hoses connect to three adjustable outlets. The kit includes a heater, a 4-position switch panel, mounting bracket, 5,4-m 75-mm Ø hose, 3 adjustable outlets, electrical cable and screws. The system exploits the engine cooling water to convey heat to the cabin, 3-speed motor, simple and fast mounting.

Supply		Consumption at 3 speeds	Calorific yield
12 V	24 V		
50.263.02	50.263.03	4,4 - 5,8 - 8,4 A	40,000 BTU/hour with water volume 11 l/min at 76° and with ambient temperature 15°



▲50.263.11



▲50.263.08



▲50.263.06

### Extra accessories Heater Craft

Code	Description	Roll length m
50.263.06	"Y" joint for air canalisation (Ø mm 75)	-
50.263.11	Flexible pipe for air conduit Ø mm 75	12
50.263.08	Orientable selvagee for air outlet Ø mm 75 <b>black</b>	-

HEATER CRAFT



### 12V defroster/defogger unit

To be installed inside the control panel to defrost or defog the glass panes in wintertime.

Code	V	BTU/hr	No. of speed modes
50.264.12	12	1.706	1

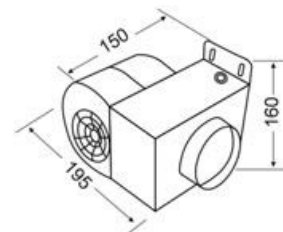

**New** AUTOTERM diesel-powered air heater

Autoterm air heaters are independent, diesel-powered heating systems that can be easily installed on your boat or vehicle.

They are excellent products for spaces which need to be heated or dehumidified quickly. Equipped with built-in fail-safe systems and sensors that will automatically shut down the heater if any errors occur.

Accessories included:

- Fuel pump cable with connector.
- Intake hose with silencer.
- Fuel dosing pump.
- 1.8-m control panel cable.
- 24-mm Ø thermal isolation.
- Silencer/muffler with mounting kit.
- 1-m exhaust pipe.
- 1.5-m nylon hose for fuel.
- Mounting bracket.

Code	Model	Recommended for boats (m)		V	Power kW	Heating capacity m <sup>3</sup> /h	↔  mm	kg
		Mediterranean climate	Northern climate					
50.252.12	AIR 2D	8-10	7-9	12	2	86	310x119x145	2.9
50.254.12	AIR 4D	10-12	8-10	12	4	168	402x157x188	5.5
50.254.24	AIR 4D	10-12	8-10	24	4	168	402x157x188	5.5

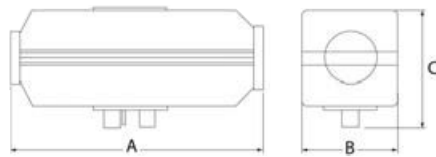

**New** Skin fittings

Skin fittings with 24-mm diameter intake hose. Made of AISI316 stainless steel.

Code	Type	Tube Ø mm	Material
50.255.01	Standard	24	SS 316
50.255.02	With bent	24	SS 316
50.255.03	Slanted	24	SS 316

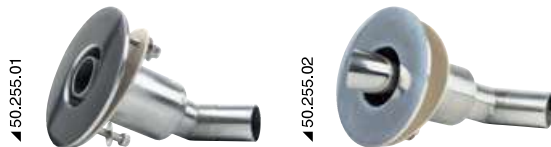

**New** AUTOTERM control panel for air heaters

Digital or analogic control panels are available depending on the requirements. The extension cord is compatible with both versions.

Max length of the compatible cable: 11.8 metres ( 5 m + 5 m + 1.8 m already included).

Code	Control panel	Language	OPTIONAL 5m-extension cable
50.251.11	Analogic	ALL	50.251.12
50.251.01	Digital	EN-DE-PL	50.251.12
50.251.02	Digital	EN-ES-IT	50.251.12
50.251.03	Digital	EN-FR-NL	50.251.12



**New** AUTOTERM installation and air distribution kit for air heaters

To install a heater, choose a air distribution kit depending on the type of burner chosen and the number of air vents you wish to install.

The kits include all the accessories needed for installation.

Code	Heater	Outlets	Open outlets	Adjustable and closable outlet	Connettors		↔  hose	
					Y-shaped	T-shaped	length m	Ø mm
50.252.62	AIR 2D	2	1	1	1	-	5	65
50.252.63	AIR 2D	3	1	2	1	-	8	65
50.254.63	AIR 4D	3	1	2	1	1	8	90
50.254.64	AIR 4D	4	1	3	2	1	10	90



# CLIMMA marine conditioners

## COMPACT direct expansion air conditioning systems



**Stainless steel** base and parts to ensure long duration and resistance. Supplied with **precharged monoblock** with ecological refrigerant, which does not require any specific tool for installation. Adjustable fan with horizontal or vertical air outlet. Also suitable as **air cooling systems or heaters**, 220V. Fitted with control display.

Technical features								
Code	Capacity Btu/h		Current draw			Nominal piping section	Air flow m <sup>3</sup>	Net weight kg
	cooler mode	heater mode	cooler mode	heater mode	start mode			
50.241.09	9,000	4,500 (electrical resistance)	3.4 A	5.6 A	21 A	100 mm/4"	260	26
50.241.12	12,000	4,500 (electrical resistance)	3.4 A	5.6 A	20 A	125 mm/5"	360	24
50.241.16	16,000	16,000 (cycle inversion)	5.5 A	6.6 A	34 A	150 mm/6"	900	40

System	Btu/h	Sea water accessory kit		Air first outlet accessory kit		Air second outlet accessory kit (addition to first outlet)	
		code (optional)	parts	code (optional)	parts	code (optional)	parts
50.241.09	9.000	50.241.50	120W sea water pump, 1/2" thru-hull scoop strainer, chromed 1/2" skin fitting, tap, 1/2" strainer.	50.241.20	Suction grid (244x244 mm), pipe (6 m, 100-mm Ø), 100-mm Ø fitting, plenum, delivery grid (202x100 mm)	50.241.25	3-way fitting (100x100x100 mm), 100-mm Ø sealable vent,
50.241.12	12.000	50.241.50	120W sea water pump, 1/2" thru-hull scoop strainer, chromed 1/2" skin fitting, tap, 1/2" strainer.	50.241.40	Suction grid (244x244 mm), pipe (6 m, 125-mm Ø), 125-mm Ø fitting, plenum, delivery grid (302x100 mm)	50.241.45	3-way fitting (125x125x100 mm), 100-mm Ø sealable vent, pipe (6 m, Ø 100 mm)
50.241.16	16.000	50.241.50	120W sea water pump, 1/2" thru-hull scoop strainer, chromed 1/2" skin fitting, tap, 1/2" strainer.	-	-	50.241.55	Suction grid (354x252 mm), pipe (6 m, 150-mm Ø), 3-way fitting (150x125x125 mm), pipe (6 m, 125-mm Ø), 2 x 125-mm Ø fittings, 2 plenum, 2 delivery grids (302x100 mm)



▲ 50.241.09

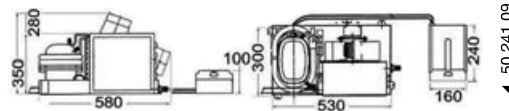

▲ 50.241.09



▲ 50.241.12

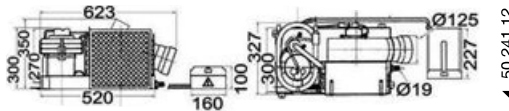

▲ 50.241.12



▲ 50.241.16

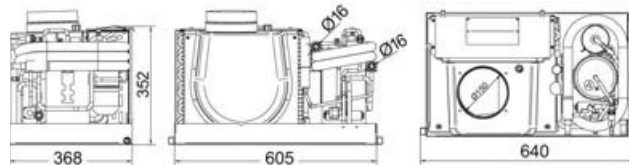

▲ 50.241.16



▲ 50.241.50 (drain plug, pump, filter, thru-hull plug, tap)



▲ 50.241.20/40 (suction, pipe, fitting, plenum, delivery)



▲ 50.241.55 (suction, 3-way fitting, pipe, fitting, plenum, delivery)



▲ 50.241.25/45 (3-way fitting, closing plug, pipe)



▲ 50.241.25 (3-way fitting, closing plug)

**Compact direct expansion air kit**



The smallest marine air conditioning system on the market. Ideal to condition the air of a small cabin. With a limited current draw, it can be installed on small vessels without a generator or a shore power connection (the installation of an optional 800W continuous min. inverter is needed). Fitted with a control display.

Technical characteristics

Code	Capacity Btu/h		Current draw			Nominal piping section	Air flow m <sup>3</sup> /h	Net weight kg
	cooler mode	heater mode	cooler mode	heater mode	start mode			
50.241.35	3.500	3.500 (cycle inversion)	2 A	2 A	5 A	100 mm/4"	230	12

Code	Btu/h	Sea water accessory kit	Air accessory kit
50.241.35	3.500	12V self-priming sea water pump, AC/12V DC power supply unit, 1/2" thru-hull scoop strainer, 1/2" chromed thru-hull scupper, tap, 1/2" strainer.	Intake grid (202x10 mm), piping (6 m, Ø 100 mm), 100-mm Ø fitting, plenum, delivery grid (202x100 mm)

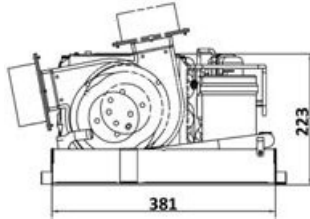
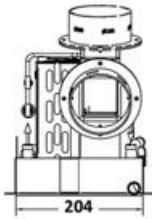

**SPLIT direct expansion air conditioning systems**



Ideal for the air conditioning of a single room or for nearby rooms, where space is a problem. In fact the system consists of two units, the compressor and the evaporator, that can be installed separately.

Technical features

Code	Capacity Btu/h		Current draw			Nominal piping section	Air flow m <sup>3</sup> /h	Net weight kg
	cooler mode	heater mode	cooler mode	heater mode	start mode			
50.241.08	8.000	8.000 (cycle inversion)	3.4 A	3.4 A	21 A	100 mm/4"	260	26

System	Btu/h	Sea water accessory kit		Air first outlet accessory kit		Air second outlet accessory kit (in addition to first outlet)	
		code	components	code	components	code	components
50.241.08	8.000	50.241.50	Salt water pump 120 W, 1/2" thru-hull scoop strainer, 1/2" chromed skin fitting, tap, 1/2" strainer	50.241.20	Intake grid (244x244 mm), piping (6 m, Ø 100 mm), 100-mm Ø fitting, plenum, delivery grid (202x100 mm)	50.241.25	3-way fitting (100x100x100 mm), 100-mm Ø port that can be closed

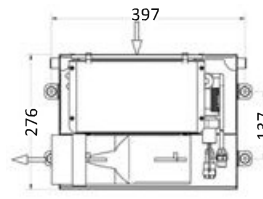
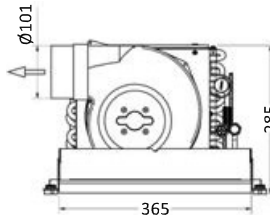
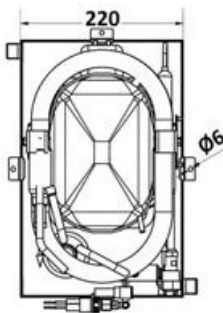
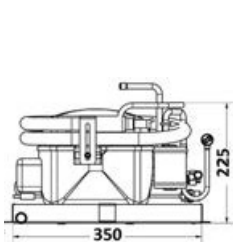

**New**

**Air conditioning pipes**

Flexible pipe made of additivated polyolefin film resins and spiral in a harmonic steel thread. Anti-vapour internal protection made of additivated polyolefin resin. Thermal-barrier coating in polyester fibre.

- colour: black
- working temperature: -20/+90°C (+110°C peak)
- bending radius: 0,8-1,5xø
- air speed: max 20m/sec
- pressure: approx. max 200mm
- reaction to fire Class 1 (Ministerial Decree 26/06/84).



Code	Length		Flow rate (m3/h)		roll package cm
	Ø mm	m	8m/s air speed	10m/s air speed	
50.265.10	102	10	250	333	23x23x78
50.265.12	127	10	383	368	23x23x78
50.265.15	152	10	575	773	23x23x78



## OSMOSEA watermakers (water purifiers)



### Water purifier, 12/24V

Purificator 300 LED is a very simple water treating system that delivers disinfected water, free from sediments, chlorine and smells. You will always have high quality water and will do without plastic bottles, that take place on board and pollute our seas.

The LED disinfecting lamp automatically switches on when opening the tap, needs no pre-heating, has a longer duration and the current draw is as little as 8.5W **during tapping, only**. Duration of the UV lamp: 10 years.



Code	Model	Flow l/min	In/Out Ø mm	Power	V
50.247.10	Purificator 300 LED	2.5	6	8.5	12/24



### OSMOSEA watermakers - water purifiers

Osmoboat is a reverse osmosis system for the direct production of osmotic water. Reverse osmosis is a water purification process that uses a partially permeable membrane to remove excess salts, bacteria, viruses, pesticides and heavy metal particles.

The water that enters the system undergoes a pre-filtering phase with pores 5 micron in size to eliminate suspended bodies, and then an active carbon filtering phase for the elimination of chlorine and bad odours. Osmoboat watermakers are lightweight and compact and comply with the Italian Ministerial Decree NO. 174 dated 6th April 2004.

Standard accessories: - Installation fittings. - Inlet, outlet and production hoses.  
- Anti-flooding probe. - One-way sink tap. - Inlet shut-off ball valve.



▲ 50.247.01

Code	Model	Type of water produced	Nominal output	←→  mm	kg
50.247.01	Osmoboat Slim	Room temp. natural water	80 l/h	420x457x108	10

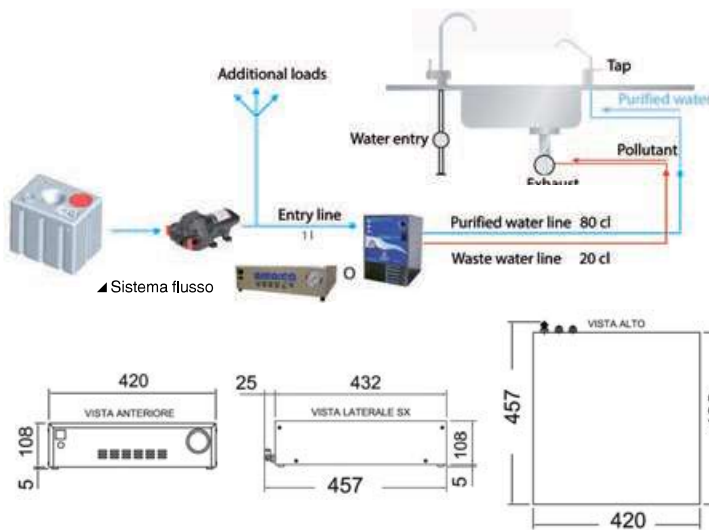

▲ Sistema flusso

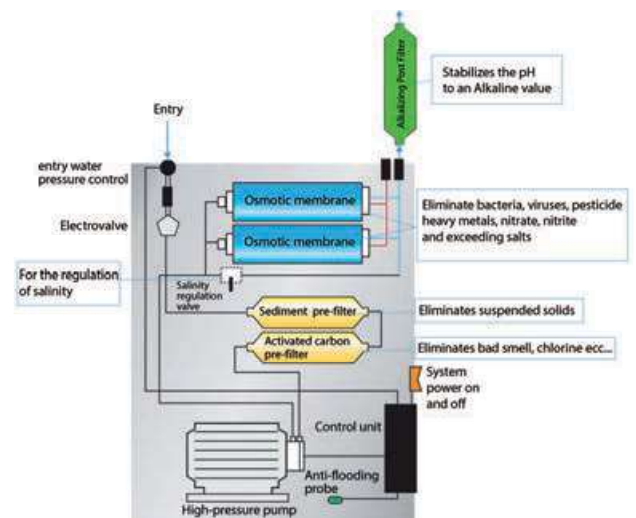

## Schenker watermakers

**Schenker**

Schenker is a leading manufacturer of watermakers.

- The ERS-Energy Recovery System allows for up to an 80% saving in current draw: 240 W are enough to produce 60 l/h.
- User-friendly, no pressure adjustment is needed since the ERS mechanically manages it.
- Silent and vibration-free, no high-pressure pump is required.



▲ 50.239.02

▲ 50.239.03

### SCHENKER ZEN water maker maintenance kit

Maintenance kit for SCHENKER ZEN water makers

Code	Description	It includes
50.239.02	Schenker Zen 30 water maker maintenance kit	3 x F5R filters 1 x ZCA (active carbon) filter 1 x CK (1 x SC1 and SC2 cleaning cycle)
50.239.03	Schenker Zen 50-100 water maker maintenance kit	3 x F5 filters 1 x CA (active carbon) filter 1 x CK (1 x SC1 and SC2 cleaning cycle)

**SCHENKER ZEN watermaker**

Lightweight and inexpensive, it is an ideal solutions for any boat since it is small and user-friendly (only 2 buttons).

**The kit includes:**

- Watermaker fitted with Energy Recovery System
- Feed pump with sea water filter
- Active carbon filter with electrovalve
- 5-micron net filter
- Fresh water hose (5 m)
- Remote panel.

**Remote panel functions:**

- Start/stop
- Production timer.
- Watermaker flushing
- Alarms.

Code	Model	V	Flow rate l/h	Current draw W	kg		Diaphragm
					Desalinator	Pump	
50.237.30	Zen 30	12	30	110	16	4.5	1x(2,5"x21")
50.237.50	Zen 50	12	50	240	21,5	8,5	2x(2,5"x21")
50.237.54	Zen 50	24	50	240	21,5	8,5	2x(2,5"x21")
50.237.92	Zen 100	12	100	400	41	12	1x(4"x21")
50.237.94	Zen 100	24	100	400	41	12	2x(4"x21")

Schenker

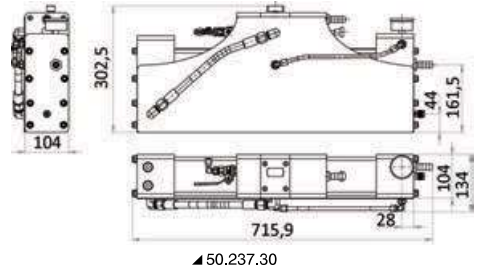
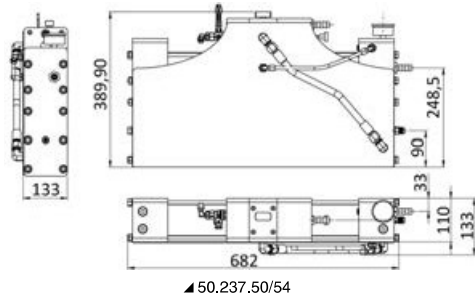

▲ Remote panel

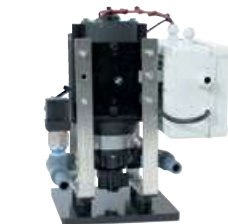
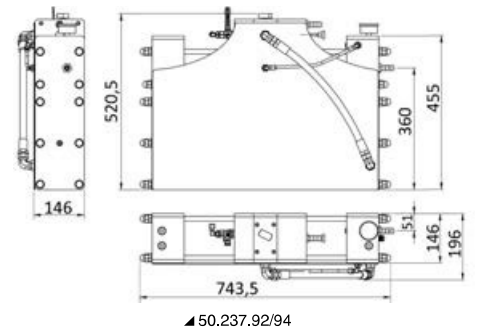
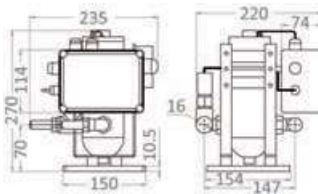

▲ Feed pump 50.237.30



▲ Feed pump 50.237.50/54



▲ Feed pump 50.237.92/94

**New SCHENKER WIKI 30 portable watermaker**

The ideal watermaker for those who won't or can't make installation works or who simply wish to have an additional backup watermaker on board.

Easy-to-use, lightweight, compact and sturdy, Wiki 30 can be operated in a matter of minutes using its quick couplings to connect the hoses (included in an additional bag).

Supplied in a handy and sturdy bag easy to stow in a peak, this watermaker is the perfect solution also for charter or regatta boats.

Code	Model	V	Flow rate l/h	Current draw W	kg	Diaphragm
					Desalinator	
50.240.10	Wiki 30	12	30	110	26	1 x (2,5" x 21")
50.240.20	Wiki 30	24	30	110	26	1 x (2,5" x 21")

Schenker



## MASE generators

### MASE generator, IS.7 line - 3000 rpm



**Engine:** easy access in case of maintenance of the power and lubrication systems, of the sea water pump and of the air filter. Safety stop in case of low oil pressure. Safety stop against overtemperature of engine and exhaust gas. Double vibration dumping system. Easy-to-replace oil and fuel filter. Oil drain pump provided.

**Alternator:** synchronous, 2 poles, self-adjusted, self-excited, brushless. Weatherproof epoxy-resin coated rotor and stator. Dynamically balanced rotor. H insulation class. Safety stop against coiling overtemperature.

**Soundproof cabinet:** self-bearing frame made of aluminium profiles and lightweight coated marine 5754 aluminium alloy panels featuring extremely high weatherproof properties. Very good access to the inside housing for easier maintenance operations even when the genset is installed in confined places.

**Cooling system:**

**Air/water:** the cooling system consists of an air/sea water exchanger. The air flows provide an efficient cooling and the optimal temperature for the best performance and reliability of the generator. This system ensures better operating conditions for the genset despite the room temperature of the onboard housing.

**Coolant/water:** the cooling of the engine is based on a coolant closed circuit controlled by a seawater/coolant heat exchanger.

Air inside the alternator is cooled by a seawater/air heat exchanger.

This system makes cooling of alternator more effective and achieve optimal temperature for best performance and reliability of the generating set despite the room temperature of the onboard housing.

**Control unit:** InteliNanoNT MRS 3 - (118x118mm) - IP65

Motor RPM	Alternator			Tube Ø mm	
	V	Hz	cooling	exhaust	
3000	115-230	50	16	40/45	

Code	Model	Motor			Alternator			Cooling system	↔  mm	kg	Noisiness at 7 m
		Make and model	No of cylinders	consumption l/h	A	Max power kW	meter power kW				
50.242.26	IS 2.6 (2 kW)	Yanmar L48N	1	0.7	17.4-8.7	2.0	1.7	Air/water	500x380x465	80	54 dB
50.242.35	IS 3.5 (3 kW)	Yanmar L70N	1	1.3	26.0-13.0	3.0	2.7	Air/water	590x406x515	96	54 dB
50.242.50	IS 5.0 (5 kW)	Yanmar L100N	1	1.65	43.5-21.7	5.0	4.2	Air/water	675x468x565	130	54 dB
50.242.61	IS 6.1 (6.1 kW)	Kubota Z482	2	2.6	53.0-26.5	6.1	5.6	Liquid/water	650x468x555	165	54 dB
50.242.91	IS 9.1 (8.6 kW)	Kubota D722	3	3.1	74.8-37.4	8.6	7.8	Liquid/water	730x468x555	185	54 dB

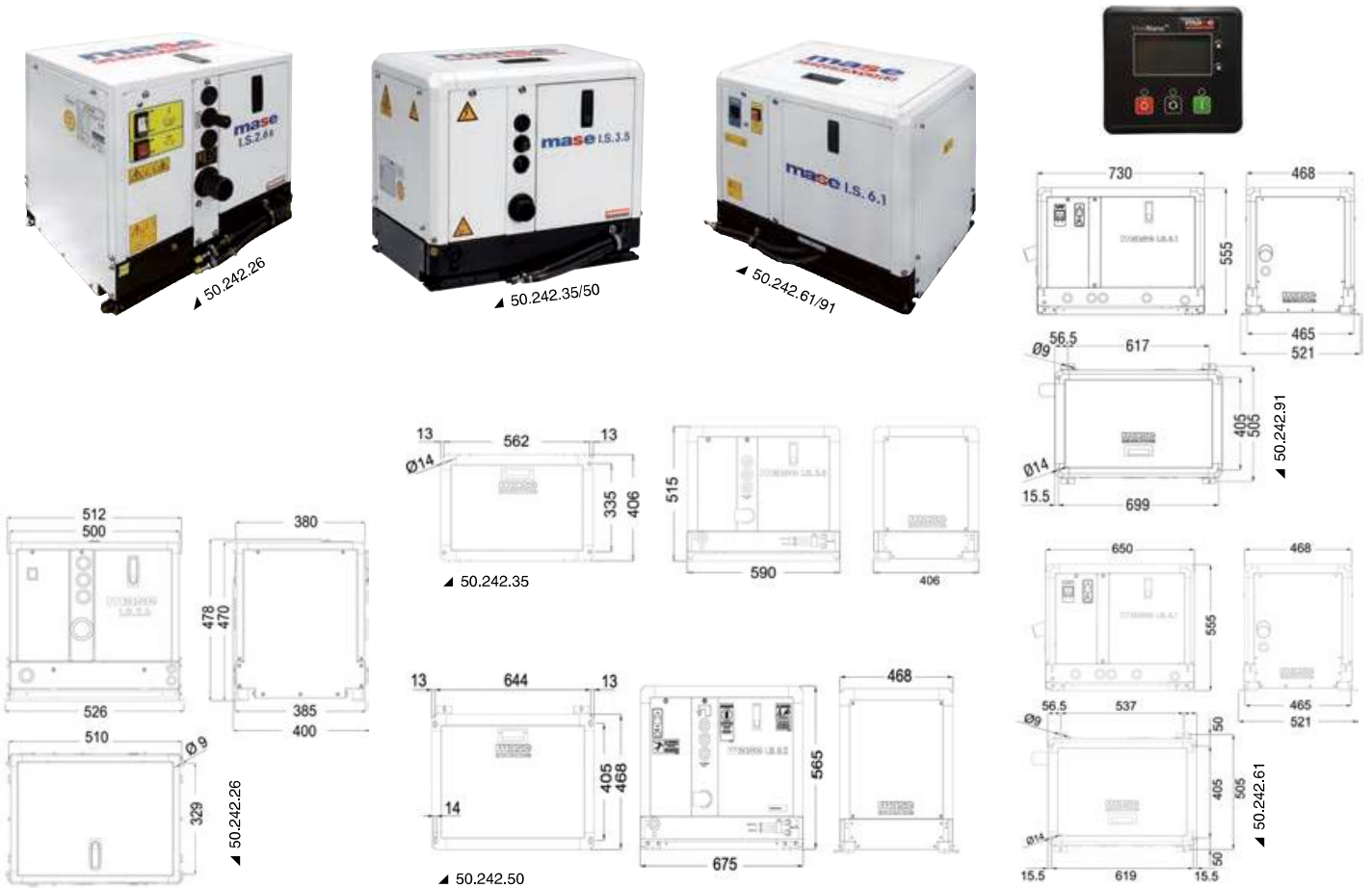

**MASE generators, VS.3 line - Variable RPM**



Last-generation variable RPM generators offering manufacturers and shipbuilders the advantages deriving from a small size and an adjustable power. The engine speed control system only generates the power required, which reduces emissions and consumption.

The W/A intercooler system ensures perfect functioning of the generator regardless of the external ambient temperature therefore the alternator and the engine work at ideal temperature optimizing the performance and reliability of the gen-set.

Engine: easy access in case of maintenance of the power and lubrication systems, of the sea water pump and of the air filter. Safety stop in case of low oil pressure. Safety stop against overtemperature of engine and exhaust gas. Easy-to-replace oil and fuel filter. Oil drain pump provided.

Alternator: permanent-magnet type.  
 Soundproof cabinet: frame made of lightweight coated marine aluminium panels featuring innovative design and extremely high weatherproof properties. Very good access to the inside housing for easier maintenance operations even when the genset is installed in confined places.

Cooling system: the cooling of the engine is based on a coolant closed circuit controlled by a seawater/coolant heat exchanger.  
 Air inside the alternator is cooled by a seawater/air heat exchanger.

This system makes cooling of alternator more effective and achieve optimal temperature for best performance and reliability of the generating set despite the room temperature of the onboard housing.

Control unit: InteliNanoNT MRS 3 - (118x118mm) - IP65.

Motor RPM	Alternator		Hose Ø mm	
	V	Hz	cooling	exhaust
2100 to 3150	230-240	50-60	16	40/45

Code	Model	Motor		Alternator		Cooling system	←→  mm	kg	Noise at 7 m
		Make and model	No. of cylinders	A	meter power k W				
50.243.06	VS 6,5	Kubota Z482	2	26,08	6	Air/water	650x469x555	161	54 dB
50.243.08	VS 8,5	Kubota Z602	2	34,7	8	Air/water	650x469x555	172	54 dB
50.243.10	VS 10,5	Kubota D722	3	40,6	10,5	Air/water	730x469x555	176	54 dB
50.243.12	VS 12,5	Kubota D902	3	52,1	12	Air/water	730x469x555	185	54 dB

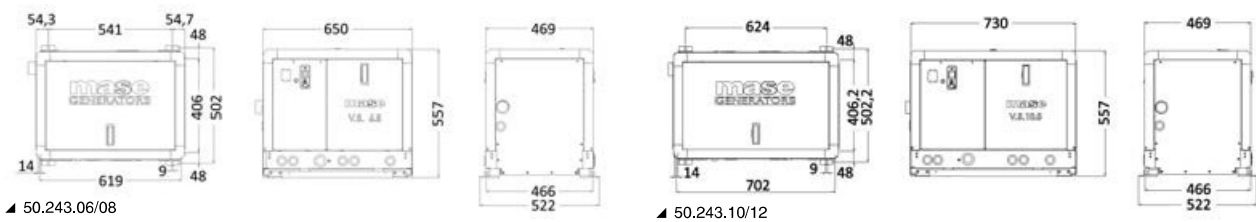

**Circuit cooling kit for generators**



50.244.90 It includes fittings, valves, filter and anti-siphon valve. Use a 16-mm Ø tube.

**Exhaust circuit kit for generators**



50.244.92 It includes silencer, exhaust valve and clamps. Use a 40-mm Ø tube.