



Fixed boat hooks

OSCULATI



Basic boat hook

Fitted with **anodized aluminium** pole and handle.

| | Length cm | | | Handle Ø mm |
|-----------|-----------|-----------|-----|-------------|
| | 130 | 160 | 210 | |
| 34.459.13 | 34.459.16 | 34.459.01 | 25 | |



OSCULATI



Premium boat hook

Very sturdy grip, **anodized aluminium** pole with rubber handle.

| Code | Length cm | Handle Ø mm | Spare hook |
|-----------|-----------|-------------|-------------|
| 34.171.50 | 220 | 30 | 34.171.40BI |



Boat hook

With **mirror-lacquered wooden** pole.

| Code | Hook material | Total length cm | Stick Ø mm | Spare hook |
|-----------|-----------------|-----------------|------------|------------|
| 34.459.11 | Chromed brass | 200 | 30 | 34.171.30 |
| 34.459.08 | Stainless steel | 200 | 30 | 34.171.35 |
| 34.459.12 | Chromed brass | 260 | 36 | 34.171.20 |
| 34.459.09 | Stainless steel | 260 | 36 | 34.171.25 |



Telescopic boat hooks

Telescopic boat hook

Grey nylon boat hook, anodized aluminium handle, double knob.



| Code | Min/max length cm | Pipes Ø mm |
|-----------|-------------------|------------|
| 34.458.90 | 120/212 | 25/30 |

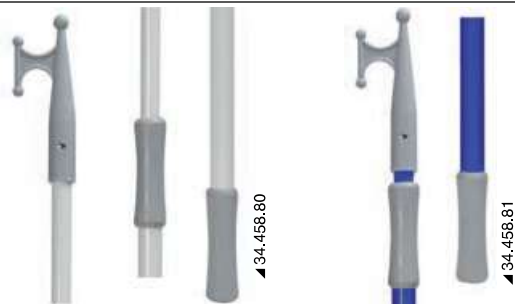

COLOR telescopic boat hook

Grey nylon hook, epoxy resin coated aluminium handle with double knob grip.

| Code | Colour | Min/max length cm | Pipe Ø mm |
|-----------|--------|-------------------|-----------|
| 34.458.80 | White | 120/210 | 25/30 |
| 34.458.81 | Blue | 120/210 | 25/30 |



Aluminium telescopic boat hook

White nylon hook, anodized aluminium pole and white polished rubber handle; very light, it floats, adjustable in all positions with its special cam.

| Code | Length min/max cm | Pipe Ø mm |
|------------|-------------------|-----------|
| 34.459.00 | 100/200 | 25/30 |
| 34.459.02* | 60/100 | 25/30 |

* Suitable for safety kits.



OSCULATI



TRI-TELESCOPIC boat hook

Made of mirror polished anodized aluminium, with nylon hook and handle; very sturdy, made with 3 sturdy concentric tubes; can be adjusted in any position with its cam.

| Code | Length min/max cm | Pipe Ø mm |
|-----------|-------------------|-----------|
| 34.460.00 | 115/285 | 25/30/35 |



OSCULATI



Professional telescopic boat hook

Made of anodized aluminium, natural finish (includes hook). Its rotation locking device enables fast locking at any point, very sturdy.

| Code | Version | Length min/max cm | Tube Ø mm |
|-----------|--------------------------|-------------------|-----------|
| 34.915.41 | Bi-telescopic (2 tubes) | 120/209 | 25/29 |
| 34.915.42 | Tri-telescopic (3 tubes) | 105/245 | 25/29/32 |

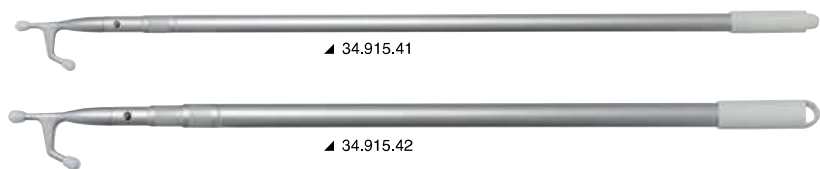

OSCULATI



Professional telescopic boat hook with roller

Made of anodized aluminium, includes hook.

| Code | Model | Length min/max cm | Shaft section Ø mm |
|-----------|----------------|-------------------|--------------------|
| 34.916.41 | Bi-telescopic | 120/209 | 25/29 |
| 34.916.42 | Tri-telescopic | 105/245 | 25/29/32 |



OSCULATI



Professional boat hook with rubber head

Made of natural anodized aluminium with anti-skid bi-component technolpolymer hook. Quick lock in all positions via rotation.

| Code | Version | A min-max cm | L min-max cm | Pole Ø mm |
|-----------|--------------------------|--------------|--------------|-----------|
| 34.917.42 | tri-telescopic (3 poles) | 94-244 | 110-260 | 25/29/32 |
| 34.917.43 | tri-telescopic (3 poles) | 134-366 | 150-382 | 25/29/32 |



Boat hooks

Black polypropylene boat hook



Very sturdy grip.

| white | black | Hole Ø mm |
|-------------|-------------|-----------|
| 34.171.40BI | 34.171.40NE | 30 |

Boat hooks in chromed brass



| Code | Ø Hole mm | For wooden rods mm |
|-----------|-----------|--------------------|
| 34.171.20 | 32 | 35 |
| 34.171.30 | 27 | 30 |

Stainless steel AISI 316 boat hooks

AISI 316



| Code | Hole mm | For wooden rods mm |
|-----------|---------|--------------------|
| 34.171.25 | 34 | 35/36 |
| 34.171.35 | 28 | 30 |

OSCULATI



Telescopic boat hook for buoy mooring

This boat hook also allows the operator to hook the eye of the buoy and retrieve the mooring line with a single movement.

Technical specification:

- Boat hook made of a special high-strength technopolymer;
- Anodized light alloy stick;
- Telescopic (105/245 cm).

| Code | Min/max length cm | Tube Ø mm |
|-----------|-------------------|-----------|
| 34.916.43 | 110/250 | 25/29/32 |

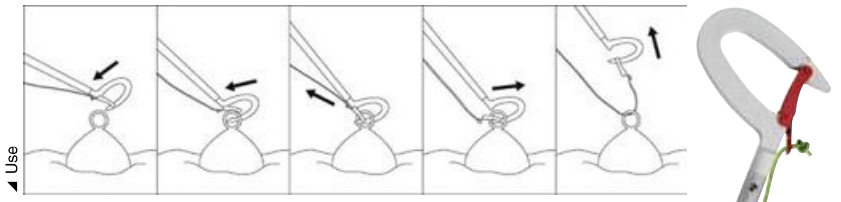

Oars and paddles



ABS paddles

34.459.30 Meets safety regulations required for boats that navigate 1 mile from the coast; specially designed for surf-boards; can be stacked; clip-on mounting with 3 special pins.



Mini telescopic emergency paddle

Paddle and handle made of bright orange plastic to be easily visible, anodized aluminium pole. Especially suited for life rafts and small tenders

| Code | Pole Ø mm | cm |
|-----------|-----------|------------|
| 34.459.18 | 22-25 | 53.5 x 106 |

Telescopic mini paddle

Paddle and handle made of black plastic, anodized aluminium pole. Epoxy-resin coated.



| Code | Min/max length cm | Pole Ø mm |
|-----------|-------------------|-----------|
| 34.459.19 | 70/118 | 29-25 |



OSCULATI

Telescopic paddle

White ABS blades, white nylon boat hook, anodized aluminium handle. Practical and very sturdy.



| Code | Handle Ø mm | Length min/max cm |
|-----------|-------------|-------------------|
| 34.459.20 | 30 | 90/160 |



Paddles with white ABS blade and nylon boat hook handle

Aluminium pole, very functional and sturdy.

| Code | Length cm | Handle Ø mm |
|-----------|-----------|-------------|
| 34.459.24 | 130 | 30 |
| 34.459.25 | 160 | 30 |



OSCOLATI



Demountable telescopic oar with boat hook

Impact-resistant plastic blade, silver anodized aluminium pole.

| Code | Length cm | | Ø mm |
|-----------|-----------|-----|-------|
| | min | max | |
| 34.452.20 | 80 | 180 | 30/35 |



Anodized aluminium demountable oars

Fitted with white plastic blade. Version with two similar slugs when disassembled.

| Code | Length cm | | | Ø mm |
|-----------|-----------|------|--------|------|
| | tot | ball | handle | |
| 34.453.13 | 132 | 67 | 75 | 35 |
| 34.453.16 | 160 | 92 | 75 | 35 |
| 34.453.19 | 180 | 102 | 85 | 35 |

Anodized aluminium oars

Fitted with white plastic blade, pole and handle.

| Code | Length cm | Ø mm |
|-----------|-----------|------|
| 34.454.01 | 190 | 35 |
| 34.454.02 | 160 | 35 |



OSCOLATI



OSCOLATI



Assembling oars, suitable for inflatable boats

Impact-resistant grey plastic blade, aluminium anodized silver pole.

| Code | Length cm | | | Ø mm |
|-----------|-----------|-------|--------|------|
| | tot | blade | handle | |
| 34.452.13 | 132 | 55 | 85 | 35 |
| 34.452.15 | 147 | 55 | 100 | 35 |
| 34.452.17 | 167 | 55 | 120 | 35 |

Twin canoe jointed paddles

34.470.03 Can be used as two single paddles 150 cm (A) each or 220 cm (B) long if used as a double kayak paddle.

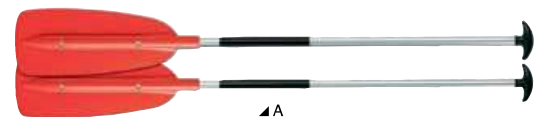
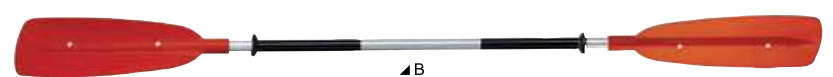

Canoe/kayak paddles

Made of anodized aluminium with ABS blades.

| Code | Type | Length cm | Handle Ø mm |
|-----------|----------------------|-----------|-------------|
| 34.470.01 | simple | 150 | 30 |
| 34.470.02 | double, blade at 90° | 210 | 30 |





Professional kayak paddle

Fitted with oval anodized aluminium pole, perfect grip.

| Code | Version | Length cm | Pipe Ø mm |
|-----------|---------|-----------|-----------|
| 34.471.02 | double | 210 | 32 |



Aluminium paddle for SUP

Lever-adjustable length, double locking system for increased stability, made up of 3 detachable parts for easier stowage. Remove the central part to assemble a paddle for children.

| Code | Length cm | Ø mm | g |
|-----------|-----------|------|------|
| 34.474.00 | 175/215 | 29 | 1160 |



Laminated wood paddles

Mirror lacquered polyurethane coating, with rubber handle.

| Code | Length cm |
|-----------|-----------|
| 34.447.00 | 141 |
| 34.447.02 | 157 |



Evaporated beech jointed oars

Very sturdy, lacquered with polyurethane, they can be taken apart at the stainless steel joint.

| Code | Length m | Ø mm |
|-----------|----------|------|
| 34.456.25 | 2,5 | 46 |
| 34.456.30 | 3 | 46 |



Wooden paddles

Glass lacquered polyurethane; very sturdy, fitted with plastic collar; fine finish.

| Code | Version | Length m | Handle Ø mm |
|-----------|----------------------------|----------|-------------|
| 34.458.22 | Fir with curved blade* | 2,2 | 46 |
| 34.458.25 | Fir with curved blade* | 2,5 | 46 |
| 34.455.20 | Steamed beech | 2 | 46 |
| 34.455.22 | Steamed beech | 2,2 | 46 |
| 34.455.25 | Steamed beech | 2,5 | 46 |
| 34.455.30 | Steamed beech | 3 | 46 |
| 34.446.18 | Mahogany with curved blade | 1,8 | 36 |
| 34.446.20 | Mahogany with curved blade | 2 | 36 |
| 34.446.22 | Mahogany with curved blade | 2,2 | 36 |
| 34.446.24 | Mahogany with curved blade | 2,45 | 36 |

* It's a true oarsman's paddle



Hooks and clips for oar-holders and general purpose applications

Plastic circlips

Clips for holding oars or handles, heavy version.

| Ø mm | white | black |  ORDER BY BOX |
|------|-----------|-----------|--|
| 20 | 34.354.03 | 34.355.03 | 10 |
| 25 | 34.354.04 | 34.355.04 | 10 |
| 30 | 34.354.05 | 34.355.05 | 10 |
| 35 | 34.354.00 | 34.355.00 | 10 |
| 40 | 34.354.01 | 34.355.01 | 10 |
| 45 | 34.354.02 | 34.355.02 | 10 |



Nylon circlip

To be mounted with 2 screws.

| Ø mm | white | black |  ORDER BY BOX |
|-------|-----------|-----------|--|
| 17/23 | 34.354.25 | 34.355.25 | 10 |
| 22/28 | 34.354.28 | 34.355.28 | 10 |
| 27/35 | 34.354.34 | 34.355.34 | 10 |
| 34/45 | 34.354.44 | 34.355.44 | 10 |



Spring clips, suitable for holding poles, oars, boat awnings, boat hooks, fishing rods, etc

Made of UV stabilized black Santoprene, sturdy and very elastic.

| Ø mm | Black | White |  ORDER BY BOX |
|--------|-----------|-----------|--|
| 16/18 | 34.358.16 | 34.358.17 | 10 |
| 19/20 | 34.358.19 | 34.358.18 | 10 |
| 22/24 | 34.358.22 | 34.358.23 | 10 |
| 25/26 | 34.358.25 | 34.358.26 | 10 |
| 28/30 | 34.358.28 | 34.358.29 | 10 |
| 37/40 | 34.358.38 | 34.358.39 | 10 |
| 60/65* | 34.358.60 | - | 2 |



* Designed for table leg fastening.

TRUDESIGN clips

TruDesign clips include a standard size **base** that can either be **screwed** or **glued**. The clip snaps into the base; pinch its arms together to unclip and detach it from the base. The base has a slot for straps for tying down cables and wires. Base made of composite glassreinforced Nylon, clips made of Acetal copolymer (POM) resin.

| Ø mm | Black | Description |  ORDER BY BOX |
|-------|-----------|-------------|--|
| 13/16 | 34.360.13 | Clip | 5 |
| 20/27 | 34.360.20 | Clip | 5 |
| 28/37 | 34.360.28 | Clip | 5 |
| 38/50 | 34.360.38 | Clip | 5 |
| - | 34.360.00 | Fixing base | 10 |

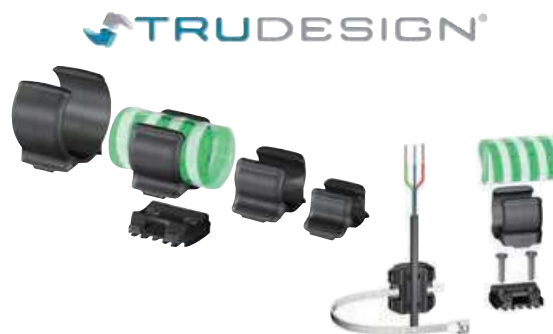

Stainless steel circlip

To lock boat hooks, fishing-rods, etc.. Spring adjustable Ø.

| Code | For pipe Ø mm |
|-----------|---------------|
| 34.357.00 | 30/35 |

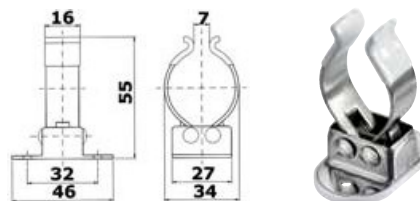

Mirror polished stainless steel holding hooks for boat hooks



34.212.30 Suitable for holding any type of boat hooks with Ø from 22mm to 32mm; sold in **pairs**.

Stainless steel spring clips, suitable for holding boat hooks, fishing poles, etc.



34.356.00 Fits 25/32 mm poles, sold in **pairs**.



Spring clips for fixing boat hooks

Stainless steel + nylon

| Code | Universal for Ø mm | Kit |
|-----------|--------------------|-------|
| 34.359.00 | 25/35 | 2 pcs |

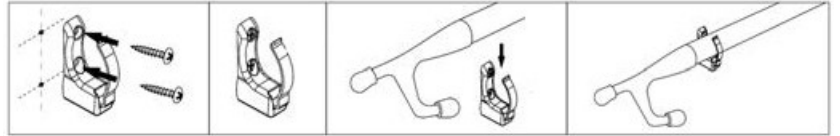

Folding Storage bracket for boat hooks/fishing rods

Made of electro-polished S.S., with foldable nylon support

| Code | Base mm | For boat hooks Ø mm |
|-----------|---------|---------------------|
| 34.357.20 | 55x71 | 32/35 |

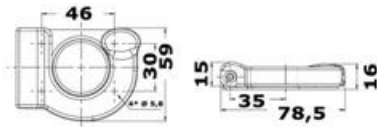

Multipurpose fixing clip

It can be fixed to a bulkhead by a screw, or snap-hooked to the pulpit (for pipes Ø 22/28 mm). It can be used to hang clothes to dry, ropes, electric cables and any other object. Made of white nylon + stainless steel spring.



| Code | ORDER BY BOX |
|-----------|--------------|
| 34.358.00 | 4 |

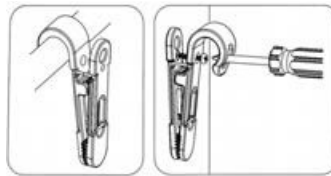

Super clothes pegs

Made of plastic, their ingenious safety system avoid the peg from opening even in the most difficult situation. Stainless steel internal spring.

| Code | Color | mm | ORDER BY BOX |
|-----------|-------|--------|--------------|
| 34.358.20 | white | 100x33 | 8 |

Sockets and rowlocks



Plastic Collars for oars

| Code | inner Ø mm |
|-----------|------------|
| 34.565.01 | 34/35 |
| 34.565.02 | 38/39 |
| 34.565.03 | 43/44 |
| 34.565.04 | 53/54 |



JARNFORDLINGS Delrin rowlocks

Snap-on fitting.

| Code | A mm | B mm | Nylon bushing | |
|-----------|------|------|-----------------------------|-------------------------------|
| | | | for recess mount - OPTIONAL | for bulkhead mount - OPTIONAL |
| 34.435.01 | 38 | 45 | 34.435.03 | 34.435.04 |
| 34.435.02 | 42 | 56 | 34.435.03 | 34.435.04 |



Sockets for nylon rowlocks

| Flush mount | Wall mount | For rowlocks |
|-------------|------------|--------------|
| 34.435.03 | 34.435.04 | 34.435.01-02 |

Black nylon rowlock



Floating, type "Rio 3,10/4,10"; includes bayonet socket.

| Code | For legs Ø mm | A mm | B mm |
|-----------|---------------|------|------|
| 34.437.00 | 12 | 32 | 46 |

Nylon rowlocks



Very sturdy and light, white colour.

| Code | Stem Ø mm | A mm | B mm |
|-----------|-----------|------|------|
| 34.432.00 | 15 | 34 | 53 |

Rowlock for paddle boats

Made of chromed brass.

| Code | Description | Fork Ø mm | Stem Ø mm |
|-----------|-------------|-----------|-----------|
| 34.170.14 | rowlock | 64 | 15 |



Chromed brass rowlock, suitable for small fishing boats

Includes bushing with 2 holes 34.430.13.

| Code | Total length mm | Pin mm |
|-----------|-----------------|--------|
| 34.150.01 | 150 | 12 |



Chromed brass rowlocks

Just the rowlock.

| Code | Ø stem mm | ←→ mm | | | Bushing OPTIONAL |
|-----------|-----------|--------|----|----|---------------------------------|
| | | A | B | C | |
| 34.430.00 | 12 | 38 | 48 | 68 | 34.170.16; 34.430.13 |
| 34.170.11 | 12 | 41 | 53 | 72 | 34.170.16; 34.430.13 |
| 34.170.12 | 14 | 41 | 59 | 72 | 34.170.17; 34.430.14; 34.430.15 |
| 34.193.00 | 14 | 51 | 68 | 98 | 34.170.17; 34.430.14; 34.430.15 |

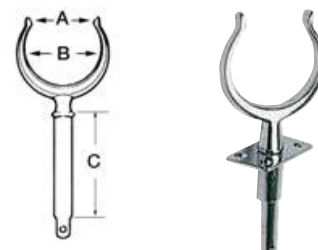

Side Socket for chromed brass rowlocks

| Code | Hole mm | ←→ mm | For rowlocks |
|-----------|---------|----------|----------------------|
| 34.170.16 | 12 | 50x38x21 | 34.430.00; 34.170.11 |
| 34.170.17 | 14 | 50x38x21 | 34.170.12; 34.190.00 |



Socket for chromed brass rowlocks

| Code | Hole | ←→ mm | For rowlocks |
|-----------|------|--------|---------------------------------|
| 34.430.13 | 2 | 60x23 | 34.430.00; 34.170.11; 34.150.01 |
| 34.430.14 | 4 | 60x35 | 34.170.12; 34.193.00 |
| 34.430.15 | 2 | 80x30 | 34.170.12; 34.193.00 |



Chromed brass rowlock with blind socket



Includes **blind** socket, specially suited for plastic boats with interspace; the rowlock has a bayonet fitting; this product is a perfect alternative to most plastic rowlocks that break easily; the socket has a wide area for covering any pre-existing plastic socket holes.

| Code | Stem Ø mm | A mm | B mm |
|-----------|-----------|------|------|
| 34.160.10 | 12 | 40 | 52 |
| 34.160.11 | 12 | 45 | 58 |

Special chromed brass rowlock



Foldable inner stringer, suitable for all types of boats, convenient, trouble-proof.

| Code | Stem Ø mm | A mm | B mm |
|-----------|-----------|------|------|
| 34.433.00 | 12 | 42 | 50 |

Chromed brass rowlocks for inflatable tender

For inflatable's removable oars for rubber row boat



| Code | Pin length mm | Type of dinghy |
|-----------|---------------|--|
| 34.430.10 | 35 | Zodiac |
| 34.430.12 | 23 | Lomac, Bat, Radial, Nova, Reeves, Axemar, Asso and Nuova Jolly |

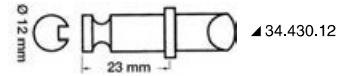
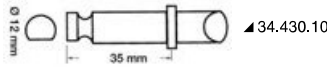

Plastic rowlocks for inflatable tenders

Fitted with **brass** snap-on pin for paddle Ø35 mm.

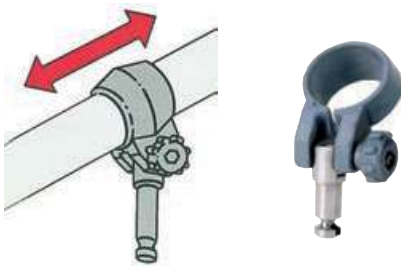

| Code | Ø mm | Length mm |
|-----------|------|-----------|
| 34.430.06 | 12 | 35 |
| 34.430.08 | 12,5 | 26,5 |
| 34.430.09 | 12 | 23 |

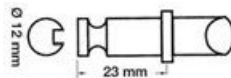

▲ 34.430.09

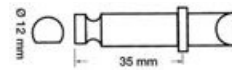

▲ 34.430.06

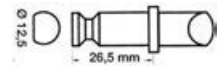

▲ 34.430.08